



ULTIMATE

TRULY SEAMLESS DOUBLE BUTTED TUBES

HEAT-TREATED EXTRALIGHT

D.B.T
Double Butted Tube

Top Tube
Down Tube

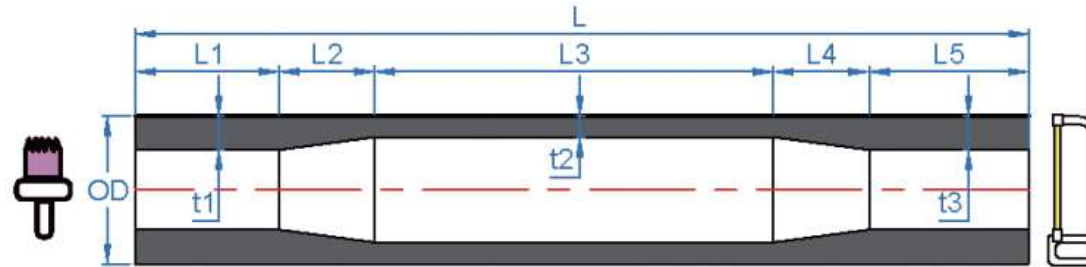

Recommend part	TANGE code	Barcode	Butted	OD	Thickness t1 - t2 - t3	Butted Distribution L1 - L2 - L3 - L4 - L5	Length (mm)	Weight (g)	Heat Treatment	Finish
Top Tube	TUL254-25-600	4712883580017	Double Butted Tube	25.4	0.65-0.35-0.65	80-50-250-50-170	600	193	YES	Polished #400
Top Tube	TUL254-29-600	4712883580024	Double Butted Tube	25.4	0.65-0.35-0.65	80-50-290-50-130	600	186	YES	Polished #400
Top / Down Tube	TUL286-25-650	4712883580031	Double Butted Tube	28.6	0.65-0.35-0.65	80-50-250-50-220	650	240	YES	Polished #400
Top / Down Tube	TUL286-30-650	4712883580048	Double Butted Tube	28.6	0.65-0.35-0.65	80-50-300-50-170	650	230	YES	Polished #400
Down Tube	TUL318-30-650	4712883580055	Double Butted Tube	31.8	0.65-0.35-0.65	80-50-300-50-170	650	257	YES	Polished #400
Down Tube	TUL318-35-650	4712883581588	Double Butted Tube	31.8	0.65-0.35-0.65	80-50-350-50-120	650	245	YES	Polished #400

S.B.T
Single Butted Tube

Seat Tube
For 27.2mm Post

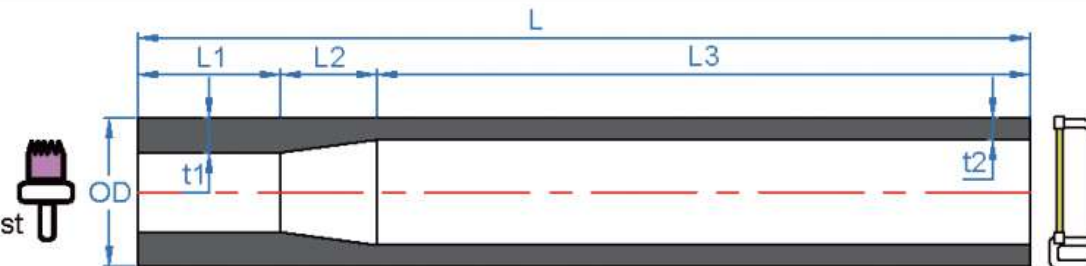

Recommend part	TANGE code	Barcode	Butted	OD	Thickness t1 - t2	Butted Distribution L1 - L2 - L3	Length (mm)	Weight (g)	Heat Treatment	Finish
Seat Tube	TPR286-95-600	4712883580062	Single Butted Tube	28.6	0.9-0.6	90-50-460	600	277	YES	Polished #400

S.B.T
Single Butted Tube

Seat Stay
Chain Stay
Fork Blade

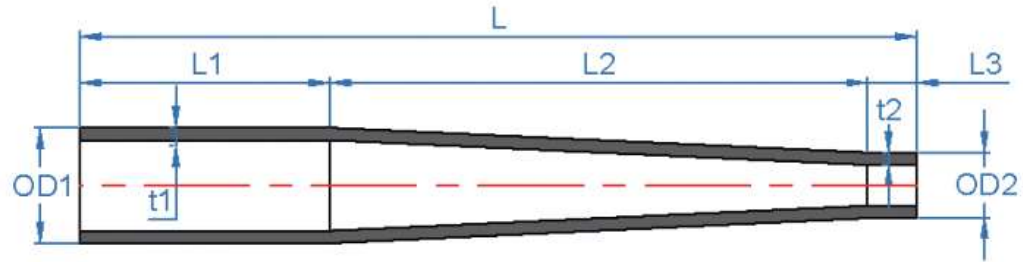

Recommend part	TANGE code	Barcode	Butted	OD1 / OD2	Thickness t1 - t2	Butted Distribution L1 - L2 - L3	Length (mm)	Weight (g)	Heat Treatment	Finish
Seat Stay	TUL14-125-5ET-600	4712883580079	Single Butted Tube	14 / 12.5	0.5 Even-thick	370-215-15	600	97	NO	Polished #400
Seat Stay	TUL16-125-5ET-600	4712883580086	Single Butted Tube	16 / 12.5	0.5 Even-thick	320-265-15	600	110	NO	Polished #400
Chain Stay	TUL222-125-6ET-450	4712883580093	Single Butted Tube	22.2 / 12.5	0.6 Even-thick	170-265-15	450	130	NO	Polished #400
Chain Stay	TUL222-125-6ET-450V	4712883580109	Single Butted Tube	22.2 (OVAL 27/17) / 12.5	0.8 Even-thick	170-265-15	450	130	NO	Polished #400
Chain Stay	TUL24-125-6ET-450V	4712883580116	Single Butted Tube	24 (OVAL 30/17) / 12.5	0.6 Even-thick	170-265-15	450	140	NO	Polished #400
Fork Blade	TUL24-125-9ET-420	4712883580123	Single Butted Tube	24 / 12.5	0.9 Even-thick	170-235-15	420	185	NO	Polished #400
Fork Blade	TUL24-125-9ET-420V	4712883580130	Single Butted Tube	24 (OVAL 28/20) / 12.5	0.9 Even-thick	170-235-15	420	185	NO	Polished #400



ULTIMATE KEIRIN

TRULY SEAMLESS DOUBLE BUTTED TUBES, AVAILABLE FOR NJS SPEC
HEAT-TREATED EXTRALIGHT

D.B.T
Double Butted Tube

Top Tube
Down Tube

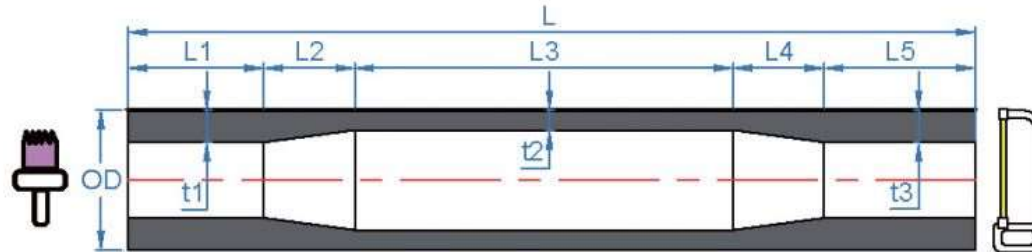

Recommend part	TANGE code	Barcode	Butted	OD	Thickness t1 - t2 - t3	Butted Distribution L1 - L2 - L3 - L4 - L5	Length (mm)	Weight (g)	Heat Treatment	Finish
Top Tube	TUK254-25-600	4712883580147	Double Butted Tube	25.4	0.65-0.5-0.65	80-50-250-50-170	600	224	YES	Polished #400
Top Tube	TUK254-34-600	4712883581410	Double Butted Tube	25.4	0.65-0.5-0.65	80-50-340-50-80	600	220	YES	Polished #400
Top / Down Tube	TUK286-25-650	4712883580154	Double Butted Tube	28.6	0.65-0.5-0.65	80-50-250-50-220	650	274	YES	Polished #400
Top / Down Tube	TUK286-34-650	4712883581427	Double Butted Tube	28.6	0.65-0.5-0.65	80-50-340-50-130	650	270	YES	Polished #400
Down Tube	TUK318-30-650	4712883580161	Double Butted Tube	31.8	0.65-0.5-0.65	80-50-300-50-170	650	302	YES	Polished #400
Down Tube	TUK318-34-650	4712883581437	Double Butted Tube	31.8	0.65-0.5-0.65	80-50-340-50-130	650	300	YES	Polished #400

S.B.T
Single Butted Tube

Seat Tube
For 27.2mm Post

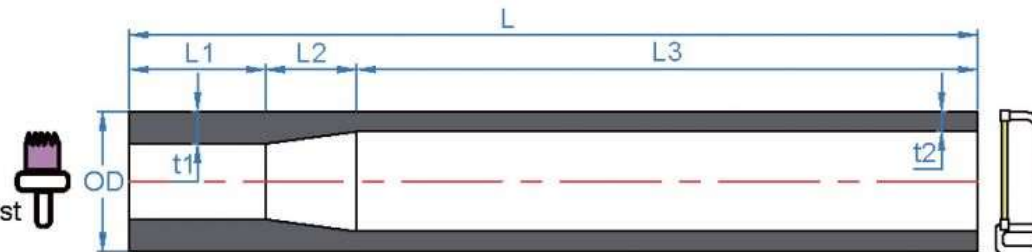

Recommend part	TANGE code	Barcode	Butted	OD	Thickness t1 - t2	Butted Distribution L1 - L2 - L3	Length (mm)	Weight (g)	Heat Treatment	Finish
Seat Tube	TPR286-95-600	4712883580062	Single Butted Tube	28.6	0.9-0.6	90-50-460	600	277	YES	Polished #400

S.B.T
Single Butted Tube

Seat Stay
Chain Stay
Fork Blade

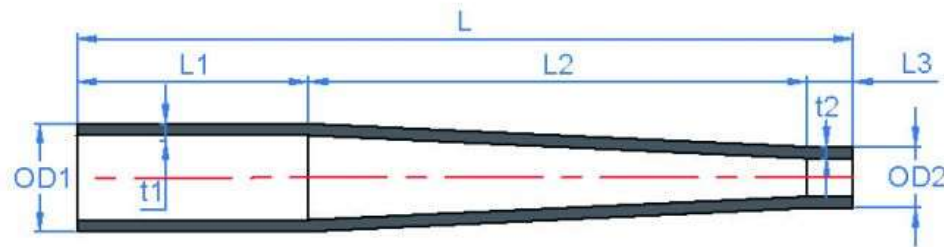

Recommend part	TANGE code	Barcode	Butted	OD1 / OD2	Thickness t1 - t2	Butted Distribution L1 - L2 - L3	Length (mm)	Weight (g)	Heat Treatment	Finish
Seat Stay	TUK14-125-6ET-600	4712883580178	Single Butted Tube	14 / 12.5	0.6 Even-thick	375-215-15	600	117	NO	Polished #400
Seat Stay	TUK16-125-6ET-600	4712883580185	Single Butted Tube	16 / 12.5	0.6 Even-thick	320-265-15	600	130	NO	Polished #400
Seat Stay	TUK14-11-6PG-600	4712883581595	Single Butted Tube	14 / 11.0	0.6 PG	300-285-15	600	119	NO	Polished #400
Seat Stay	TUK16-11-6PG-600	4712883581601	Single Butted Tube	16 / 11.0	0.6 PG	300-285-15	600	137	NO	Polished #400
Chain Stay	TUK222-125-7ET-450	4712883580192	Single Butted Tube	22.2 / 12.5	0.7 Even-thick	170-265-15	450	143	NO	Polished #400
Chain Stay	TUK222-125-7ET-450V	4712883580208	Single Butted Tube	22.2 (OVAL 27/17) / 12.5	0.7 Even-thick	170-265-15	450	143	NO	Polished #400
Chain Stay	TUK24-125-7ET-450V	4712883580215	Single Butted Tube	24 (OVAL 30/17) / 12.5	0.7 Even-thick	170-265-15	450	152	NO	Polished #400
Fork Blade	TUL24-125-9ET-420	4712883580123	Single Butted Tube	24 / 12.5	0.9 Even-thick	170-235-15	420	185	NO	Polished #400
Fork Blade	TUL24-125-9ET-420V	4712883580130	Single Butted Tube	24 (OVAL 28/20) / 12.5	0.9 Even-thick	170-235-15	420	185	NO	Polished #400



PRESTIGE JAPAN

TRULY SEAMLESS DOUBLE BUTTED TUBES,
HEAT-TREATED LIGHT

D.B.T
Double Butted Tube

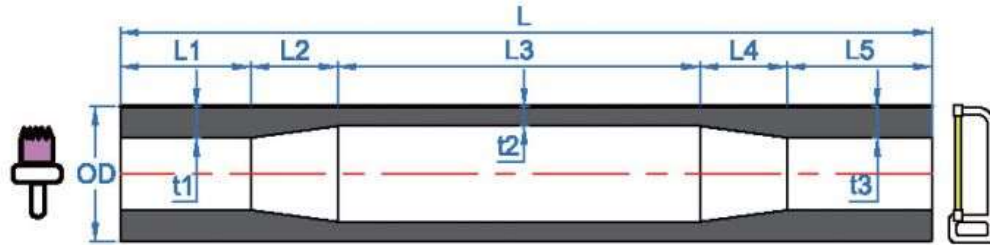

Recommend part	TANGE code	Barcode	Butted	OD	Thickness t1 - t2 - t3	Butted Distribution L1 - L2 - L3 - L4 - L5	Length (mm)	Weight (g)	Heat Treatment	Finish
Top Tube	TPJ254-24-600	4712883580222	Double Butted Tube	25.4	0.7-0.4-0.7	80-50-240-50-180	600	213	YES	Polished #400
Top Tube	TPJ254-29-600	4712883580239	Double Butted Tube	25.4	0.7-0.4-0.7	80-50-290-50-130	800	205	YES	Polished #400
Top Tube	TPJ286-24-600	4712883580246	Double Butted Tube	28.6	0.7-0.4-0.7	80-50-240-50-180	800	240	YES	Polished #400
Top / Down Tube	TPJ286-29-650	4712883580253	Double Butted Tube	28.6	0.7-0.4-0.7	80-50-290-50-180	650	254	YES	Polished #400
Down Tube	TPJ286-34-650	4712883580260	Double Butted Tube	28.6	0.7-0.4-0.7	80-50-340-50-130	850	244	YES	Polished #400
Down Tube	TPJ318-28-650	4712883580277	Double Butted Tube	31.8	0.7-0.4-0.7	80-50-280-50-190	650	286	YES	Polished #400
Down Tube	TPJ318-33-650	4712883580284	Double Butted Tube	31.8	0.7-0.4-0.7	80-50-330-50-140	650	274	YES	Polished #400
Down Tube	TPJ349-33-850	4712883580291	Double Butted Tube	34.9	0.7-0.5-0.7	80-50-330-50-140	850	301	YES	Polished #400

D.B.T
Double Butted Tube

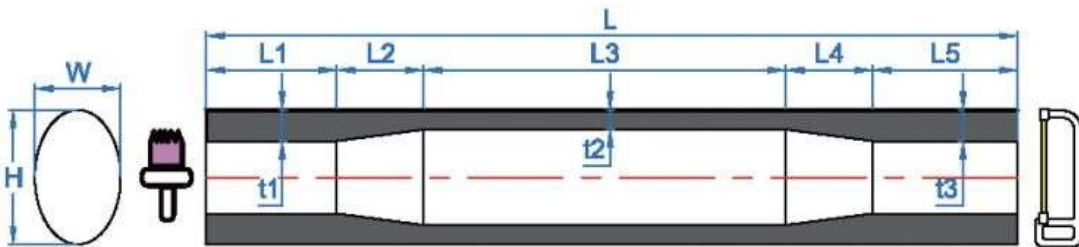

Recommend part	TANGE code	Barcode	Butted	OVAL	Thickness t1 - t2 - t3	Butted Distribution L1 - L2 - L3 - L4 - L5	Length (mm)	Weight (g)	Heat Treatment	Finish
Oval Top Tube	TOV254-29-600	4712883580307	Double Butted Tube	W25.4 x H28.6	0.7-0.4-0.7	80-50-290-50-130	600	217	YES	Polished #400
Oval Top Tube	TOV286-29-600	4712883580314	Double Butted Tube	W28.6 x H31.8	0.7-0.4-0.7	80-50-290-50-130	800	243	YES	Polished #400

D.B.T
Double Butted Tube

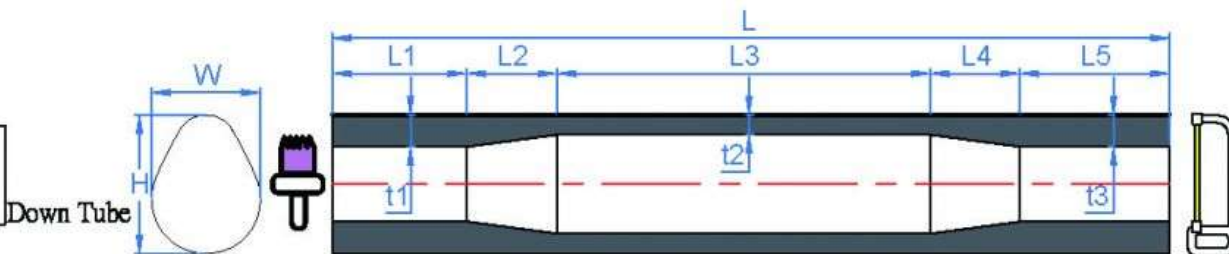

Recommend part	TANGE code	Barcode	Butted	AREO	Thickness t1 - t2 - t3	Butted Distribution L1 - L2 - L3 - L4 - L5	Length (mm)	Weight (g)	Heat Treatment	Finish
Areo Down Tube	TAR286-34-650	4712883580321	Double Butted Tube	W28.6 x H35	0.7-0.4-0.7	80-50-340-50-130	650	268	YES	Polished #400
Areo Down Tube	TAR300-34-650	4712883580338	Double Butted Tube	W30 x H39	0.7-0.4-0.7	80-50-340-50-130	650	293	YES	Polished #400

S.B.T
Single Butted Tube

Seat Tube
For 27.2mm Post



Recommend part	TANGE code	Barcode	Butted	OD	Thickness t1 - t2	Butted Distribution L1 - L2 - L3	Length (mm)	Weight (g)	Heat Treatment	Finish
Seat Tube	TPR286-95-600	4712883580062	Single Butted Tube	28.6	0.9-0.6	90-50-460	600	277	YES	Polished #400

S.B.T
Single Butted Tube

Seat Stay
Chain Stay
Fork Blade

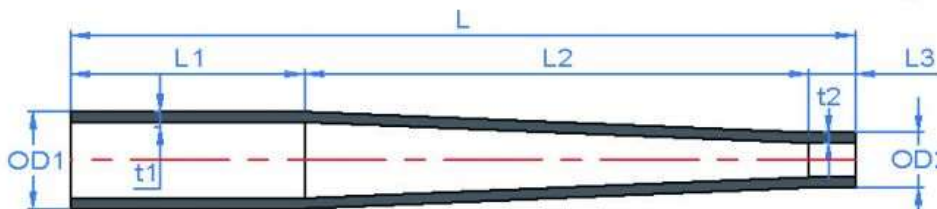

Recommend part	TANGE code	Barcode	Butted	OD1 / OD2	Thickness t1 - t2	Butted Distribution L1 - L2 - L3	Length (mm)	Weight (g)	Heat Treatment	Finish
Seat stay	TPJ14-125-7ET-600	4712883580345	Single Butted Tube	14 / 12.5	0.7 Even-thick	300-265-15	600	134	NO	Polished #400
Seat stay	TPJ16-125-7ET-600	4712883580352	Single Butted Tube	16 / 12.5	0.7 Even-thick	320-265-15	600	151	NO	Polished #400
Chain Stay	TPR222-125-08E-450	4712883580369	Single Butted Tube	22.2 / 12.5	0.8 Even-thick	170-265-15	450	162	NO	Polished #400
Chain Stay	TPR222-125-08E-450V	4712883580376	Single Butted Tube	22.2 (OVAL 27/17)/12.5	0.8 Even-thick	170-265-15	450	162	NO	Polished #400
Chain Stay	TPR222-125-86B-450	4712883580383	Single Butted Tube	22.2/12.5	0.8-0.6	170-265-15	450	177	NO	Polished #400
Chain Stay	TPR24-125-8ET-450V	4712883580390	Single Butted Tube	24(OVAL 28/20)/12.5	0.8 Even-thick	170-265-15	450	173	NO	Polished #400
Chain Stay II	TPJ24-125-74B-420V	4712883581618	Single Butted Tube	24(OVAL 30/17)/12.5	0.7-0.5(0.7-1.0)	100-50-270	420	150	NO	Polished #400
Fork Blade	TPR24-125-1ET-420	4712883580406	Single Butted Tube	24 / 12.5	1.0 Even-thick	140-265-15	420	198	NO	Polished #400
Fork Blade	TPR24-125-1ET-420V	4712883580413	Single Butted Tube	24 (OVAL 28/20) /12.5	1.0 Even-thick	140-265-15	420	198	NO	Polished #400

S.B.T
Single Butted Tube

Seat Tube
For 27.2mm Post

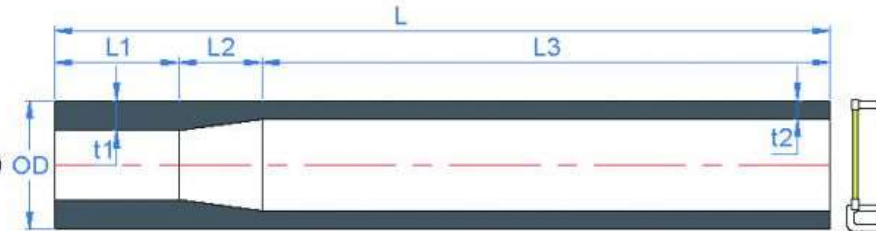

Recommend part	TANGE code	Barcode	Butted	OD	Thickness t1 - t2	Butted Distribution L1 - L2 - L3	Length (mm)	Weight (g)	Heat Treatment	Finish
Seat Tube	TPR286-95-600	4712883580062	Single Butted Tube	28.6	0.9-0.6	90-50-460	600	277	YES	Polished #400

S.B.T
Single Butted Tube

Seat Stay
Chain Stay
Fork Blade

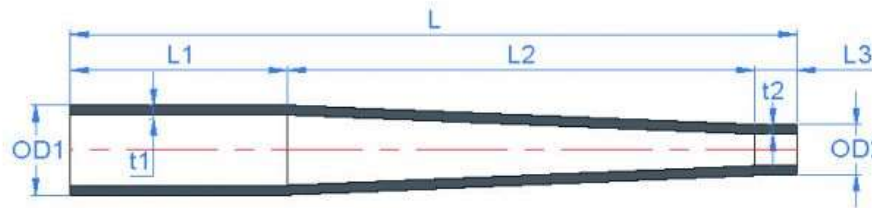

Recommend part	TANGE code	Barcode	Butted	OD1 / OD2	Thickness t1 - t2	Butted Distribution L1 - L2 - L3	Length (mm)	Weight (g)	Heat Treatment	Finish
Seat stay	TPR14-125-8ET-600	4712883580543	Single Butted Tube	14 / 12.5	0.8 Even-thick	375-210-15	600	152	NO	Polished #400
Seat stay	TPR16-125-8ET-600	4712883580550	Single Butted Tube	16 / 12.5	0.8 Even-thick	320-265-15	600	172	NO	Polished #400
Chain Stay	TPR222-125-08E-450	4712883580567	Single Butted Tube	22.2 / 12.5	0.8 Even-thick	170-265-15	450	162	NO	Polished #400
Chain Stay	TPR222-125-08E-450V	4712883580574	Single Butted Tube	OVAL 27/17 (22.2) / 12.5	0.8 Even-thick	170-265-15	450	162	NO	Polished #400
Chain Stay	TPR222-125-86B-450	4712883580581	Single Butted Tube	22.2 / 12.5	0.8-0.6	170-265-15	450	177	NO	Polished #400
Chain Stay	TPR24-125-8ET-450V2	4712883580598	Single Butted Tube	24 (OVAL 30/17) / 12.5	0.8 Even-thick	170-265-15	450	173	NO	Polished #400
Fork Blade	TPR24-125-1ET-420	4712883580406	Single Butted Tube	24 / 12.5	1.0 Even-thick	140-265-15	420	198	NO	Polished #400
Fork Blade	TPR24-125-1ET-420V	4712883580413	Single Butted Tube	24 (OVAL 28/20) / 12.5	1.0 Even-thick	140-265-15	420	198	NO	Polished #400



PRESTIGE

TRULY SEAMLESS DOUBLE BUTTED TUBES,
HEAT-TREATED

D.B.T
Double Butted Tube

Top Tube
Down Tube

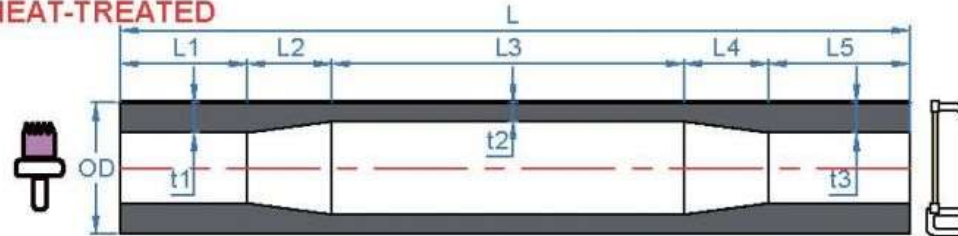

Recommend part	TANGE code	Barcode	Butted	OD	Thickness t1 - t2 - t3	Butted Distribution L1 - L2 - L3 - L4 -	Length (mm)	Weight (g)	Heat Treatment	Finish
Top Tube	TPR254-24-600	4712883580420	Double Butted	25.4	0.8-0.5-0.8	80-50-240-50-180	600	248	YES	Polished #400
Top Tube	TPR254-29-600	4712883580437	Double Butted	25.4	0.8-0.5-0.8	80-50-290-50-130	600	240	YES	Polished #400
Top / Seat Tube	TPR286-25-6206	4712883581953	Double Butted	28.6	0.8-0.6-0.7	210-50-250-50-60	620	300	YES	Polished #400
Top / Seat Tube	TPR286-25-6207	4712883581625	Double Butted	28.6	0.8-0.5-0.7	210-50-250-50-60	620	285	YES	Polished #400
Top Tube	TPR286-24-600	4712883580444	Double Butted	28.6	0.8-0.5-0.8	80-50-240-50-180	600	281	YES	Polished #400
Top / Down	TPR286-29-650	4712883580451	Double Butted	28.6	0.8-0.5-0.8	80-50-290-50-180	650	298	YES	Polished #400
Top / Down	TPR286-34-650	4712883580468	Double Butted	28.6	0.8-0.5-0.8	80-50-340-50-130	650	288	YES	Polished #400
Down Tube	TPR318-28-650	4712883580482	Double Butted	31.8	0.8-0.5-0.8	80-50-280-50-190	650	335	YES	Polished #400
Down Tube	TPR318-33-650	4712883580499	Double Butted	31.8	0.8-0.5-0.8	80-50-330-50-140	650	323	YES	Polished #400
Down Tube	TPR349-30-650	4712883580505	Double Butted	34.9	0.8-0.5-0.8	80-50-300-50-170	650	363	YES	Polished #400
Down Tube	TPR349-34-650	4712883580512	Double Butted	34.9	0.8-0.5-0.8	80-50-340-50-130	650	353	YES	Polished #400
Down Tube	TPR381-34-650	4712883580529	Double Butted	38.1	0.8-0.5-0.8	80-50-340-50-130	650	386	YES	Polished #400

B.B.T
Bulge Butted Tube

Seat Tube
For 27.2 Post

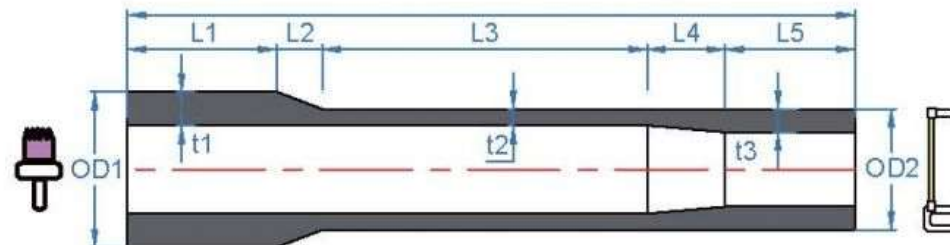

Recommend part	TANGE code	Barcode	Butted	OD1 / OD2	Thickness t1 - t2	Butted Distribution	Length (mm)	Weight (g)	Heat Treatment	Finish
Seat Tube	TPR298-28-600	4712883581366	Bulge Butted Tube	29.8 / 28.8	1.2-0.6-0.9	100-25-280-25-170	600	347	YES	Polished #400
Seat Tube	TPR298-28-650	4712883581403	Bulge Butted Tube	29.8 / 28.8	1.2-0.6-0.9	100-25-280-25-220	650	387	YES	Polished #400



PRESTIGE O.S

TRUL SEAMLESS DOUBLE BUTTED TUBES,
HEAT-TREATED

D.B.T
Double Butted Tube

Top Tube
Down Tube

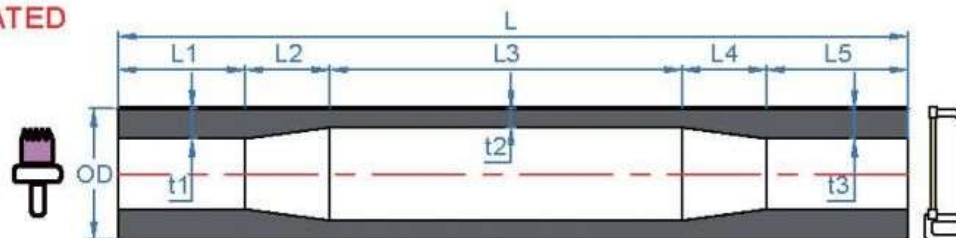

TANGE code	Barcode	Butted	OD	Thickness t1 - t2 - t3	Butted Distribution L1 - L2 - L3 - L4 -	Length (mm)	Weight (g)	Heat Treatmen	Finish
TPO286-24-600	4712883581823	Double Butted	28.6	0.9-0.6-0.9	80-50-240-50-180	600	320	YES	Polished #400
TPO286-29-600	4712883581830	Double Butted	28.6	0.9-0.6-0.9	80-50-290-50-130	600	341	YES	Polished #400
TPO286-34-650	4712883581847	Double Butted	28.6	0.9-0.6-0.9	80-50-340-50-130	650	331	YES	Polished #400
TPO318-30-650	4712883581854	Double Butted	31.8	0.9-0.6-0.9	80-50-300-50-170	650	383	YES	Polished #400
TPO318-34-650	4712883581861	Double Butted	31.8	0.9-0.6-0.9	80-50-340-50-130	650	367	YES	Polished #400
TPO318-34-6507	4712883581960	Double Butted	31.8	0.9-0.7-0.9	80-50-340-50-130	650	400	YES	Polished #400
TPO349-29-650	4712883581878	Double Butted	34.9	0.9-0.6-0.9	80-50-290-50-180	650	419	YES	Polished #400
TPO349-34-650	4712883581885	Double Butted	34.9	0.9-0.6-0.9	80-50-340-50-130	650	406	YES	Polished #400



CHAMPION No.1

DOUBLE BUTTED TUBES FOR TRACK / ROAD RACING

D.B.T
Double Butted Tube

Top Tube
Down Tube

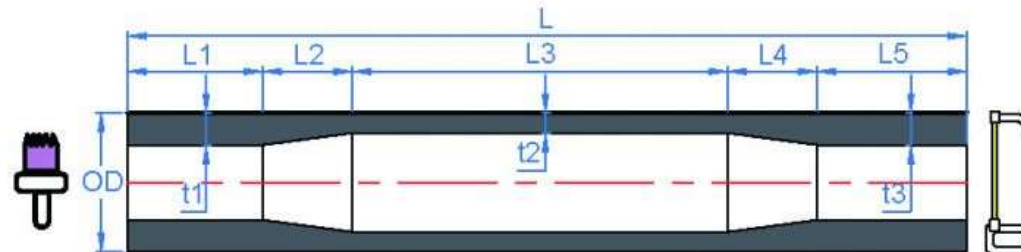

Recommend part	TANGE code	Barcode	Butted	OD	Thickness $t_1 - t_2 - t_3$	Butted Distribution $L_1 - L_2 - L_3 - L_4 - L_5$	Length (mm)	Weight (g)	Heat Treatment	Finish
Top Tube	TN1254-24-600	4712883580604	Double Butted Tube	25.4	0.8-0.5-0.8	80-50-240-50-180	600	248	NO	Polished #400
Top Tube	TN1254-29-600	4712883580611	Double Butted Tube	25.4	0.8-0.5-0.8	80-50-290-50-130	600	239	NO	Polished #400
Top Tube	TN1254-34-600	4712883581496	Double Butted Tube	25.4	0.8-0.5-0.8	80-50-340-50-80	600	235	NO	Polished #400
Top Tube	TN1286-24-600	4712883580628	Double Butted Tube	28.6	0.8-0.5-0.8	80-50-240-50-180	600	281	NO	Polished #400
Top / Down Tube	TN1286-29-650	4712883580635	Double Butted Tube	28.6	0.8-0.5-0.8	80-50-290-50-180	650	298	NO	Polished #400
Down Tube	TN1286-34-650	4712883580642	Double Butted Tube	28.6	0.8-0.5-0.8	80-50-340-50-130	650	288	NO	Polished #400
Down Tube	TN1318-28-650	4712883580666	Double Butted Tube	31.8	0.8-0.5-0.8	80-50-280-50-190	650	335	NO	Polished #400
Down Tube	TN1318-33-650	4712883580673	Double Butted Tube	31.8	0.8-0.5-0.8	80-50-330-50-140	650	323	NO	Polished #400



CHAMPION No.2

DOUBLE BUTTED TUBES TRACK / ROADING / TOURING

D.B.T
Double Butted Tube

Top Tube
Down Tube

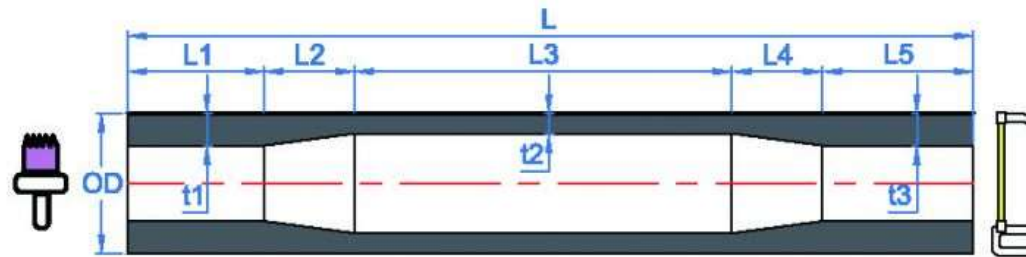

Recommend part	TANGE code	Barcode	Butted	OD	Thickness t1 - t2 - t3	Butted Distribution L1 - L2 - L3 - L4 - L5	Length (mm)	Weight (g)	Heat Treatment	Finish
Top Tube	TN2254-24-600	4712883580680	Double Butted Tube	25.4	0.9-0.6-0.9	80-50-240-50-180	600	284	NO	Polished #400
Top Tube	TN2254-29-600	4712883580697	Double Butted Tube	25.4	0.9-0.6-0.9	80-50-290-50-130	600	275	NO	Polished #400
Top / Down Tube	TN2286-24-600	4712883580703	Double Butted Tube	28.6	0.9-0.6-0.9	80-50-240-50-180	600	320	NO	Polished #400
Top Tube	TN2286-29-600	4712883580710	Double Butted Tube	28.6	0.9-0.6-0.9	80-50-290-50-130	600	341	NO	Polished #400
Down Tube	TN2286-34-650	4712883580727	Double Butted Tube	28.6	0.9-0.6-0.9	80-50-340-50-130	650	331	NO	Polished #400
Down Tube	TN2318-30-650	4712883580741	Double Butted Tube	31.8	0.9-0.6-0.9	80-50-300-50-170	650	383	NO	Polished #400
Down Tube	TN2318-35-650	4712883580758	Double Butted Tube	31.8	0.9-0.6-0.9	80-50-350-50-120	650	367	NO	Polished #400
Down Tube	TN2349-29-650	4712883580765	Double Butted Tube	34.9	0.9-0.6-0.9	80-50-290-50-180	650	419	NO	Polished #400
Down Tube	TN2349-34-650	4712883580772	Double Butted Tube	34.9	0.9-0.6-0.9	80-50-340-50-130	650	406	NO	Polished #400
Down Tube	TN2349-42-700	4712883580789	Triple Butted Tube	34.9	1.0-0.6-0.9	80-50-420-50-100	700	424	NO	Polished #400



CHAMPION No.3

DOUBLE BUTTED TUBES FOR HEAVY DUTY TOURING / MTB / BMX

D.B.T
Double Butted Tube

Top Tube
Down Tube

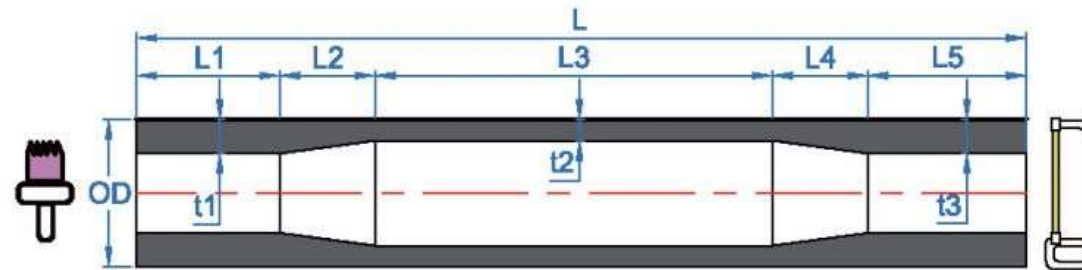

Recommend part	TANGE code	Barcode	Butted	OD	Thickness t1 - t2 - t3	Butted Distribution L1 - L2 - L3 - L4 - L5	Length (mm)	Weight (g)	Heat Treatment	Finish
Top Tube	TN3254-24-600	4712883580796	Double Butted Tube	25.4	1.0-0.7-1.0	80-50-240-50-180	600	319	NO	Polished #400
Top Tube	TN3254-29-600	4712883580802	Double Butted Tube	25.4	1.0-0.7-1.0	80-50-290-50-130	600	310	NO	Polished #400
Top Tube	TN3254-31-600	4712883580819	Double Butted Tube	25.4	1.0-0.7-1.0	80-50-310-50-110	600	307	NO	Polished #400
Top / Down Tube	TN3286-29-650	4712883580833	Double Butted Tube	28.6	1.0-0.7-1.0	80-50-290-50-180	650	384	NO	Polished #400
Down Tube	TN3286-34-650	4712883580840	Double Butted Tube	28.6	1.0-0.7-1.0	80-50-340-50-130	650	374	NO	Polished #400
Down Tube	TN3318-30-650	4712883580864	Double Butted Tube	31.8	1.0-0.7-1.0	80-50-300-50-170	650	427	NO	Polished #400
Down Tube	TN3318-35-650	4712883580871	Double Butted Tube	31.8	1.0-0.7-1.0	80-50-350-50-120	650	416	NO	Polished #400
Down Tube	TN3349-29-650	4712883580888	Double Butted Tube	34.9	1.0-0.7-1.0	80-50-290-50-180	650	472	NO	Polished #400
Down Tube	TN3349-34-650	4712883580895	Double Butted Tube	34.9	1.0-0.7-1.0	80-50-340-50-130	650	460	NO	Polished #400
Down Tube	TN3381-32-650	4712883580918	Double Butted Tube	38.1	1.0-0.7-1.0	80-50-320-50-150	650	508	NO	Polished #400
Down Tube	TN3381-40-720	4712883580925	Double Butted Tube	38.1	1.0-0.7-1.0	80-50-400-50-140	720	551	NO	Polished #400
Down Tube	TN3381-32-720	4712883580932	Double Butted Tube	38.1	1.1-0.6-0.9	150-50-320-70-150	720	543	NO	Polished #400
Down Tube	TN3318-29-650	4712883580956	Double Butted Tube	31.8	1.2-0.9-1.2	80-50-290-50-180	650	524	NO	Polished #400
Down Tube	TN3318-34-650	4712883580963	Double Butted Tube	31.8	1.2-0.9-1.2	80-50-340-50-130	650	514	NO	Polished #400

CHAMPION GRADE

SEAT TUBE

B.B.T
Bulge Butted Tube

Seat Tube
For 27.2 Post

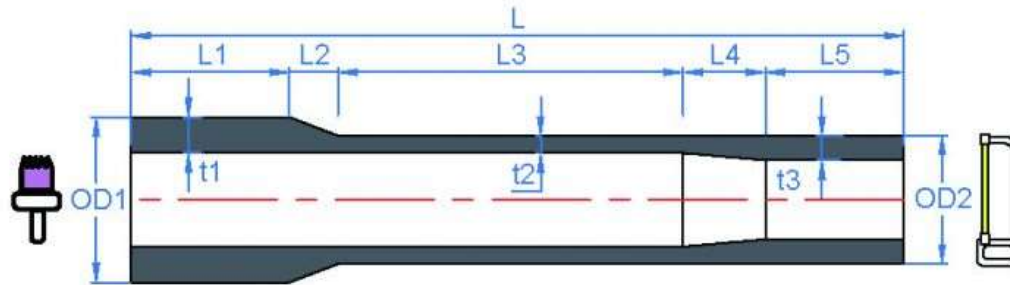

Recommend part	TANGE code	Barcode	Butted	OD1 / OD2	Thickness t1 - t2	Butted Distribution L1 - L2 - L3	Length (mm)	Weight (g)	Heat Treatment	Finish
Seat Tube	TCC298-28-600	4712883580970	Bulge Butted Tube	29.8 / 28.8	1.2-0.6-0.9	100-25-280-25-170	600	347	NO	Polished #400
Seat Tube	TCC298-28-650	4712883581731	Bulge Butted Tube	29.8 / 28.8	1.2-0.6-0.9	100-25-280-25-220	600	387	NO	Polished #400

S.B.T
Single Butted Tube

Seat Tube
For 27.2mm Post

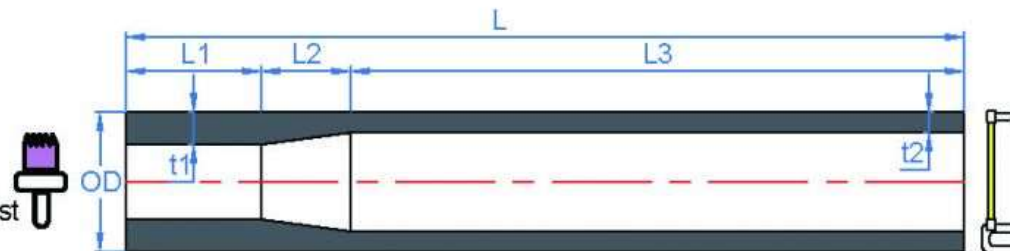

Recommend part	TANGE code	Barcode	Butted	OD	Thickness t1 - t2	Butted Distribution L1 - L2 - L3	Length (mm)	Weight (g)	Heat Treatment	Finish
Seat Tube	TCC286-95-600	4712883580987	Single Butted Tube	28.6	0.9-0.6	90-50-460	600	277	NO	Polished #400

CHAMPION GRADE

SEAT STAY & CHAIN STAYS

S.B.T
Single Butted Tube

Seat Stay
Chain Stay

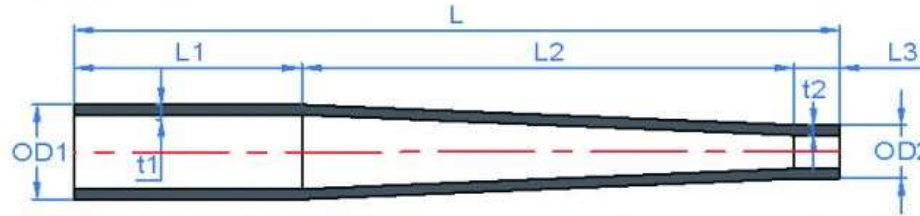

Recommend part	TANGE code	Barcode	Butted	OD1 / OD2	Thickness t1 (t1 - t2)	Butted Distribution L1 - L2 - L3	Length (mm)	Weight (g)	Heat Treatment	Finish
Seat stay	TCS14-11-08P-600	4712883581748	Plan Gauge	14 / 11	0.8PG	280-305-15	600	156	NO	Polished #400
Seat stay	TCS14-125-08P-600	4712883580994	Plan Gauge	14 / 12.5	0.8PG	375-210-15	600	156	NO	Polished #400
Seat stay	TCS16-125-08P-600	4712883581007	Plan Gauge	16 / 12.5	0.8PG	320-265-15	600	180	NO	Polished #400
Seat stay	TCS19-125-08P-600	4712883581014	Plan Gauge	19 / 12.5	0.8PG	320-265-15	600	215	NO	Polished #400
Chain stay	TCC222-125-08P-450	4712883581021	Plan Gauge	22.2 / 12.5	0.8PG	170-265-15	450	190	NO	Polished #400
Chain stay	TCC222-125-08P-450V	4712883581038	Plan Gauge	OVAL 27/17 (22.2) / 12.5	0.8PG	170-265-15	450	190	NO	Polished #400
Chain stay	TCC24-125-08P-450V	4712883581045	Plan Gauge	24 (OVAL 30/17) / 12.5	0.8PG	170-265-15	450	205	NO	Polished #400

CHAMPION GRADE

FORK STEERER

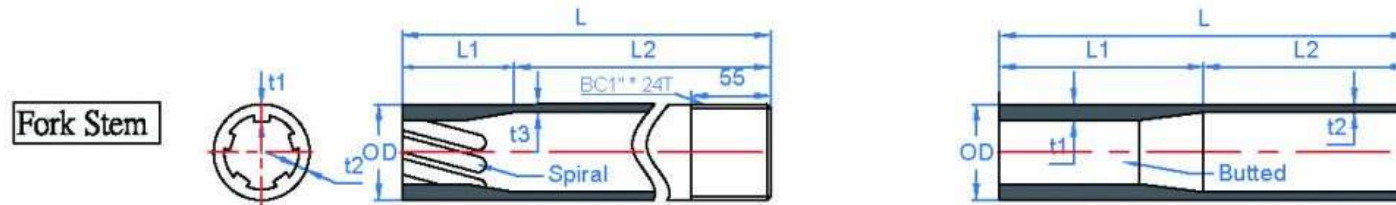

Recommend part	TANGE code	Barcode	Butted	OD	Thickness t1 - t2	Butted Distribution L1 - L2	Length (mm)	Weight (g)	Heat Treatment	Finish
Fork Steerer	TCS254-SPR-180	4712883581229	Single Butted Tube	25.4 Spira	2.5-1.6	60-120	180	198	NO	RAW
Fork Steerer	TCS254-SPR-220	4712883581236	Single Butted Tube	25.4 Spiral	2.5-1.6	60-160	220	235	NO	RAW
Fork Steerer	TCS254-SPR-240	4712883581243	Single Butted Tube	25.4 Spiral	2.5-1.6	60-180	240	255	NO	RAW
Fork Steerer	TCS254-SPR-260	4712883581250	Single Butted Tube	25.4 Spiral	2.5-1.6	60-200	260	270	NO	RAW
Fork Steerer	TCS254-SPR-280	4712883581816	Single Butted Tube	25.4 Spiral	2.5-1.6	60-220	280	290	NO	RAW
Fork Steerer	TCS254-SPB-350	4712883581809	Single Butted Tube	25.4 Spiral	2.5/2.3-2.15	60-290	350	198	NO	RAW
Fork Steerer	TCS254-BT-260	4712883581274	Single Butted Tube	25.4 Butted	2.4-1.6	80-180	260	275	NO	RAW
Fork Steerer	TCS254-BT-350	4712883581281	Single Butted Tube	25.4 Butted	2.4-1.6	80-270	350	360	NO	RAW
Fork Steerer	TCS254-BT-500	4712883581298	Single Butted Tube	25.4 Butted	2.4-1.6	80-420	500	500	NO	RAW
Fork Steerer	TCS286-BT-350	4712883581304	Single Butted Tube	28.6 Butted	2.4-1.6	80-270	350	375	NO	RAW
Fork Steerer	TCS286-BT-500	4712883581311	Single Butted Tube	28.6 Butted	2.4-1.6	80-420	500	570	NO	RAW



CHAMPION GRADE

FORK BLADE

S.B.T

Single Butted Tube FORK Blade

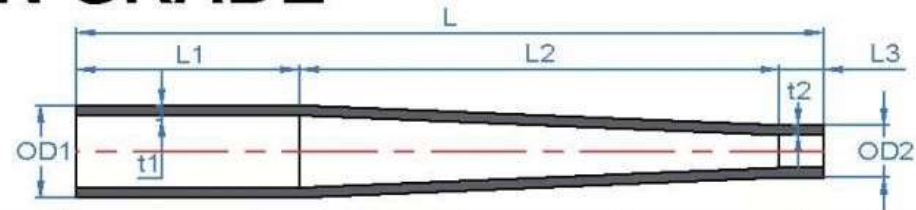

Recommend part	TANGE code	Barcode	Butted	OD1 / OD2	Thickness t1 (t1 - t2)	Butted Distribution L1 - L2 - L3	Length (mm)	Weight (g)	Heat Treatment	Finish
Fork Blade	TCB24-125-10P-420	4712883581052	Plan Gauge	24 / 12.5	1.0 PG	170-235-15	420	257	NO	Polished #400
Fork Blade	TCB24-125-10P-420V	4712883581069	Plan Gauge	24(OVAL28/20) / 12.5	1.0 PG	170-235-15	420	257	NO	Polished #400
Fork Blade	TCB24-125-12P-420	4712883581076	Plan Gauge	24 / 12.5	1.2 PG	170-235-15	420	301	NO	Polished #400
Fork Blade	TCB24-125-12P-420V	4712883581083	Plan Gauge	24(OVAL28/20) / 12.5	1.2 PG	170-235-15	420	301	NO	Polished #400
Fork Blade	TCB24-125-12D-420	4712883581090	Single Butted Tube	24 / 12.5	1.2-0.9	170-235-15	420	242	NO	Polished #400
Fork Blade	TCB254-17-12D-420	4712883581106	Single Butted Tube	25.4 / 17	1.2-0.9	200-220	420	295	NO	Polished #400
Fork Blade	TCB286-20-14D-420	4712883581113	Single Butted Tube	28.6 / 20	1.4-1.2	220-200	420	405	NO	Polished #400