

INVESTMENT CASTING  
LOST WAX

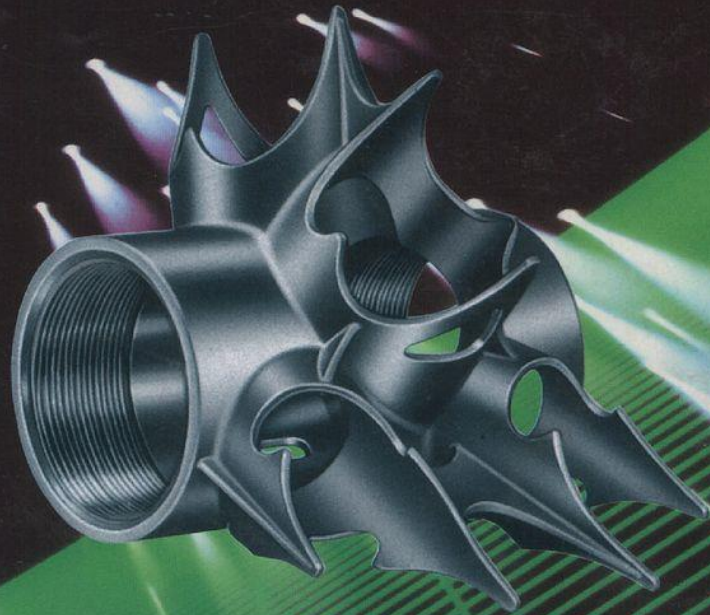

**Long Shen**

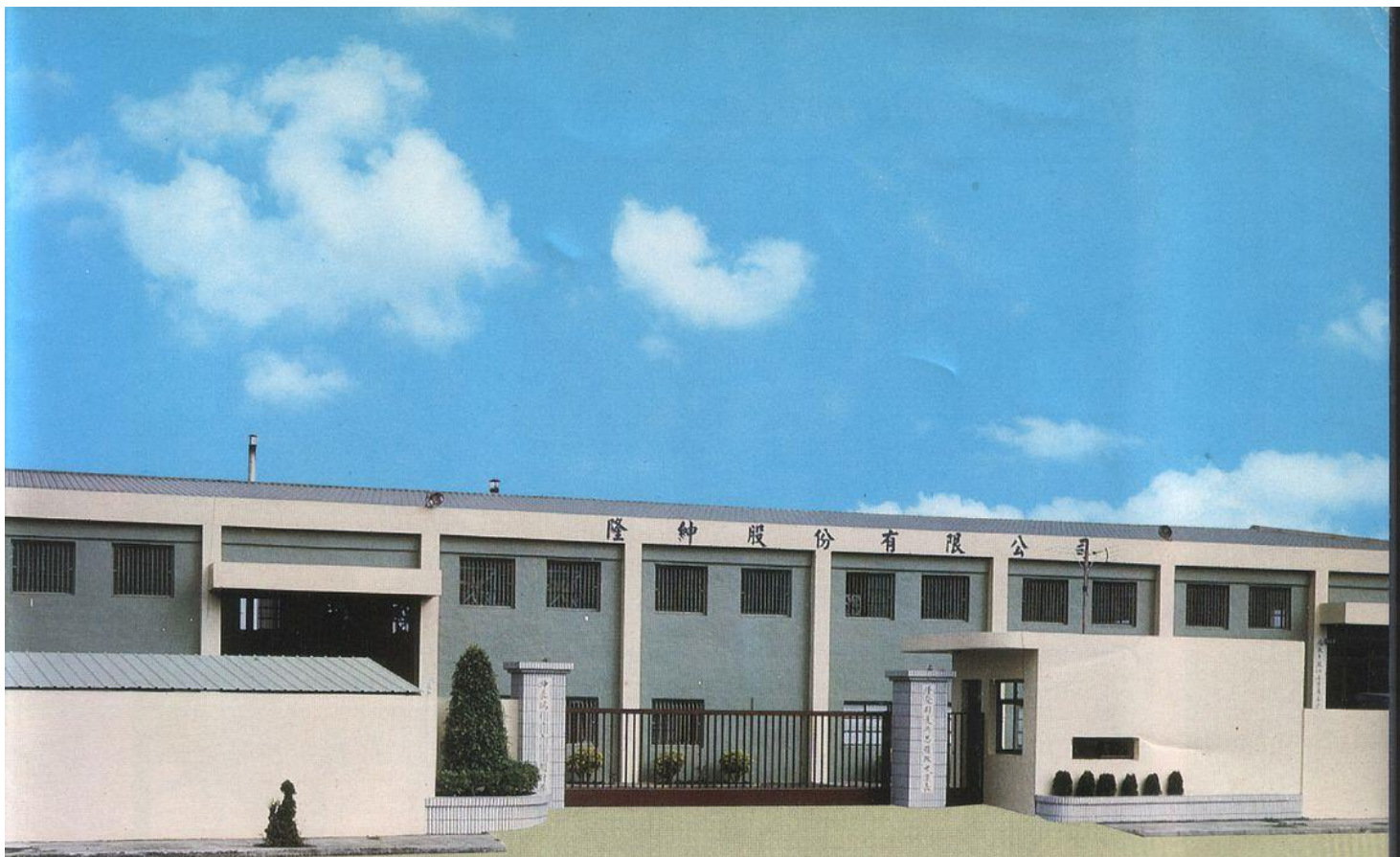



Long Shen was established in 1986 with the goal to provide the customer with the highest quality bicycle lugs and frame castings available. By adhering to high quality standards in all facets of the business including design, production and customer service Long Shen has grown rapidly yet steadily. In this short span of six years Long Shen has matured to where it is now recognized as the leader in the casting field. Long Shen will continue it's dedication to quality in the future and remain the standard by which others are judged.





# 300R RACING LUG SET

INVESTMENT CASTING LOST WAX

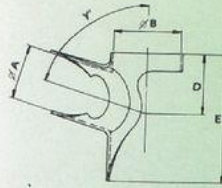

RACING TOP HEAD LUG

MODEL	LT300R
$\varnothing A$	25.4
$\varnothing B$	31.8
D	28
E	60
Y°	73°
W.T.	30g

UNIT:MM

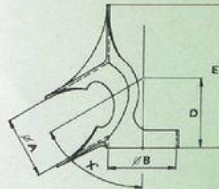

RACING BOTTOM HEAD LUG

MODEL	LD300R
$\varnothing A$	28.6
$\varnothing B$	31.8
D	32
E	66
X°	60°
W.T.	30g

UNIT:MM

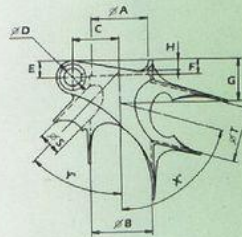

RACING SEAT LUG

MODEL	LS300R
$\varnothing A$	26.7
$\varnothing B$	28.6
C	22.5
$\varnothing D$	8.5
E	7.65
F	7
G	19.5
H	5
T	25.4
S	10.5
X°	73° 30'
Y°	45°
W.T.	85g

UNIT:MM

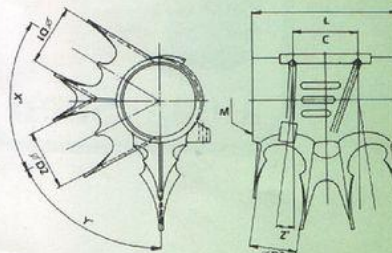

RACING B.B. SHELL

MODEL	LB300R-B	LB300R-M
$\varnothing D1$	28.6	28.6
$\varnothing D2$	28.6	28.6
$\varnothing D3$	22.2	22.2
C	30.6	30.6
L	68	70
X°	59° 30'	59° 30'
Y°	62° 30'	62° 30'
Z°	8°	8°
M	BC1 37x24T	M36x24T
W.T.	195g	195g

UNIT:MM



# 200C CROSS BIKE LUG SET

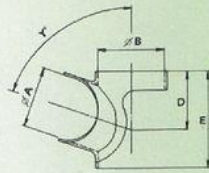

CROSS-BIKE TOP HEAD LUG

MODEL	LT200C
∅A	28.6
∅B	31.8
D	28
E	46.5
Y°	71° 72'
W.T.	25g

UNIT:MM

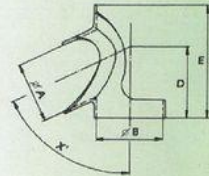

CROSS-BIKE BOTTOM HEAD LUG

MODEL	LD200C
∅A	28.6
∅B	31.8
D	34
E	52
X°	61° 62' 63° 64' 65°
W.T.	25g

UNIT:MM

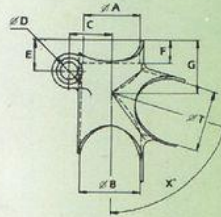
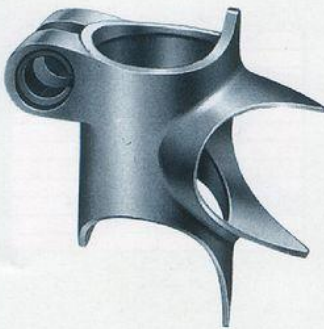

CROSS-BIKE SEAT LUG

MODEL	LS200C-2	LS700C-3
∅A	26.6	26.6
∅B	28.6	28.6
C	20	20
∅D	8.5	8.5
E	15	15
F	11	11
G	25	25
∅T	28.6	28.6
X°	72°	73° 30'
W.T.	55g	55g

UNIT:MM

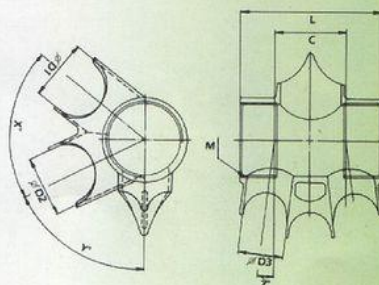

CROSS-BIKE B.B.SHELL

MOEEL	LB200C-B	LB200C-M
∅D1	28.6	28.6
∅D2	28.6	28.6
∅D3	22.2	22.2
C	34	34
L	68	70
X°	61° 50' 62° 40'	61° 50' 62° 40'
	63° 55' 65° 05'	63° 55' 65° 05'
Y°	63° 20'	63° 20'
Z	7"	7"
M	BC137x24T	M36x24T
W.T.	180g	180g

UNIT:MM

INVESTMENT CASTING LOST WAX





# 201R RACING LUG SET

INVESTMENT CASTING LOST WAX

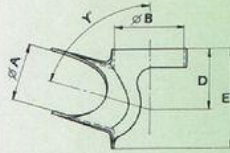

MODEL	LZ201R
$\phi A$	25.4
$\phi B$	31.8
D	28
E	45
Y	71° 72° 73° 74° 75°
W.T.	24g

UNIT:MM

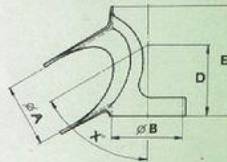
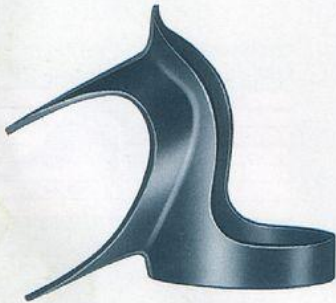

MODEL	LD201R
$\phi A$	28.6
$\phi B$	31.8
D	32
E	50
X	59° 60° 61° 62° 63°
W.T.	24g

UNIT:MM

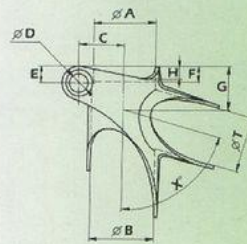

MODEL	LS201R
$\phi A$	26.7
$\phi B$	28.6
C	20
$\phi D$	8.5
E	7.65
F	6
G	19.5
H	5
$\phi T$	25.4
X	74°
W.T.	67g

UNIT:MM

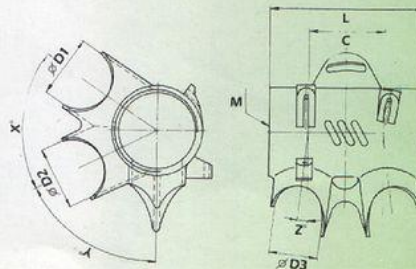

MODEL	LB201R-B	LB201R-M
$\phi D1$	28.6	28.6
$\phi D2$	28.6	28.6
$\phi D3$	22.2	22.2
C	34	34
L	68	70
X	59° 60° 61° 62° 63°	59° 60° 61° 62° 63°
Y	64°	64°
Z	7°	7°
M	BC137x24T	M36x24T
W.T.	148g	148g

UNIT:MM



# 100R RACING LUG SET

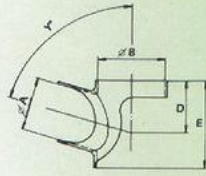

RACING TOP HEAD LUG

MODEL	LT100R
∅A	25.4
∅B	31.8
D	25
E	42
X°	73° 30'
W.T.	25g

UNIT:MM

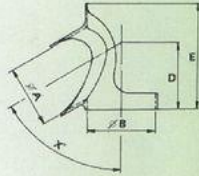

RACING BOTTOM HEAD LUG

MODEL	LD100R
∅A	28.6
∅B	31.8
D	32
E	50
X°	59° 30'
W.T.	25g

UNIT:MM

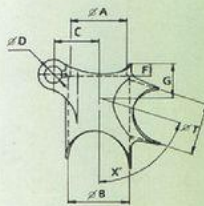
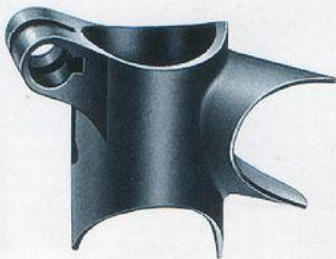

RACING SEAT LUG

MODEL	LS100R
∅A	26.8
∅B	28.6
C	23
∅D	8.5
F	6
G	15.6
T	25.4
X°	73° 30'
W.T.	52g

UNIT:MM

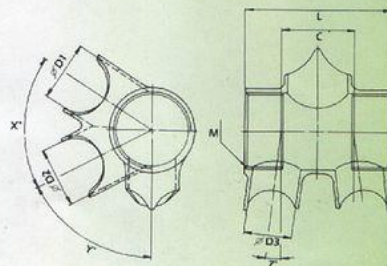
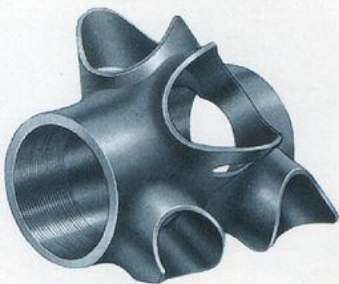

RACING B.B.SHELL

MODEL	LB100R-B	LB100R-M
∅D1	28.6	28.6
∅D2	28.6	28.6
∅D3	22.2	22.2
C	34	34
L	68	70
X°	60° 30'	60° 30'
Y°	62° 30'	62° 30'
Z°	7°	7°
M	BC137x24T	M36x24T
W.T.	183g	183g

UNIT:MM

INVESTMENT CASTING LOST WAX





# 101R RACING LUG SET WITH MONO-STAY

INVESTMENT CASTING LOST WAX

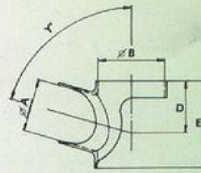
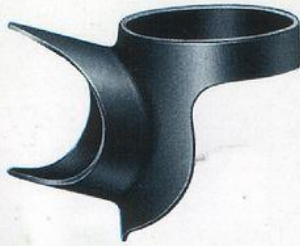

RACING TOP HEAD LUG

MODEL	LT101R
∅A	25.4
∅B	31.8
D	25
E	42
Y°	73° 30'
W.T.	25g

UNIT:MM

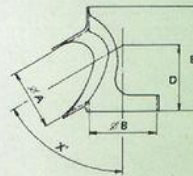

RACING BOTTOM HEAD LUG

MODEL	LD101R
∅A	28.6
∅B	31.8
D	32
E	50
X°	59° 30'
W.T.	25g

UNIT:MM

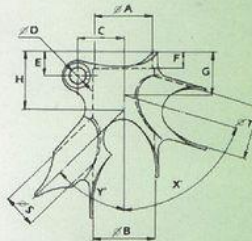

RACING SEAT LUG

MODEL	LS22-1	LS22-5	LS22-9
∅A	25.6	25.6	25.6
∅B	28.6	28.6	28.6
C	22	22	22
∅D	8.5	8.5	8.5
E	12	12	12
F	8	8	8
G	21	21	21
H	29	31	32.5
∅T	25.4	25.4	25.4
X°	73° 30'	73° 30'	73° 30'
∅S	15.9	15.9	15.9
Y°	41° 40'	45° 20'	49° 10'
W.T.	70g	70g	70g

UNIT:MM

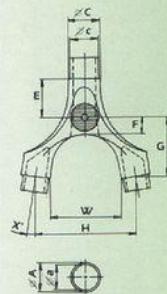
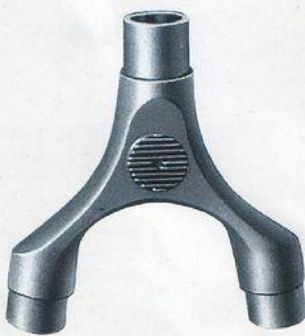

RACING WISH-BONE SEAT STAY

MODEL	LF02
∅A	14
∅a	12
∅C	16
∅c	13.9
E	18
F	8
G	28
H	48.9
W	35.1
X°	8° 30'
W.T.	65g

UNIT:MM

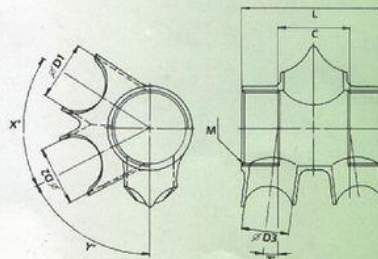

RACING B.B.SHELL

MODEL	LB100R-B	LB100R-M
∅D1	28.6	28.6
∅D2	28.6	28.6
∅D3	22.2	22.2
C	34	34
L	68	70
X°	60° 30'	60° 30'
Y°	62° 30'	62° 30'
Z°	7°	7°
M	BC137x24T	M36x24T
W.T.	183g	183g

UNIT:MM



# 102R RACING LUG SET

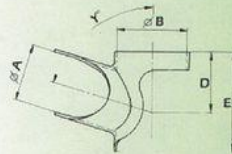

MODEL	LT102R
∅A	25.4
∅B	31.8
D	28
E	45
Y°	71° 72° 73° 74° 75°
W.T.	23g

UNIT:MM

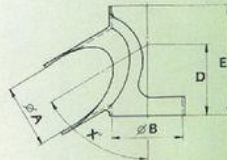
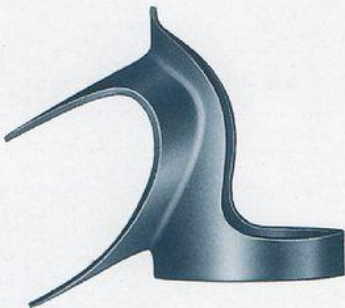

MODEL	LD102R
∅A	28.6
∅B	31.8
D	32
E	50
X°	59° 60° 61° 62° 63°
W.T.	23g

UNIT:MM

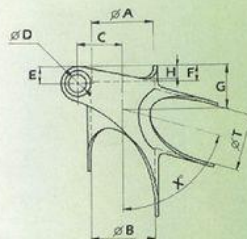

MODEL	LS102R
∅A	26.7
∅B	28.6
C	20
∅D	8.5
E	7.65
F	6
G	19.5
H	5
∅T	25.4
X°	74°
W.T.	66g

UNIT:MM

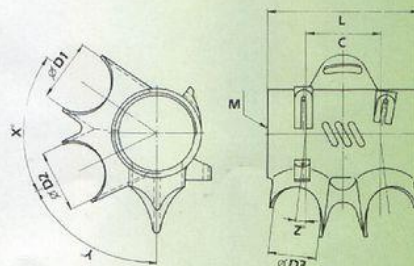
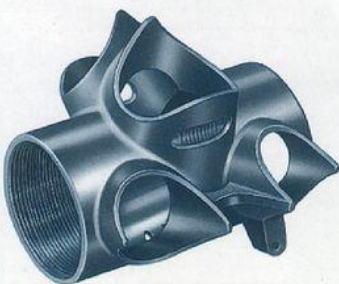

MODEL	LB102R-B	LB102R-M
∅D1	28.6	28.6
∅D2	28.6	28.6
∅D3	22.2	22.2
C	34	34
L	68	70
X°	59° 60° 61° 62° 63°	59° 60° 61° 62° 63°
Y°	64°	64°
Z°	7°	7°
M	BC137x24T	M36x24T
W.T.	148g	148g

UNIT:MM

INVESTMENT CASTING LOST WAX





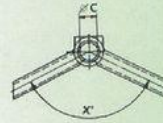

RACING REAR BRAKE BRIDGE

MODEL	LA31B
∅C	8.3
X°	1.30°
W.T.	28g

UNIT:MM

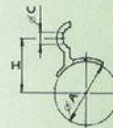

RACING FRONT DERAILLEUR BOSS

MODEL	LA01D
∅A	28.6
∅C	5.6
H	24.2
W.T.	10g

UNIT:MM

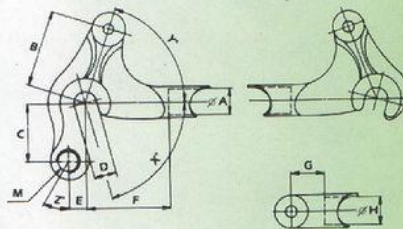

RACING DROPOUT

MODEL	LR01
∅A	14
B	35
C	26
D	10
E	8
F	36.5
M	M10x1.0
X°	75°
Y°	71°
Z°	30°
DEGREES	7°
G	15
∅H	12.5
W.T.	160g

UNIT:MM

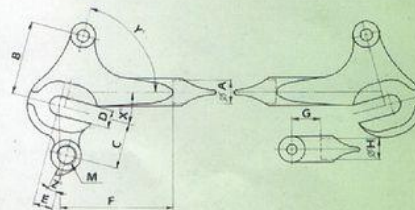

MODEL	LR03
∅A	13
B	38
C	24
D	10
E	10
F	60
M	M10x1.0
X°	15°
Y°	75° 18'
Z°	15°
DEGREES	S.S.6°/C.S.7°
G	15
∅H	11
W.T.	192g

UNIT:MM



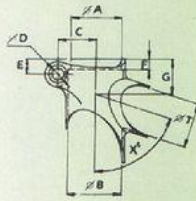

RACING SEAT LUG

MODEL	LS02A
∅A	26.7
∅B	28.6
C	20
∅D	6.5
E	10
F	7
G	20
∅T	25.4
X°	73° 30'
W.T.	48g

UNIT:MM

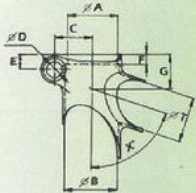

RACING SEAT LUG

MODEL	LS02B-2	LS02B-3	LS02B-4	LS02B-6	LS02B-8
∅A	26.7	26.7	26.7	26.7	26.7
∅B	28.6	28.6	28.6	28.6	28.6
C	20	20	20	20	20
∅D	8.5	8.5	8.5	8.5	8.5
E	10	10	10	10	10
F	7	7	7	7	7
G	20	20	20	20	20
∅T	25.4	25.4	25.4	25.4	25.4
X°	72°	73.30°	74°	76°	78°
W.T.	45g	45g	45g	45g	45g

UNIT:MM

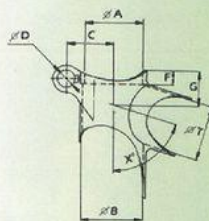

RACING SEAT LUG

MODEL	LS02C
∅A	26.7
∅B	28.6
C	22
∅D	8.5
F	6.5
G	16
∅T	25.4
X°	73° 30'
W.T.	45g

UNIT:MM

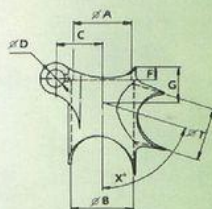
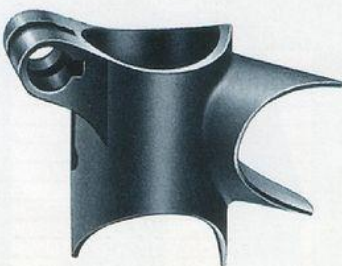

RACING SEAT LUG

MODEL	LS100R
∅A	26.8
∅B	28.6
C	23
∅D	8.5
F	6
G	15.6
∅T	25.4
X°	73° 30'
W.T.	52g

UNIT:MM



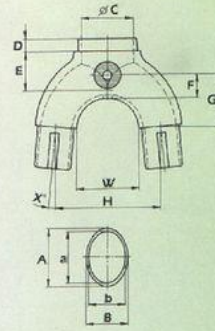

MODEL	LC20
A	28
a	26
B	20
b	18
∅C	25.4
D	6
E	17
F	11
G	25
H	30
W	50
X°	5° 05'
W.T.	118g

UNIT:MM

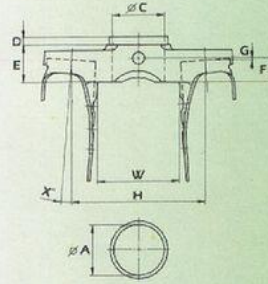

MODEL	LC19
∅A	24
∅B	25.4
D	4
E	18
F	11
G	0.8
H	64
W	40
X°	4
W.T.	118g

UNIT:MM

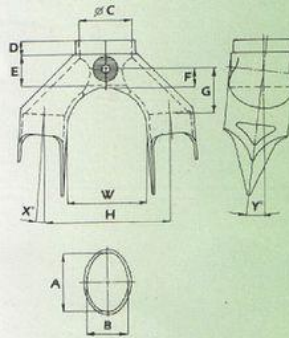
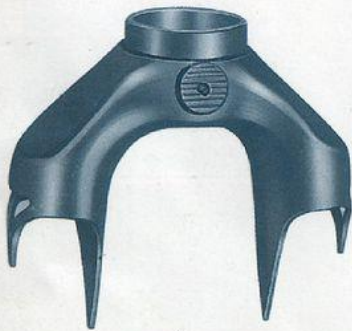

MODEL	LC18
A	28
B	20
∅C	25.4
D	6.5
E	15.5
F	9.5
G	21.5
H	60
W	38.48
X°	4°
DEGREES	6° 50'
W.T.	120g

UNIT:MM

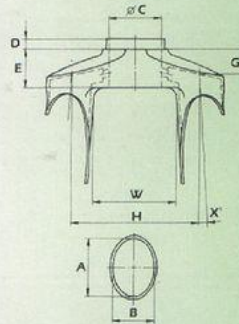

MODEL	LC17
A	28
B	20
∅C	25.4
D	5
E	18
G	12
H	62
W	41.5
X°	3° 45'
W.T.	124g

UNIT:MM

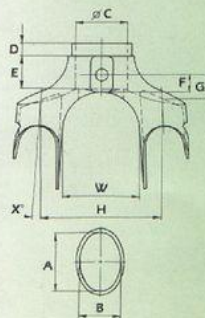
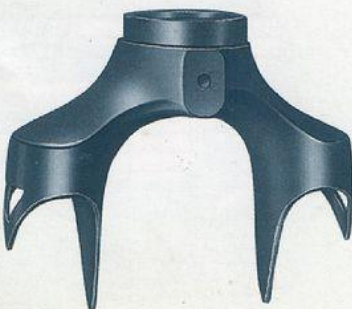

MODEL	LC16
A	28
B	20
∅C	25.4
D	6
E	16
F	8
G	13
H	37
W	59
X°	4°
W.T.	126g

UNIT:MM



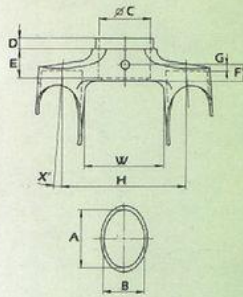

MODEL	LC15
A	28
B	20
$\varnothing$ C	25.4
D	5
E	14.5
F	7.5
G	3
H	60
W	38.5
X*	3° 50'
W.T.	92g

UNIT:MM

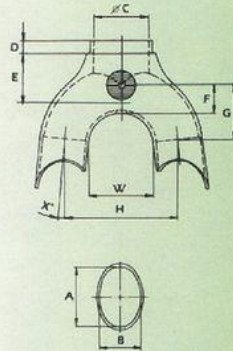

RACING FORK CROWN

MODEL	LC14
A	28
B	20
$\varnothing$ C	25.4
D	6
E	20.5
F	13
G	24.5
H	51.5
W	30
X*	5° 25'
W.T.	140g

UNIT:MM

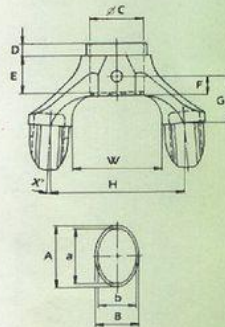
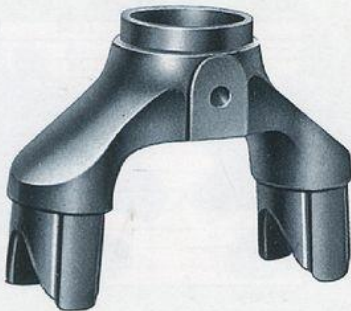

RACING FORK CROWN

MODEL	LC09
A	28
a	26
B	20
b	18
$\varnothing$ C	25.4
D	5.5
E	17
F	8
G	22
H	61
W	41
X*	3° 45'
W.T.	170g

UNIT:MM

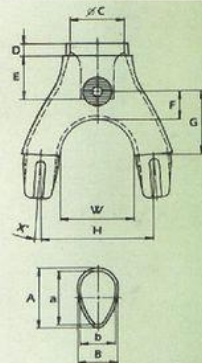

RACING FORK CROWN

MODEL	LC07
A	27.7
a	24.5
B	18.4
b	15.6
$\varnothing$ C	25.4
D	6
E	21
F	12
G	28.5
H	51.4
W	33
X*	4° 20'
W.T.	170g

UNIT:MM

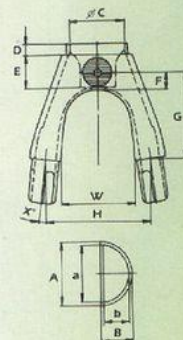

RACING FORK CROWN

MODEL	LC06A
A	28.4
a	25.5
B	14.8
b	11.4
$\varnothing$ C	25.4
D	6
E	14.5
F	8
G	38.2
H	48.2
W	33.5
X*	6° 30'
W.T.	155g

UNIT:MM



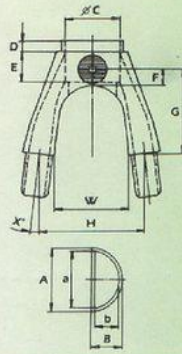

RACING FORK CROWN

MODEL	LC06B
A	29.9
a	26.8
B	15.1
b	13.2
∅C	25.4
D	6
E	14.5
F	8
G	38.1
H	48
W	33
X°	6° 30'
W.T.	175g

UNIT:MM

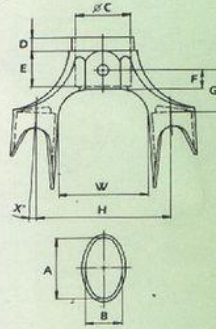
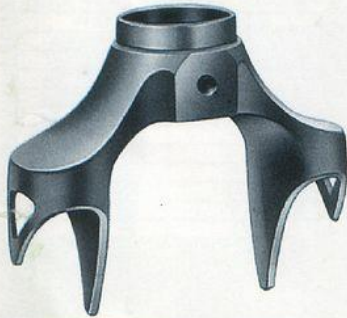

RACING FORK CROWN

MODEL	LC05
A	27.2
B	18
∅C	25.4
D	6
E	17
F	9
G	19.5
H	62
W	41
X°	3° 30'
W.T.	160g

UNIT:MM

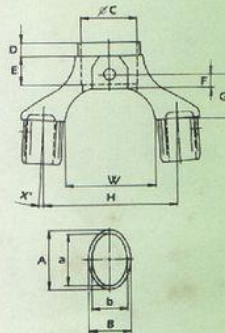

RACING FORK CROWN

MODEL	LC04
A	28
a	26
B	20
b	18
∅C	25.4
D	6
E	13
F	6.5
G	20.5
H	61.5
W	41.3
X°	3° 40'
W.T.	160g

UNIT:MM

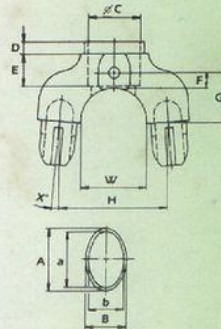

RACING FORK CROWN

MODEL	LC03
A	27
a	23.4
B	18.6
b	16.2
∅C	25.4
D	5.5
E	15.5
F	8.5
G	22.7
H	48.5
W	30
X°	4° 30'
W.T.	195g

UNIT:MM

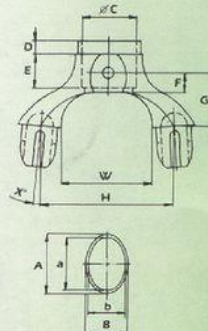

RACING FORK CROWN

MODEL	LC02		
	t1.0	t1.2	t1.4
A	26.5	26.5	26.5
a	24.1	23.6	22.9
B	20.0	20.0	20.0
b	16.5	16.3	15.7
∅C	25.4	25.4	25.4
D	6	6	6
E	17	17	17
F	9	9	9
G	32.5	32.5	32.5
H	61.5	61.5	61.5
W	42	42	42
X°	3° 40'	3° 40'	3° 40'
W.T.	160g	160g	160g

UNIT:MM



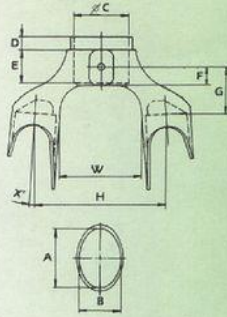

**RACING FORK CROWN**

MODEL	LC01
A	28
B	19.3
∅C	25.4
D	6
E	16
F	8
G	21
H	60
W	38.5
X*	3° 55'
W.T.	165g

UNIT:MM

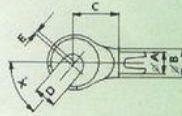
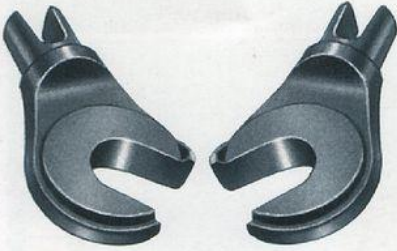

**RACING FRONT FORK TIP**

MODEL	LE02
∅A	10
∅B	13.5
C	21.5
D	10
E	2
X*	50°
DEGREES	3° 30'
W.T.	50g

UNIT:MM

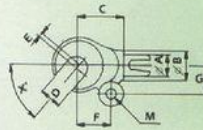
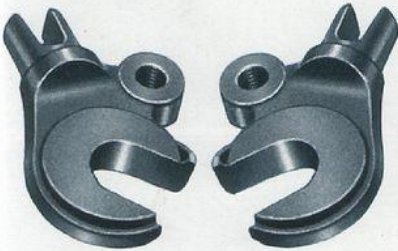

**RACING FRONT FORK TIP**

MODEL	LE02-1
∅A	10
∅B	13.5
C	21.5
D	10
E	2
F	16
G	13
M	M5x0.8
X*	50°
DEGREES	3° 30'
W.T.	55g

UNIT:MM

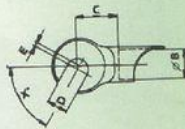
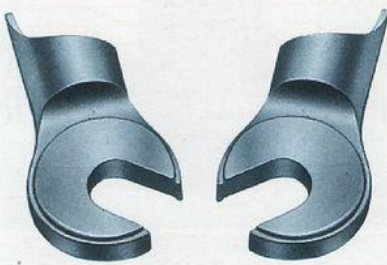

**RACING FRONT FORK TIP**

MODEL	LE03
∅B	13.4
C	19
D	9.3
E	2
X*	60°
DEGREES	4°
W.T.	55g

UNIT:MM

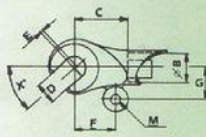
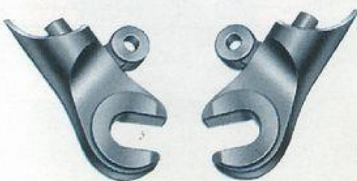

**RACING FRONT FORK TIP**

MODEL	LE05-1
∅B	14.9
C	24.7
D	10
E	1
F	18.7
G	15
M	M5x0.8
X*	42°
W.T.	70g

UNIT:MM



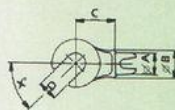

RACING FRONT FORK TIP

MODEL	LE09
∅A	10.5
∅B	12.7
C	18
D	9
X°	45°
DEGREES	4°
W.T.	40g

UNIT:MM

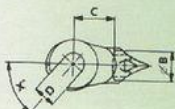

RACING FRONT FORK TIP

MODEL	LE11
∅B	13.9
C	19
D	10
X°	50°
DEGREES	5° 25'
W.T.	55g

UNIT:MM

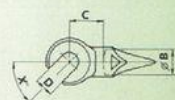

MODEL	LE17
∅B	13
C	18
D	9
X°	45°
DEGREES	4°
W.T.	42g

UNIT:MM

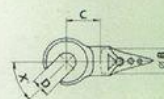

MODEL	LE17-H
∅B	13
C	18
D	9
X°	45°
DEGREES	4°
W.T.	41g

UNIT:MM



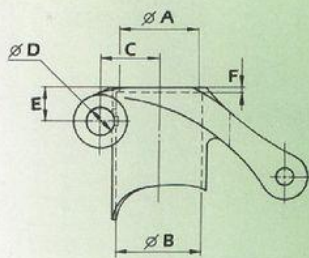

MODEL	LS20L-2
$\varnothing A$	26.2
$\varnothing B$	28.6
C	20
$\varnothing D$	8.5
E	11.5
F	1.5
W.T.	86g

UNIT:MM

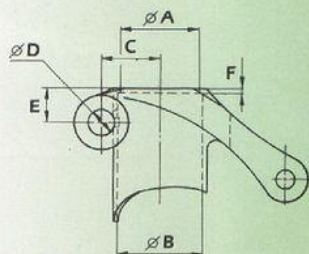

MODEL	LS02L-3
$\varnothing A$	29.4
$\varnothing B$	31.8
C	22
$\varnothing D$	8.5
E	11.5
F	1.5
W.T.	94g

UNIT:MM

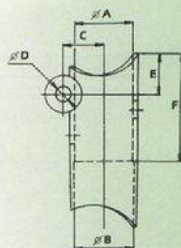

A.T.B. SEAT LUG

MODEL	LS03T	LS03T-D
$\varnothing A$	26.2-27.4	26.2-27.4
$\varnothing B$	28.6	28.6
C	19	19
$\varnothing D$	6.5	8.5
E	18	18
F	50	50
W.T.	115g	115g

UNIT:MM

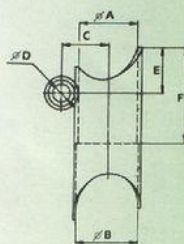

A.T.B. SEAT LUG

MODEL	LS05
$\varnothing A$	26.8
$\varnothing B$	28.6
C	21.5
$\varnothing D$	8.5
E	21
F	44
W.T.	100g

UNIT:MM



Long Shen



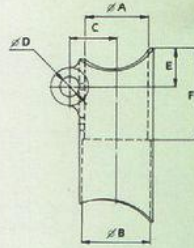

A.T.B. SEAT LUG

MODEL	LS07M
∅A	29.4
∅B	31.8
C	22
∅D	8.5
E	18
F	4.2
W.T	118g

UNIT:MM

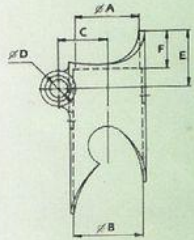

A.T.B SEAT LUG

MODEL	LS08M
∅A	29.7
∅B	31.8
C	23
∅D	8.5
E	26.5
F	17.5
W.T.	80g

UNIT:MM

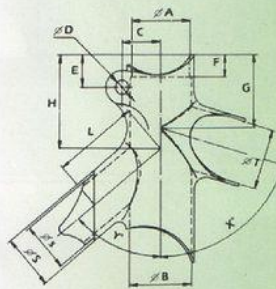

A.T.B SEAT LUG

MODEL	LS21M
∅A	26.6
∅B	28.6
C	20
∅D	6.5
E	14.5
F	10
G	33.5
H	43
∅T	28.6
X°	73°
∅S	25.4
∅S	23.2
Y°	50°
L	40
W.T	140g

UNIT:MM

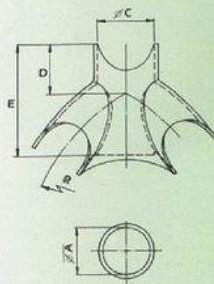

A.T.B WISH-BONE SEAT STAY

MODEL	LF01
∅A	22.2
∅C	25.4
D	23
E	5.3
R	100
W.T	95g

UNIT:MM

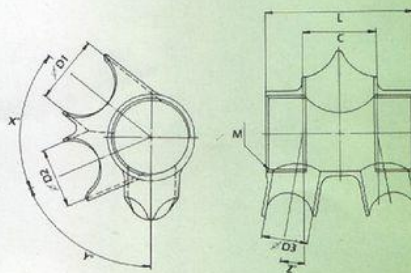
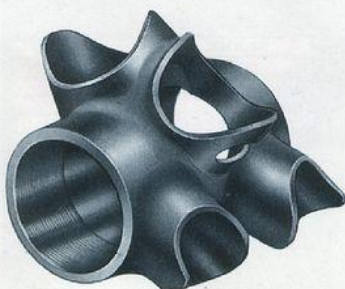

A.T.B B.B.SHELL

MODEL	LB02
∅D1	31.8
∅D2	28.6
∅D3	22.2
C	34
L	68
X°	62°
Y°	66° 30'
Z°	10° 30'
M	BC1.37x24T
W.T.	170g

UNIT:MM



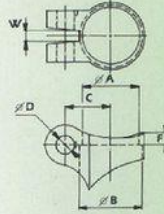

A.T.B. SEAT CLAMP

MODEL	LS01-4	LS01-6
∅A	25.8-27.4	25.8-27.4
∅B	28.6	28.6
C	21	21
∅D	9	8.5
F	6	6
W	4	6
W.T.	45g	45g

UNIT:MM

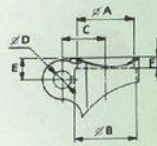

A.T.B. SEAT CLAMP

MODEL	LS01B	LS01B-C	LS01B-D
∅A	25.8	26.6	26.2
∅B	28.6	28.6	28.6
C	20	20	20
∅D	8.5	8.5	8.5
E	10	10	10
F	5	5	5
W.T.	40g	40g	40g

UNIT:MM

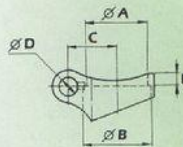

A.T.B. SEAT CLAMP

MODEL	LS01-2B
∅A	26.2
∅B	28.6
C	21
∅D	8.5
F	5
W.T.	20g

UNIT:MM

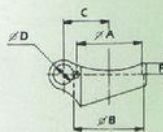

A.T.B. SEAT CLAMP

MODEL	LS01-3B
∅A	29.8
∅B	31.8
C	21
∅D	8.5
F	5
W.T.	25g

UNIT:MM

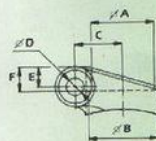

A.T.B. SEAT CLAMP

MODEL	∅A	∅B	C	∅D	E	F	W.T.
LS01C-1A	25.8	28.6	20	6.5	10.25	12.25	50g
LS01C-1B	25.8	28.6	20	8.5	10.25	12.25	55g
LS01C-2A	26.6	29.6	20	6.5	10.25	12.25	55g
LS01C-2B	26.6	29.6	20	8.5	10.25	12.25	55g
LS01C-2C	26.6	29.6	20	8.3	10.25	12.25	55g
LS01C-3A	29.0	31.8	22	6.5	10.25	12.25	60g
LS01C-3B	29.0	31.8	22	8.5	10.25	12.25	60g
LS01C-4A	30	32.8	22.5	6.5	10.25	12.25	65g
LS01C-4B	30	32.8	22.5	8.5	10.25	12.25	65g

UNIT:MM





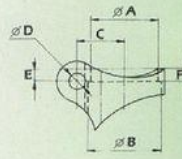

MODEL	LS26
$\varnothing A$	27.8
$\varnothing B$	29.6
C	21
$\varnothing D$	6.5
E	5
F	6
W.T.	55g

UNIT:MM

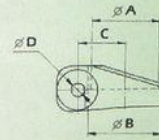
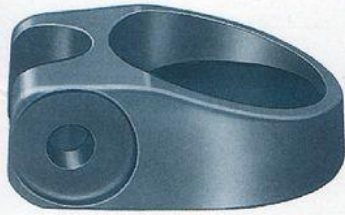

MODEL	LS25
$\varnothing A$	30
$\varnothing B$	32.8
C	21
$\varnothing D$	6.5
W.T.	50g

UNIT:MM

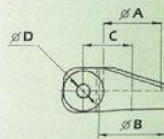
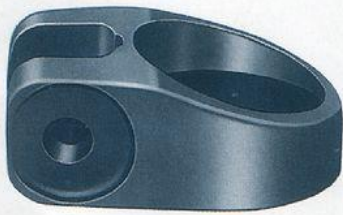

MODEL	LS25A
$\varnothing A$	26.6
$\varnothing B$	29.6
C	22
$\varnothing D$	6.5
W.T.	50g

UNIT:MM

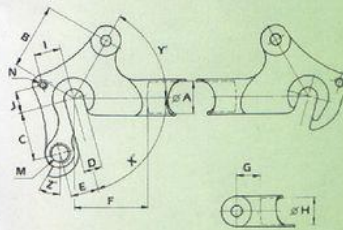
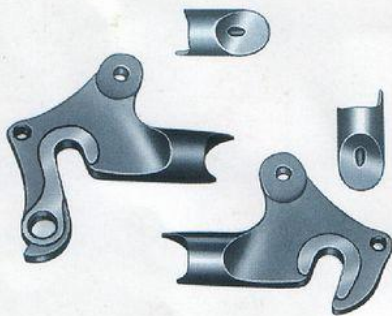

MODEL	LR02
$\varnothing A$	15.9
B	35
C	26
D	10
E	15
F	40
G	13
$\varnothing H$	14
I	14.5
J	11.5
M	M10x1.0
N	M5x0.8
X	75°
Y	60°
Z	30°
DEGREES	6° 30'
W.T.	164g

UNIT:MM

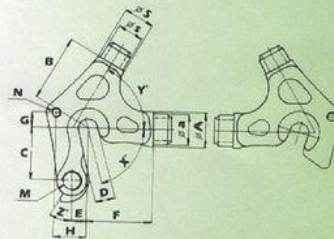

M.T.B. DROPOUT

MODEL	LR400M
$\varnothing A$	19
$\varnothing B$	17
$\varnothing C$	16
$\varnothing D$	14
B	36
C	28
D	10
E	8
F	35
G	8
H	17
M	M10x1.0
N	M5x0.8
X	75°
Y	50 51 52 53 54 55 56 57 58 59 60 61 62 63 64 65
Z	28
DEGRESS	5.5 / C.S. 6 48
W.T.	170g



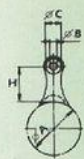

A.T.B CABLE STOP

MODEL	LA41C
∅A	25.4
∅B	3
∅C	6.7
H	16
W.T	13g

UNIT:MM

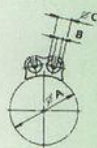

A.T.B CABLE STOP

MODEL	LA42C-1
∅A	31.8
B	2.3
∅C	6.3
W.T	8g

UNIT:MM

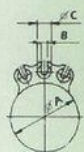

A.T.B CABLE STOP

MODEL	LA43C-1
∅A	31.8
B	2.3
∅C	6.3
W.T	12g

UNIT:MM

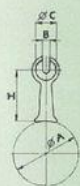

A.T.B CABLE STOP

MODEL	LA51C
∅A	19
B	2.3
∅C	5.8
W.T	4g

UNIT:MM

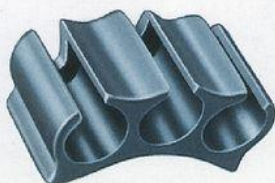

A.T.B CABLE STOP

MODEL	LA53C
∅A	28.6
B	2.3
∅C	5.8
W.T	6g

UNIT:MM



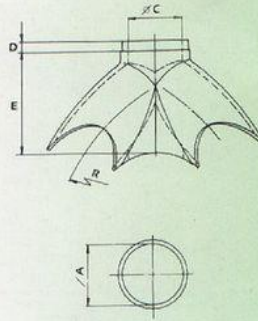

A.T.B. FORK CROWN

MODEL	LC10
∅A	28.6
∅C	25.4
D	5
E	44
R	100
W.T.	130g

UNIT:MM

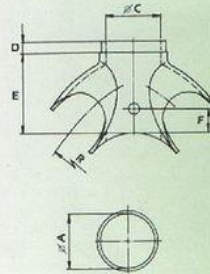
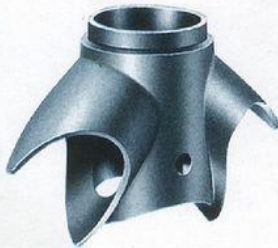

A.T.B. FORK CROWN

MODEL	LC11
∅A	25.4
∅C	25.4
D	5
E	36.5
F	10.5
R	80
W.T.	80g

UNIT:MM

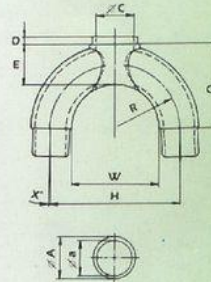

A.T.B. FORK CROWN

MODEL	LC12
∅A	28.6
∅a	26.2
∅C	28.6
D	5.5
E	28.5
G	60
H	91.7
R	45.85
W	63
X°	1° 45'
DEGREES	6°
W T	280g

UNIT:MM

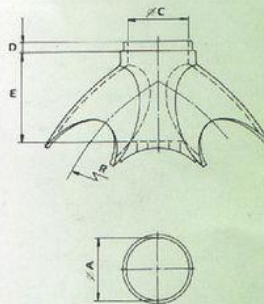

A.T.B. FORK CROWN

MODEL	LC13
∅A	28.6
∅C	28.6
D	5
E	41
R	100
W T	130g

UNIT:MM



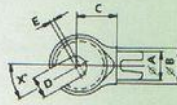

A.T.B. FRONT FORK TIP

MODEL	LE01
∅A	13
∅B	17.2
C	18.7
D	10
E	2
X°	30°
DEGREES	4°
W.T	70g

UNIT:MM

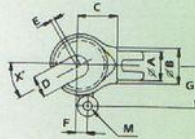

A.T.B. FRONT FORK TIP

MODEL	LE01-1
∅A	13
∅B	17.2
C	18.7
D	10
E	2
F	5.5
G	19
M	M5x0.8
X°	30°
DEGREES	4°
W.T.	75g

UNIT:MM

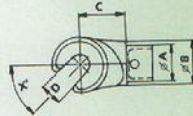

A.T.B. FRONT FORK TIP

MODEL	LE04
∅A	16.3
∅B	20.4
C	22
D	10
X°	45°
ECCENTRIC	4.25
W.T.	85g

UNIT:MM

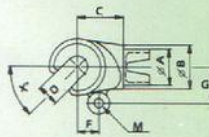

A.T.B. FRONT FORK TIP

MODEL	LE04-1
∅A	16.3
∅B	20.4
C	22
D	10
F	10
G	17
M	M5x0.8
X°	45°
ECCENTRIC	4.25
W.T.	90g

UNIT:MM

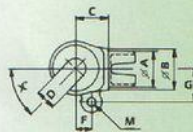

A.T.B. FRONT FORK TIP

MODEL	LE06-1
∅A	16.3
∅B	20
C	15
D	9
F	7
G	15.5
M	M5x0.8
X°	45°
ECCENTRIC	4.25
W.T	67g

UNIT:MM



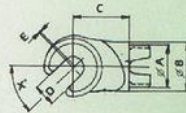

A.T.B. FRONT FORK TIP

MODEL	LE07
∅A	20.2
∅B	23.2
C	25.7
D	10
E	1
F	14.7
G	16
X°	45°
ECCENTRIC	4.85
W.T	100g

UNIT:MM

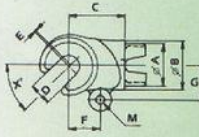

A.T.B. FRONT FORK TIP

MODEL	LE07-1
∅A	20.2
∅B	23.2
C	25.7
D	10
E	1
F	14.7
G	16
M	M5x0.8
X°	45°
ECCENTRIC	4.85
W.T	110g

UNIT:MM

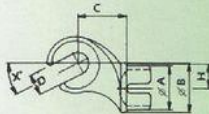
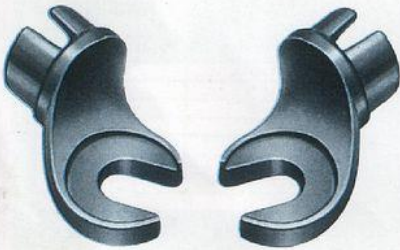

A.T.B. FRONT FORK TIP

MODEL	LE08
∅A	20.2
∅B	23.2
C	24
D	10
H	11
X°	27°
DEGREES	1° 30'
ECCENTRIC	3.25°
W.T	85g

UNIT:MM

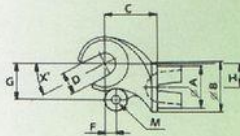

A.T.B. FRONT FORK TIP

MODEL	LE08-1
∅A	20.2
∅B	23.2
C	24
D	10
F	5
G	16.5
H	11
M	M5x0.8
X°	27°
DEGREES	1° 50'
ECCENTRIC	3.25
W.T	105g

UNIT:MM

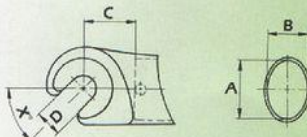

MODEL	LE10
A	21
B	15.24
C	19
D	10
X°	45°
DEGREES	1° 30'
ECCENTRIC	2.25
W.T	78g

UNIT:MM



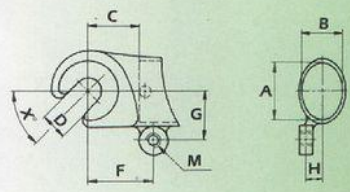

MODEL	LE10-1
A	21
B	15.24
C	19
D	10
F	23
G	17.1
H	6.4
M	M5x0.8
X°	45°
DEGREES	1° 30'
ECCENTRIC	2.25
W.T.	85g

UNIT:MM

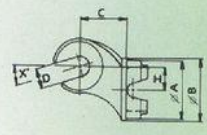

A.T.B. FRONT FORK TIP

MODEL	LE13
∅A	26.2
∅B	28.6
C	22
D	9.3
H	10.5
X°	17°
ECCENTRIC	8
W.T.	100g

UNIT:MM

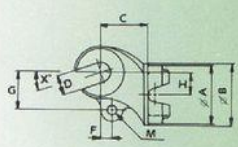

A.T.B. FRONT FORK TIP

MODEL	LE13-1
∅A	26.2
∅B	28.6
C	22
D	9.3
F	5
G	18
H	10.5
M	M5x0.8
X°	17°
ECCENTRIC	8
W.T.	110g

UNIT:MM

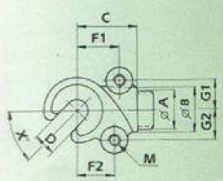
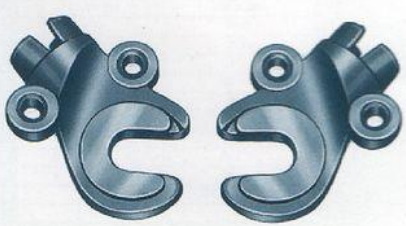

MODEL	LE14-2
∅A	15.9
∅B	18
C	25
D	9
F1	18
F2	15
G1	12
G2	12
M	M5x0.8
X°	45°
DEGREES	2° 30'
ECCENTRIC	2.25
W.T.	90g

UNIT:MM



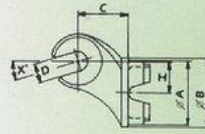

A.T.B. FRONT FORK TIP

MODEL	LE15
∅A	29.4
∅B	31.8
C	23
D	10
H	14.3
X*	17*
ECCENTRIC	9.5
W.T	110g

UNIT:MM

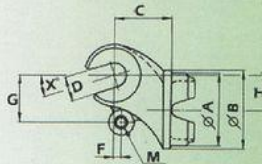

A.T.B. FRONT FORK TIP

MODEL	LE15-1
∅A	29.4
∅B	31.8
C	23
D	10
F	3
G	19
H	14.3
M	M5x0.8
X*	17*
ECCENTRIC	9.5
W.T.	120g

UNIT:MM

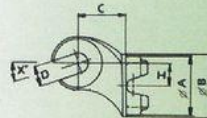

A.T.B. FRONT FORK TIP

MODEL	LE16
∅A	23
∅B	25.4
C	22
D	9.5
F	5
G	18
H	10.5
X*	17*
ECCENTRIC	8
W.T	75g

UNIT:MM

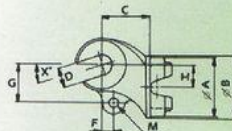

A.T.B. FRONT FORK TIP

MODEL	LE16-1
∅A	23
∅B	25.4
C	22
D	9.5
F	5
G	18
H	10.5
M	M5x0.8
X*	17*
ECCENTRIC	8
W.T	85g

UNIT:MM



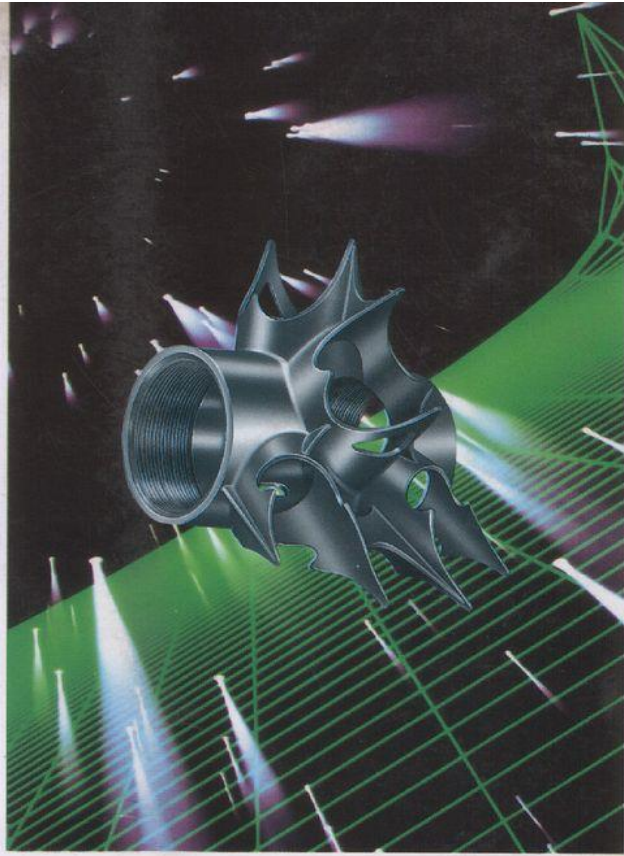

■ INVESTMENT CASTING LOST WAX ■



**LONG SHEN CO., LTD.**

NO. 1. YOW 7 RD., 43712 TACHIA, TAICHUNG HSIEN, TAIWAN, R.O.C.

TEL:04-6816131-2, FAX:04-6815810