

MINUTERIA PER TELAI INOX

**SMALL PARTS FOR STAINLESS
STEEL FRAME**

INOX

SPECIALE PER FAT BIKE



BUSSOLA MOVIMENTO - BB SHELL
INOX 316

CON FILETTO - W/THREAD
BSA 1,37x24T R.L.
Peso/Weight : 125 gr.

Cod. IXBB-BSA



BUSSOLA MOVIMENTO - BB SHELL
INOX 316

CON FILETTO - W/THREAD -
BSA 1,37x24T R.L.
Peso/Weight : 187 gr.

Cod. IXBB-BSA-L100



PONTICELLO FRENO
BRAKE BRIDGE
INOX

Peso/Weight : 32 gr.

Cod. IXPFB



FERMAGUAINA
CABLE STOPPER
INOX

Peso/Weight : 1 gr.

Cod. IXFE1



ATTACCO E.P.
E.P. SUPPORT
INOX

Peso/Weight : 3 gr.

Cod. IXAP180



ATTACCO E.P.+V.R.N
E.P. SUPPORT +V.R.N
INOX

Peso/Weight : 6 gr.

Cod. IXAP1



RINFORZO BUSSOLA BORRACCIA
REINFORCE FOR BOTTLE BOSS
INOX

Peso/Weight : 0,5 gr.

Cod. IXRBB



BUSSOLE PORRACCIA
BOTTLE BOSS
INOX

Peso/Weight : 1 gr.

Cod. IXBB



PASSACAVO IDRAULICO RIVETTO
HYDRAULIC CABLE GUIDE RIVET
INOX

Peso/Weight : 3 gr.

Cod. IX1F-DK-R



PASSACAVO IDRAULICO SILDARE
HYDRAULIC CABLE GUIDE SADDLE
INOX

Peso/Weight : 4 gr.

Cod. IX1F-DK-S



INOX

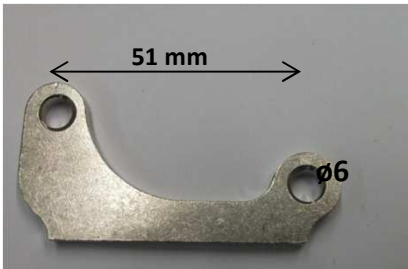

ATTACCO DISCO
DISK BRAKE BOSS

INOX

Peso/Weight : 32 gr.

Cod. IXP-DK1



TUBO PER GUAINA IN OTTONE
BRASS TUBE FOR CABLE GUIDE

OTTONE - BRASS

Ø6x7x500 mm

PESO/Weight : 45 gr.

Cod. TG-T



RINFORZO PASSAGGIO INTERNO Ø7
REINFORCE FOR INNERCABLE Ø7

INOX

SI FORNISCE TUBO Ø6x7 (Pag.148)

SUPPLY TUBE Ø6x7 TOO (Pag.148)

Peso/Weight : 28 gr.

Cod. IXRIN-7



TUBO IN CARBONIO PER PASSAGGIO GUAINA
ALL'INTERNO DEL TELAIO

CARBON TUBE FOR CABLE GUIDE INSIDE THE
FRAME

Øi 5,5 x 500 mm

Peso/Weight : 10 gr.

Cod. TG-CAR55

RINFORZO ELT – REINFORCE ELT

RINFORZO INOX PER SEDE OVALE FERMA GUAINA MULTIFUNZIONE

Cod. FE-ML-A (Pag. 43).

PER TELAI ACCIAIO INOX O CROMOLY

STAINLESS STEEL REINFORCE FOR OVAL SLOT OF MULTIFUNCTION

CABLE STOPPER Cod. FE-ML-A (Pag. 43) .

FOR STEEL OR CROMOLY FRAME

Peso/Weight : 1,5 gr.

Cod. IXRIN-ELT



RINFORZO **INOX**
REINFORCE **INOX**

BASE
PART
ALLOY



INOX



DROPOUT INDOOR INOX
FORCELLINO PISTA INOX

FORCELLINO PISTA
DROPOUT INDOOR

INOX

Peso/Weight : 124 gr.

Cod. IXFPF



FORCELLINO PER TIRACATENA
DROPOUT WITH CHAIN TENSIONER
MONOSPEED

INOX

Peso/Weight : 132 gr.

Cod. IXFMS



FORCELLINO POSTERIORE CORSA W37
RACING REAR DROPOUT W37

INOX

Peso/Weight : 121 gr.

Cod. IXW37



W37 IX + ATTACCO DISCO
W37 IX + DISK BRAKE BOSS

INOX

BY REQUEST

Peso/Weight : 160 gr.

Cod. IXW37-DISK

FORCELLINI SCORREVOLI CON ATTACCO DISCO ADATTI PER :

- CATENA o CINGHIA DENTATA
- CAMBI NEL MOZZO TIPO ROHLOFF-SHIMANO

SLIDING DROPOUTS WITH DISK BOSS RIGHT FOR

- CHAIN or TOOTHED BELT
- CHANGE GEAR IN HUB LIKE ROHLOFF-SHIMANO

VEDI Pag. 77/108 – LOOK AT Pag. 77/108

TUTTO/ALL INOX - RANGE 16 mm - PESO/WEIGHT : 369 gr.

Cod. IXFOR-SCR-DK-N



INOX

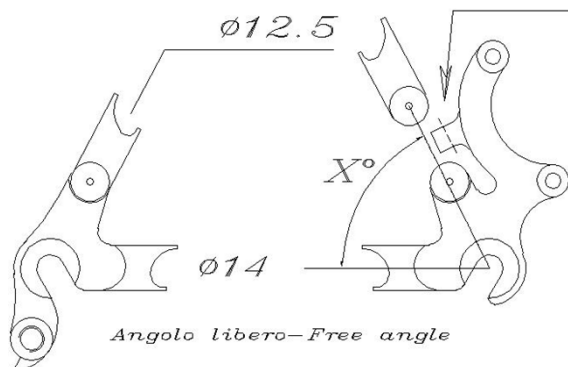

ADATTARE L'APPOCCIO RINFORZO/SNODO
COUPLED CORRECTLY REINFORCE/TIP



FORCELLINO POSTERIORE DISK ACCIAIO – ANGOLO
LIBERO

STEEL REAR DROPOUT DISK – ANGOLO LIBERO

PESO/WEIGHT : 170 gr.

Cod. IXFP-27



INOX



CONGIUNZIONE STERZO SUPERIORE
TOP HEAD LUG
PER DIM VEDI/LOOK PAG 126

INOX

PESO/WEIGHT : 13 gr.

Cod. IXCS76



CONGIUNZIONE STERZO INFERIORE
BOTTOM HEAD LUG
PER DIM VEDI/LOOK PAG 126

INOX

PESO/WEIGHT : 16 gr.

Cod. IXCS86



CONGIUNZIONE SELLA
SEAT LUG
PER DIM VEDI/LOOK PAG 138

INOX

PESO/WEIGHT : 60 gr.

Cod. IXP51



COLLARINO SELLA
SEAT CLAMP

INOX

PER DIM VEDI PAG.136

FOR DIM LOOK PAG 136

Peso/WEIGHT : 28 gr.

Cod. IXBS77



SCATOLA MOVIMENTO
B.B. SHELL

INOX

Filettato – Thread

BSA 1.37x24T R.L.

PESO/WEIGHT : 162 gr.

Cod. IXS35-BSA

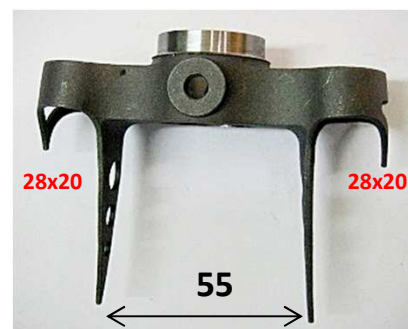

TESTA FORCELLA
FORK CROWN

INOX

CANNOTTO – STEAM ϕ 28,6

BY REQUEST ϕ 25,4

FODERI – BLADE 28x20

PESO/WEIGHT : 146 gr.

Cod. IXB97



FORCELLINO ANTERIORE CORSA
RACING FRONT DROP OUT

INOX

PESO/WEIGHT : 44 gr.

PER DIM VEDI PAG 138

FOR DIM LOOK PAG 138

Cod. IXFA10



DROPOUT FP-11 2 EYEL.
STAINLESS STEEL - INOX

FORCELLINO POSTERIORE CORSA
2 OCCHIELLI

RACING REAR DROPOUT 2 EYELET

INOX

PER DIM VEDI /LOOK PAG.139

PESO/WEIGHT : 111 gr.

Cod. IXFP11-2



INOX

TUBO STERZO INTEGRATI - INTEGRATED HEAD TUBE
TOP 1"1/8 – BOTTOM 1"1/8

INOX

SET=TUBE ϕ 38x200+ TOP AND BOTTOM RINGS
Cod. IXTS45-200



DA TAGLIARE COME VUOI
THAT YOU CUT LIKE YOU WANT



SI FORNISCONO ANCHE LE SERIE STERZO Pag.25
WE SUPPLY HEAD SET TOO Pag.25



INOX



INOX

TUBAZIONI PER STAINLESS STEEL FRAME TUBES

SET TUBE 10 pcs

INOX

Cod. IXST-286

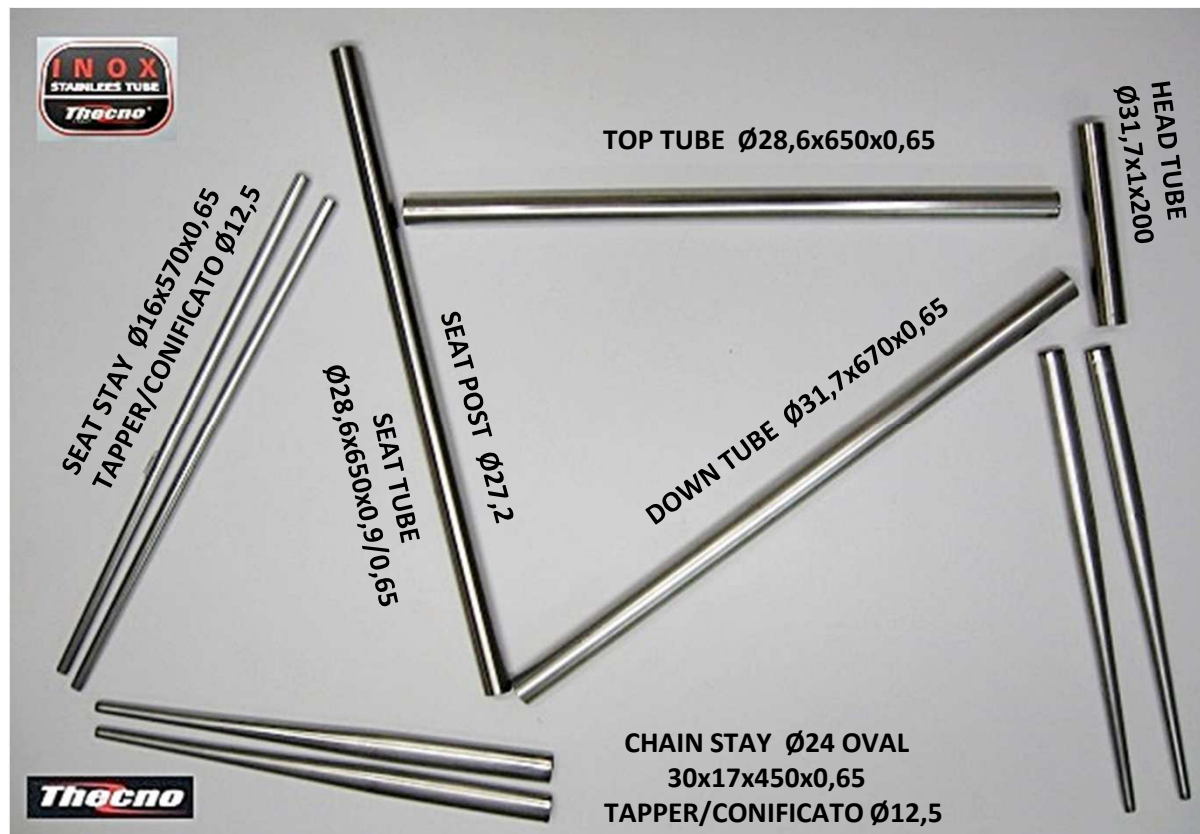

SET TUBE 10 pcs :

1 x HEAD TUBE	2 x SEAT STAY
1 x TOP TUBE	2 x CHAIN STAY
1 x SEAT POST	2 x FORK BLADE
1 x DOWN TUBE	

Materiale : acciaio INOX austenitico senza saldatura multi trafilato a freddo

Material : austenitic STAINLESS STEEL multi-drawing seamless

FODERI / BLADES FOR FORK CROWN INOX

Ø24 OVAL Ø28x20x420mm CONICO/TAPPER Ø12 DB 06/09

Cod. IXFF-28x20

PESO/WEIGHT 1 pz. : 160 gr. - L= 420 mm



INOX

**RACING FRAME AND FORK
WITH LUGS FULL STAINLEES STEEL
EXAMPLE**

INOX FRAME

PESO/WEIGHT FRAME + FORK : 2200 gr.

PESO/WEIGHT FORK : 610 gr.

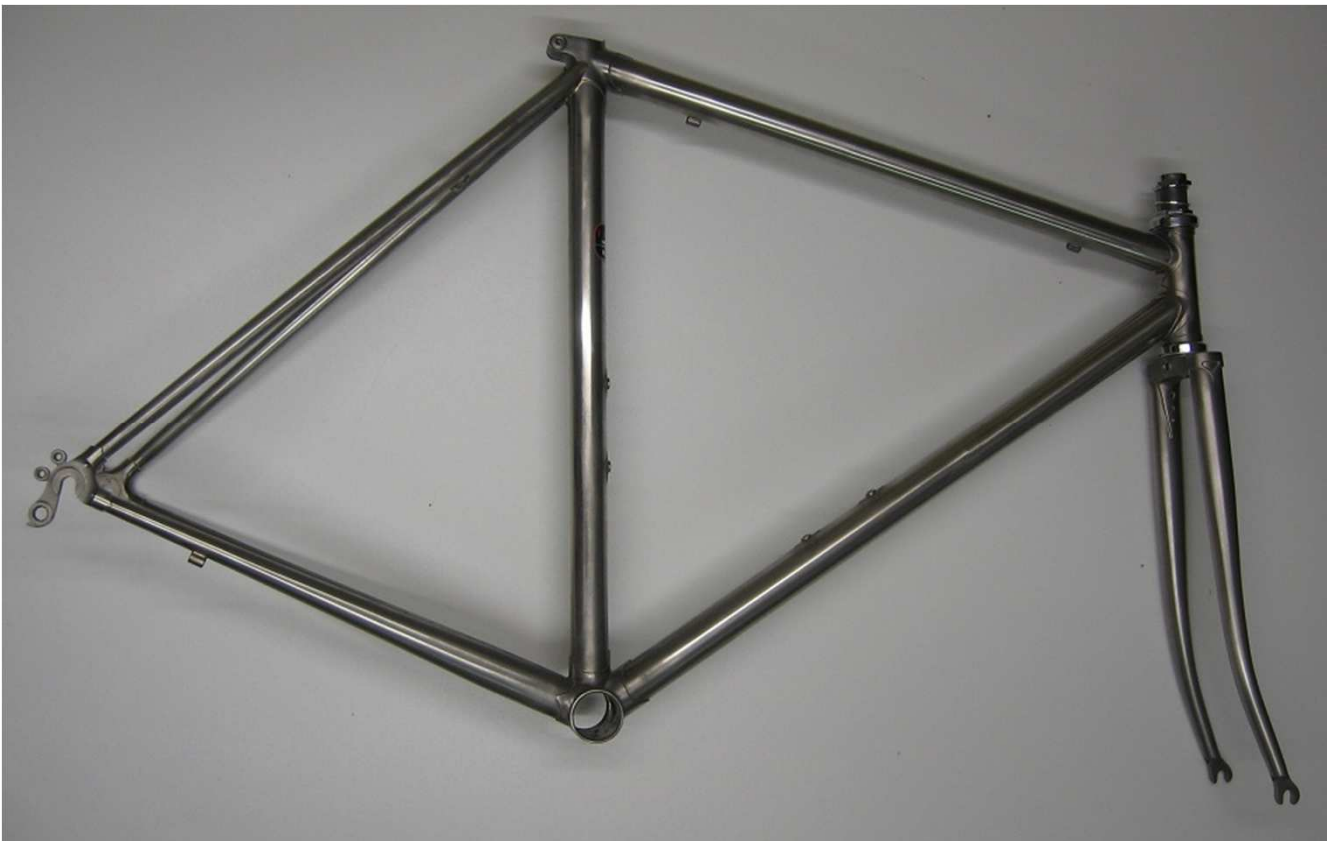

INOX



INOX

**MONOSPEED FRAME AND FORK
TIG WELDING FULL STAINLESS STEEL INTEGRATED HEAD TUBE**

1" 1/8- HEAD SET 45°

EXAMPLE

INOX FRAME



INOX



PARTICOLARI TELAIO PARTICULAR VIEW



INOX



PER FORCELLINI VEDERE Pag. 77/99
FOR DROPOUT LOOK AT Pag. 77/99



A RICHIESTA FORNIAMO SUPPORTO A PONTE PER CAMBIO **PINION** TUTTO **INOX**
PER TELAI **INOX** o **CROMOLY**.

BY REQUEST SUPPLY BRIDGE SUPPORT **PINION** CHANGE GEAR ALL **INOX**
FOR **STAINLESS STEEL** or **CROMOLY** FRAMES.



PROGETTO – PROJECT - “SHIELD”

CONGIUNZIONE STERZO SUPERIORE
TOP HEAD LUG

Ø31,7XØ31,7 AERO “34,6x28,6” x 72° +-10°
PESO/WEIGHT : 13 gr.

Cod. RA2

CONGIUNZIONE SELLA
SEAT LUG

Ø28,6XØ31,7 AERO “34,6x28,6” x 73° +-10°
PESO/WEIGHT : 12 gr.

Cod. RA3

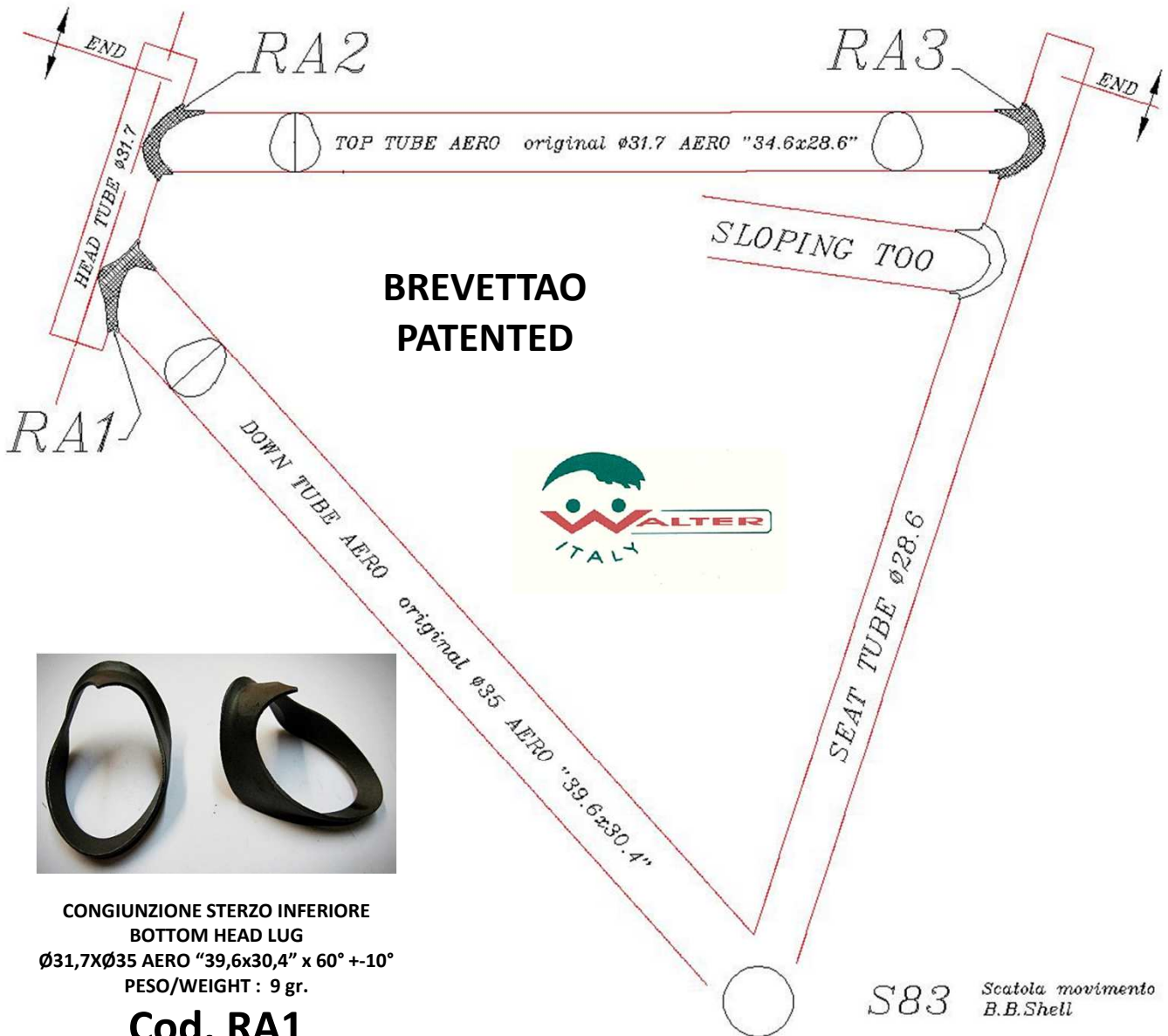

CONGIUNZIONE STERZO INFERIORE
BOTTOM HEAD LUG

Ø31,7XØ35 AERO “39,6x30,4” x 60° +-10°
PESO/WEIGHT : 9 gr.

Cod. RA1



CHE COSA E' IL PROGETTO "SHIELD" ?

SHIELD è una nuova soluzione per unire le tubazioni del telaio, in particolare per quelle di acciaio alta gamma. Il sistema shield consiste in particolari elementi RA1-RA2-RA3 che tramite saldobrasatura uniscono le tubazioni del telaio dando i seguenti vantaggi :

1. Possibilità di variare le geometrie del telaio secondo le ultime tendenze e necessita.
2. Il telaio risulta avere delle performance ottimali.
3. La necessita di realizzare la lavorazione del telaio al meglio, rende il telaio finito particolare e immediatamente riconoscibile come uno dei migliori risultati della tecnologia "made in italy".

WHAT IS "SHIELD" PROJECT ?

SHIELD is new solution to join frame tubes, in particular steel high range ones. Shield system is composed by particular parts RA1-RA2-RA3, through brazing-welding, joins frame tubes with following advantages :

1. the possibility to change frame geometry according the latest trend and need.
2. the frame has perfect performance
3. there is necessity to realize the best frame working : for this reason the finished frame is very particular and immediately represent the highest technology "made in italy".

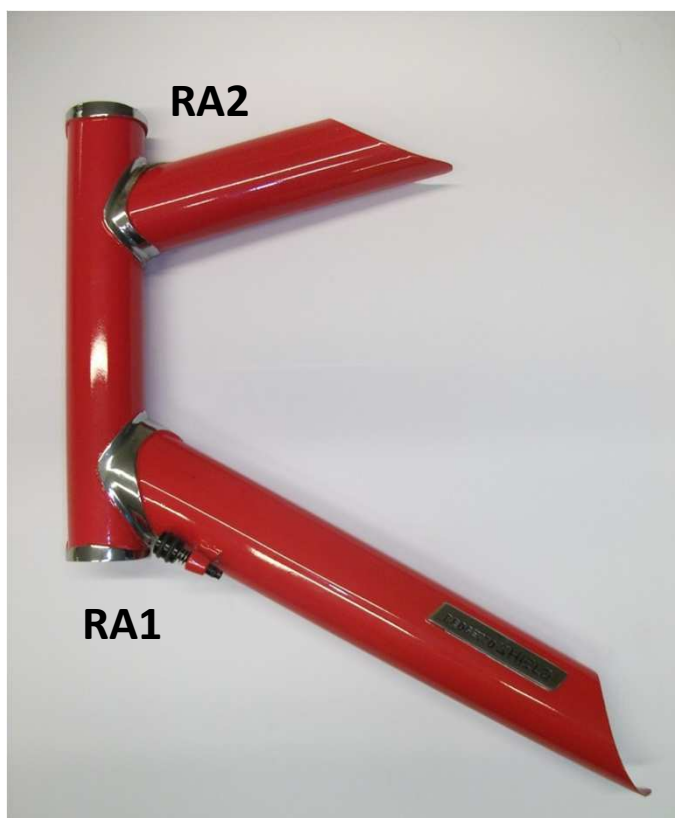

CONGIUNZIONE STERZO SUPERIORE - TOP HEAD LUG

Ø31,7XØ31,7 AERO "34,6x28,6" x 72° +-10°

PESO/WEIGHT : 13 gr.

Cod. RA2

CONGIUNZIONE STERZO INFERIORE - BOTTOM HEAD LUG

Ø31,7XØ35 AERO "39,6x30,4" x 60° +-10°

PESO/WEIGHT : 9 gr.

Cod. RA1

CONGIUNZIONE SELLA - SEAT LUG

Ø28,6XØ31,7 AERO "34,6x28,6" x 73° +-10°

PESO/WEIGHT : 12 gr.

Cod. RA3



TESTE FORCELLA MICROFUSE ACCIAIO STEEL FORK CROWN LOST WAX CASTING

A richiesta forniamo fodero forcella cromoly (pag.116)
By request we supply cromoly fork blade (pag.116)



FODERI - BLADE
Forma a D origine $\varnothing 24$
D shape origin from $\varnothing 24$

**TESTA FORCELLA
FORK CROWN**
CANNOTTO - STEM $\varnothing 25,4$
FODERI - BLADE
Forma a D origine $\varnothing 24$
D shape origin from $\varnothing 24$
PESO/WEIGHT : 175 gr.

Cod. B11

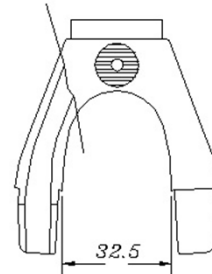
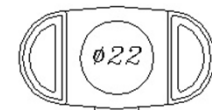

FODERO FORCELLA

FORK BLADE

Forma a D origine $\varnothing 24$

D shape origin from $\varnothing 24$

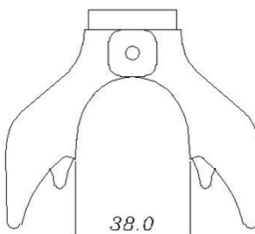

**TESTA FORCELLA
FORK CROWN**
CANNOTTO - STEM $\varnothing 25,4$
FODERI - BLADE 28x20
PESO/WEIGHT : 140 gr.

Cod. B14N





TESTA FORCELLA
 FORK CROWN
 PISTA IMDOOR
 CANNOTTO – STEM $\phi 25,4$
 FODERI – BLADE $\phi 24$
 PESO/WEIGHT : 110 gr.

Cod. B19L

A richiesta forniamo fodero forcella cromoly $\phi 24$ (pag.116)
 By request we supply fork cromoly blade $\phi 24$ (pag.116)

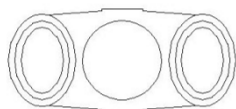
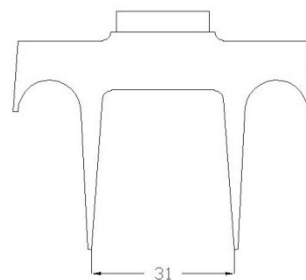
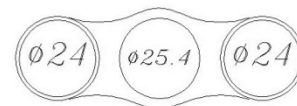

Fodero forcella – Fork blade 28x20

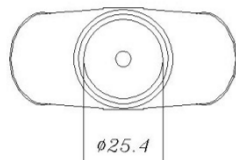
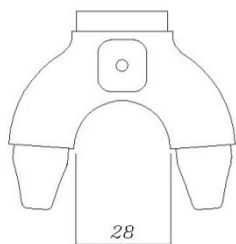

TESTA FORCELLA
 FORK CROWN
 CANNOTTO – STEM $\phi 25,4$
 FODERI – BLADE 28x20
 PESO/WEIGHT : 145 gr.

Cod. B20L



TESTA FORCELLA
 FORK CROWN
 CANNOTTO – STEM $\phi 25,4$
 FODERI – BLADE 28x20
 PESO/WEIGHT : 175 gr.

Cod. B21N
BY REQUEST
NO IN STOCK



Fodero forcella – Fork blade 28x20

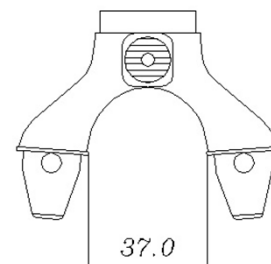



TESTA FORCELLA
 FORK CROWN
 PISTA INDOOR
 CANNOTTO – STEM $\varnothing 25,4$
 FODERI – BLADE OVERSIZE 30,5x21,5
 PESO/WEIGHT : 130 gr.
Cod. B26

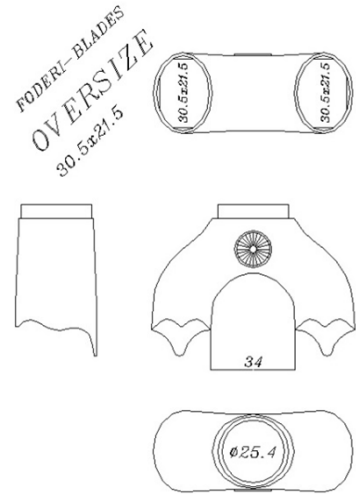

A RICHIESTA CON SEDE CANNOTTO PASSANTE (Cod. B27)
 BY REQUEST WITH BOSS OF STEM THROUGH (Cod. B27)



TESTA FORCELLA
 FORK CROWN
 CANNOTTO – STEM $\varnothing 28,6$
 FODERI – BLADE MAX AERO 35,8x18,5
 PESO/WEIGHT : 144 gr.
Cod. B36L

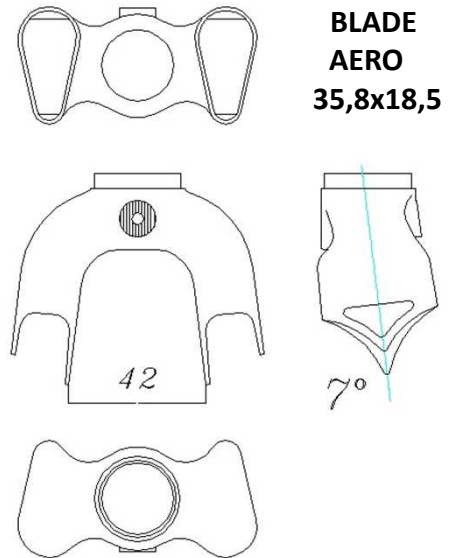

Fodero – blade
 MAX
 AERO 35,8x18,5

Forniamo fodero forcella cromoly (pag.116)
 We supply fork cromoly blade (pag.116)

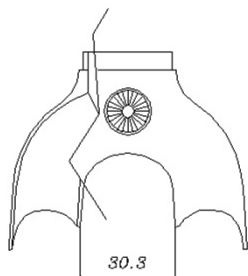
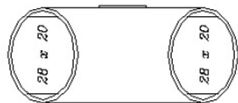

TESTA FORCELLA
 FORK CROWN
 CANNOTTO – STEM $\varnothing 25,4$
 FODERI – BLADE 28x20
 PESO/WEIGHT : 118 gr.

Cod. B41
BY REQUEST
NO IN STOCK





TESTA FORCELLA
 FORK CROWN
 CANNOTTO – STEM $\phi 25,4$
 FODERI – BLADE 28x20
 PESO/WEIGHT : 128 gr.
Cod. B43

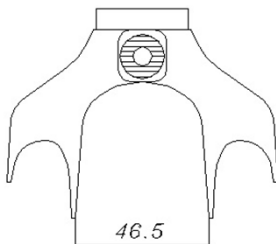
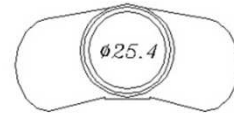
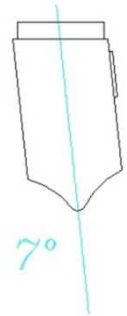
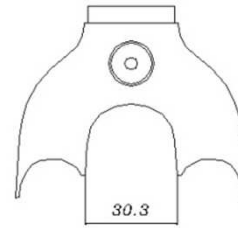
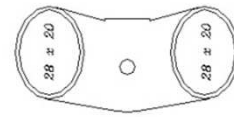

TESTA FORCELLA
 FORK CROWN
 CANNOTTO – STEM $\phi 25,4$
 FODERI – BLADE 28x20
 PESO/WEIGHT : 150 gr.
Cod. B53



STEM $\phi 25,4$
 TESTA FORCELLA
 FORK CROWN
 FODERI – BLADE
 28x20
 PESO/WEIGHT : 246 gr.
Cod. B70



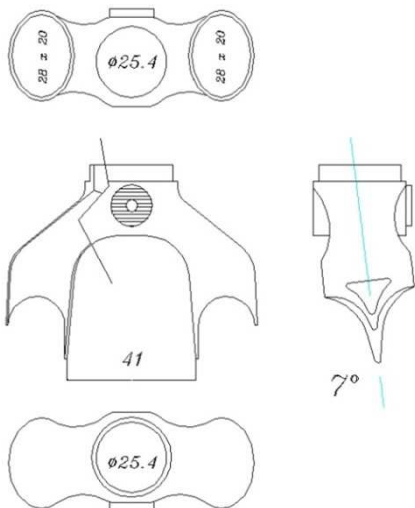

TESTA FORCELLA
 FORK CROWN
 CANNOTTO – STEM $\phi 25,4$
 FODERI – BLADE 28x20
 PESO/WEIGHT : 116 gr.

Cod. B81L

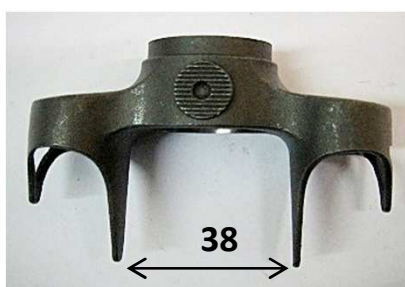

TESTA FORCELLA
 FORK CROWN
 CANNOTTO – STEM $\phi 25,4$
 FODERI – BLADE 28x20
 PESO/WEIGHT : 93 gr.

Cod. B95

**BY REQUEST
 NO IN STOCK**

TESTA FORCELLA
 FORK CROWN
 CANNOTTO – STEM $\phi 28,6$
 FODERI – BLADE 28x20
 PESO/WEIGHT : 146 gr.

Cod. B97-286

STANDARD

TESTA FORCELLA
 FORK CROWN
 CANNOTTO – STEM $\phi 25,4$
 FODERI – BLADE 28x20
 PESO/WEIGHT : 146 gr.

Cod. B97-254

BY REQUEST

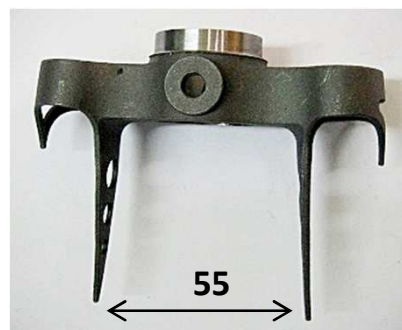

CANNOTTI FORCELLA – FORK STEM - STEEL



Ø 25,4xØ22,2xØ19x320 DB - SF - 350 gr. - Cod. CAN1-320SF
 Ø 28,6xØ25,4xØ23,2x320 DB - SF - 380 gr. - Cod. CAN8-320SF
 Ø 25,4xØ22,2xØ19x400 DB - SF - gr. - Cod. CAN1-400SF
 Ø 28,6xØ25,4xØ23,2x400 DB - SF - gr. - Cod. CAN8-400SF

 Ø 25,4xØ22,2xØ19x190 DB - FILL - 220 gr. - Cod. CAN1-190F
 Ø 25,4xØ22,2xØ19x235 DB - FILL - 270 gr. - Cod. CAN1-235F
 Ø 25,4xØ22,2xØ19x250 DB - FILL - 280 gr. - Cod. CAN1-250F

DB = CANNOTTO A DOPPIO SPESSORE
 STEM DOUBLE BUTTED
 SF = SENZA FILETTO / WITHOUT THREAD
 FILL = FILETTATO / WITH THREAD

FODERI FORCELLA / FORK BLADES CROMOLY

Cod. FF-MX

PESO/WEIGHT 1 pz. : 190 gr. - L= 405 mm

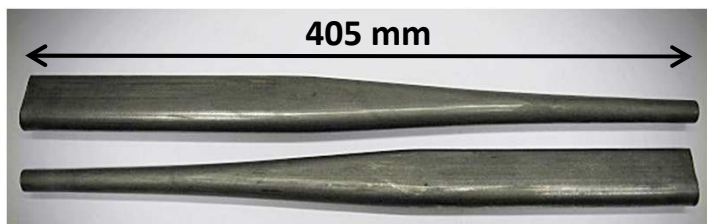

AERO 35,8x18,8
FOR
B36L (Pag.113)



FODERI FORCELLA / FORK BLADES CROMOLY

Ø24x420 CONICO/TAPPER Ø12 DB 06/09 - Cod. FF-24

PESO/WEIGHT 1 pz. : 160 gr. - L= 420 mm

420 mm



Ø24

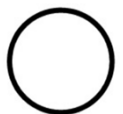

FODERI FORCELLA / FORK BLADES CROMOLY

Ø24 OVAL Ø28x20x420 CONICO/TAPPER Ø12 DB 06/09 - Cod. FF-28x20

PESO/WEIGHT 1 pz. : 160 gr. - L= 420 mm

420 mm



Ø28x20

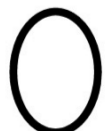

TUBAZIONI PER TELAI IN ACCIAIO

SET TUBE 8 pcs

CROMOLY

Cod. ST-254

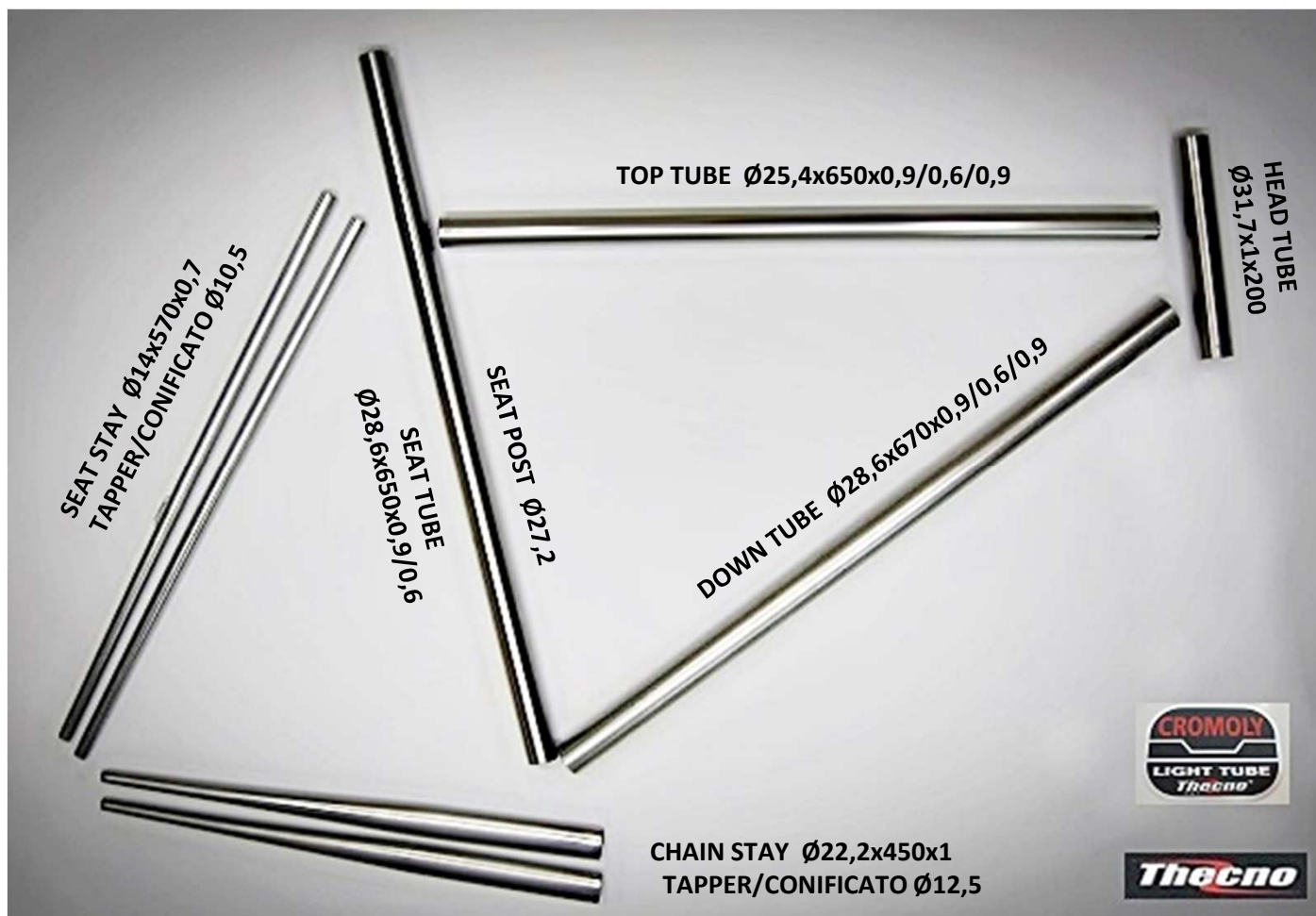

SET TUBE 8 pcs :

1. HEAD TUBE
2. TOP TUBE
3. SEAT POST
4. DOWN TUBE
5. SEAT STAY
6. SEAT STAY
7. CHAIN STAY
8. CHAIN STAY



FODERI FORCELLA NON INCLUSI NEL SET 8 pcs - PER I FODERI FORCELLA VEDI Pag.116
FORK BLADES NOT INCLUDED IN 8pcs SET. - FOR FORK BLADES LOOK AT Pag.8116



TUBAZIONI PER TELAI IN ACCIAIO

SET TUBE 8 pcs

CROMOLY

Cod. ST-286

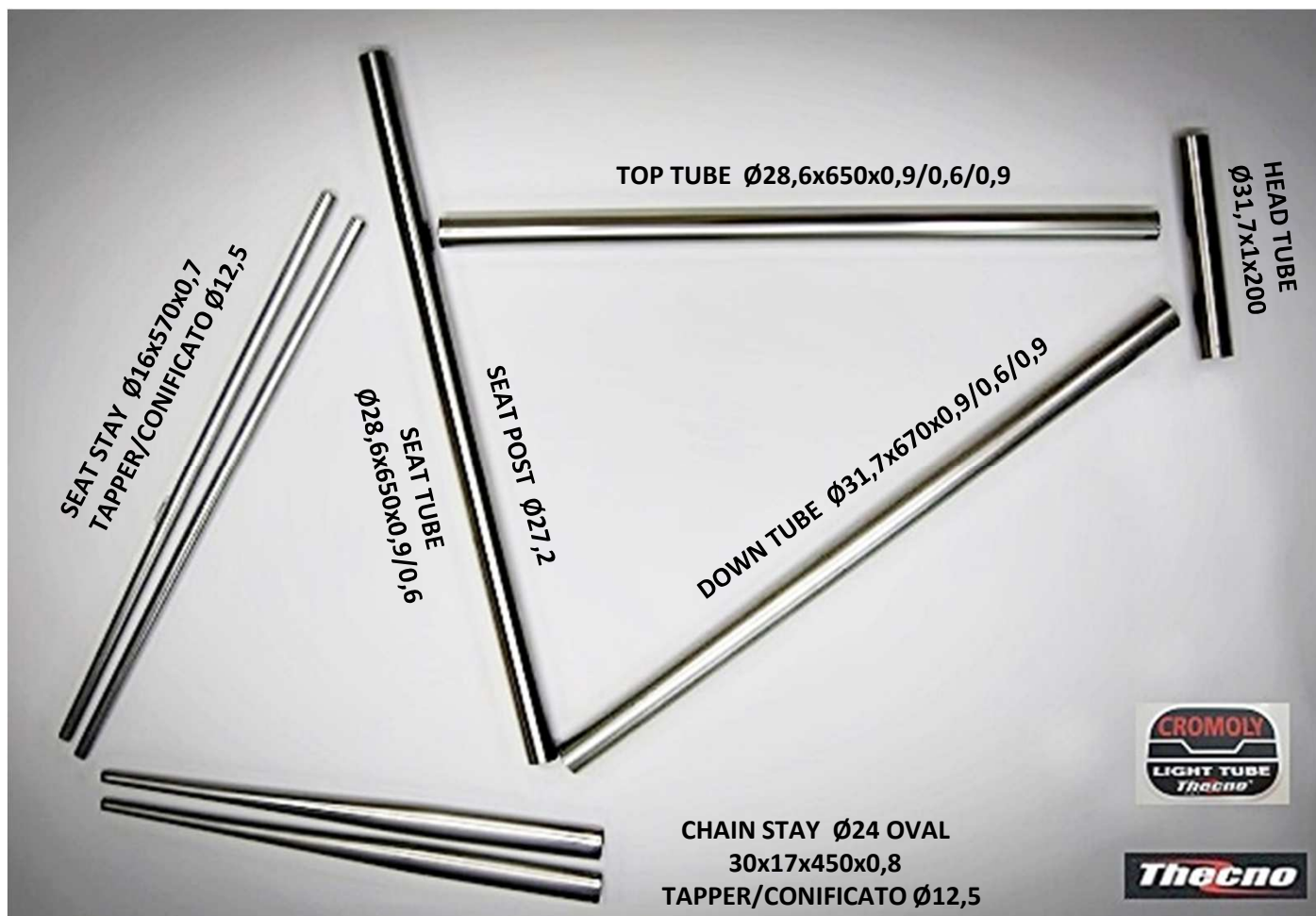

SET TUBE 8 pcs :

1. HEAD TUBE
2. TOP TUBE
3. SEAT POST
4. DOWN TUBE
5. SEAT STAY
6. SEAT STAY
7. CHAIN STAY
8. CHAIN STAY



FODERI FORCELLA NON INCLUSI NEL SET 8 pcs - PER I FODERI FORCELLA VEDI Pag.116
FORK BLADES NOT INCLUDED IN 8pcs SET. - FOR FORK BLADES LOOK AT Pag.116





**SCATOLA MOVIMENTO
B.B. SHELL**

Filettato – Thread

ITA 36x24T D.D.

Cod. S04-ITA

OR

BSA 1.37x24T R.L.

Cod. S04-BSA

PESO/WEIGHT : 118 gr.

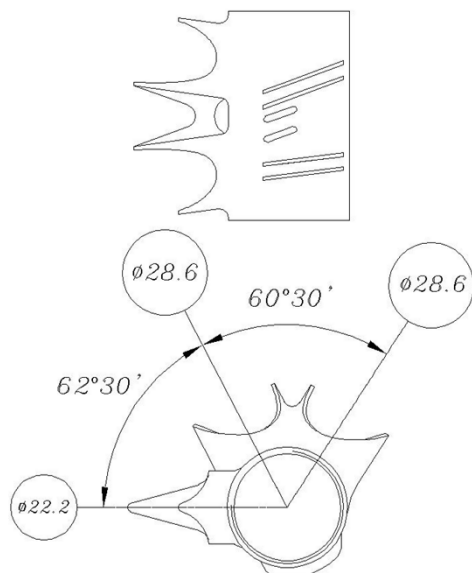
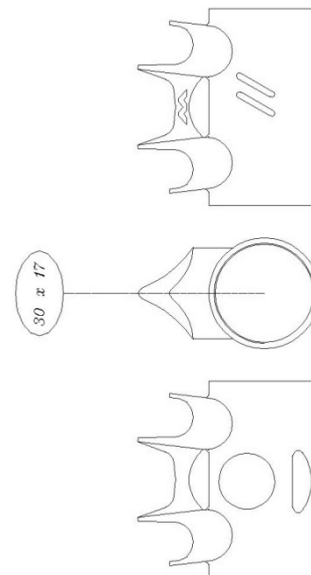

**SCATOLA MOVIMENTO
B.B. SHELL**

Filettato – Thread

ITA 36x24T D.D.

Cod. S48-ITA

OR

BSA 1.37x24T R.L.

Cod. S48-BSA

PESO/WEIGHT : 155 gr.



**BY REQUEST
NO IN STOCK**

**SCATOLA MOVIMENTO
B.B. SHELL**

Filettato – Thread

ITA 36x24T D.D.

Cod. S13-ITA

OR

BSA 1.37x24T R.L.

Cod. S13-BSA

PESO/WEIGHT : 145 gr.

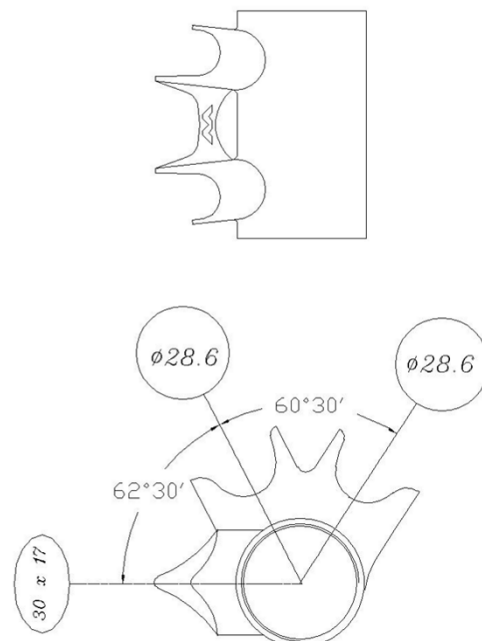



**BY REQUEST
NO IN STOCK**

**SCATOLA MOVIMENTO
B.B. SHELL**

Filettato – Thread

ITA 36x24T D.D.

Cod. S50-ITA

OR

BSA 1.37x24T R.L.

Cod. S50-BSA

PESO/WEIGHT : 155 gr.

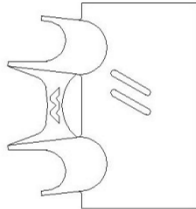
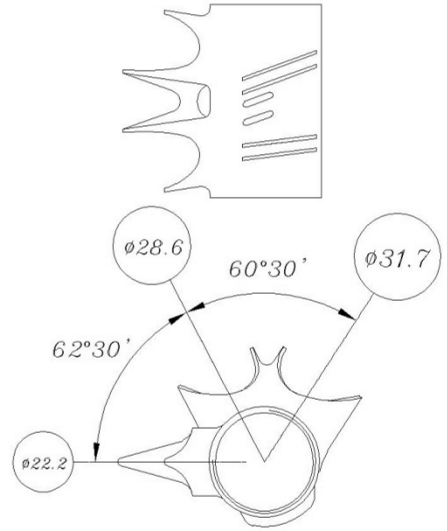

**SCATOLA MOVIMENTO
B.B. SHELL**

Filettato – Thread

ITA 36x24T D.D.

Cod. S35-ITA

OR

BSA 1.37x24T R.L.

Cod. S35-BSA

PESO/WEIGHT : 145 gr.

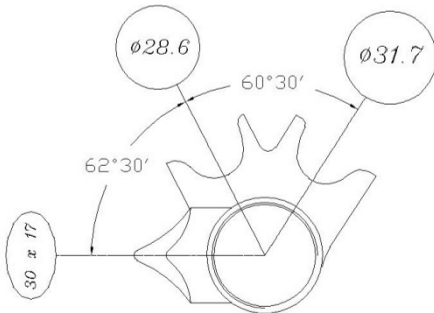

**SCATOLA MOVIMENTO
B.B. SHELL**

Filettato – Thread
ITA 36x24T D.D.

Cod. S60-ITA

OR

BSA 1.37x24T R.L.

Cod. S60-BSA

PESO/WEIGHT : 150 gr.

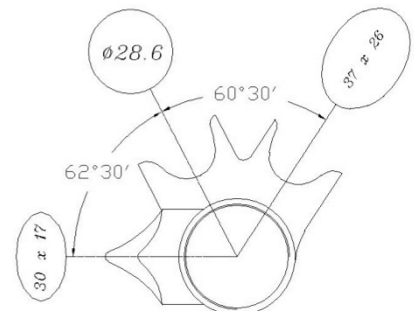
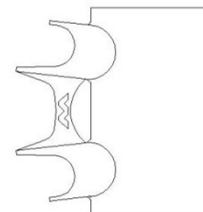



**SCATOLA MOVIMENTO
B.B. SHELL**

Filettato – Thread
ITA 36x24T D.D.

PESO/WEIGHT : 150 gr.
Cod. S80-ITA

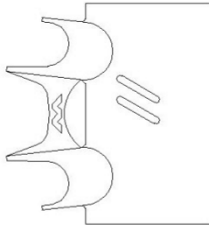
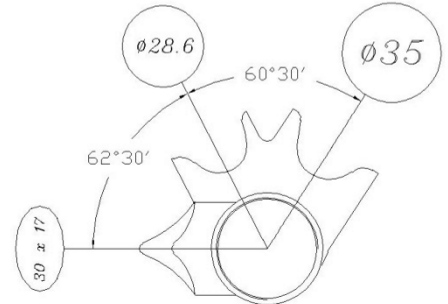
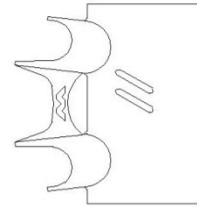

**SCATOLA MOVIMENTO
B.B. SHELL**

Filettato – Thread

ITA 36x24T D.D.

Cod. S83-ITA

OR
BSA 1.37x24T R.L.

Cod. S83-BSA

PESO/WEIGHT : 120 gr.

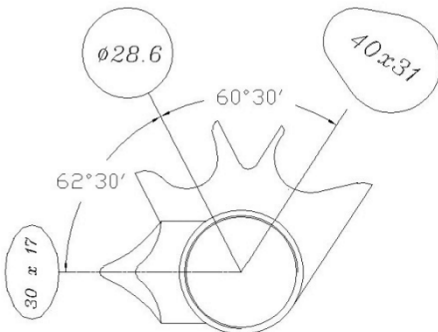

**SCATOLA MOVIMENTO
B.B. SHELL**

Filettato – Thread
ITA 36x24T D.D.

PESO/WEIGHT : 130 gr.

Cod. S86-ITA

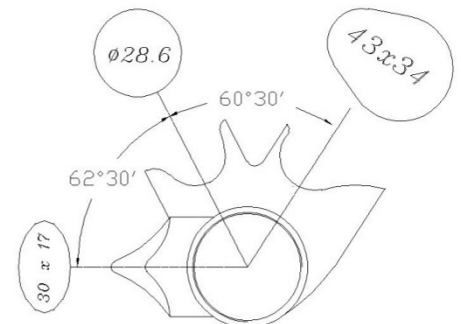
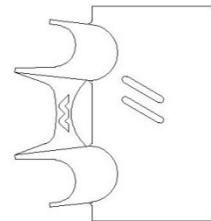



32x16 mm

**SCATOLA MOVIMENTO
B.B. SHELL**

Filettato – Thread

ITA 36x24T D.D.

Cod. S99-ITA

OR

BSA 1.37x24T R.L.

Cod. S99-BSA

PESO/WEIGHT : 146 gr.

**SPECIALE PER POSTERIORI
ORIZZONTALI 32x16 IN CARBONIO DA
INCOLLARE (Pag. 69/70)**

**ESPECIALLY FOR CARBON CHAINSTAY
FIXED BY GLUE (Pag.69/70)**





**BUSSOLA MOVIMENTO CROMOLY
BB SHELL STEEL CROMOLY**

Filettato – Thread ITA 36x24T D.D.
PESO/WEIGHT : 128 gr.

Cod. BB-ITA-CRMO

Filettato – Thread BSA 1.37x24T R.L.
PESO/WEIGHT : 124 gr.

Cod. BB-BSA-CRMO



**BUSSOLA MOVIMENTO ACCIAIO
BB SHELL STEEL**

Filettato – Thread ITA 36x24T D.D.
PESO/WEIGHT : 155 gr.

Cod. BB-ITA-ACC

Filettato – Thread BSA 1.37x24T R.L.
PESO/WEIGHT : 150 gr.

Cod. BB-BSA-ACC



**BUSSOLA MOVIMENTO CROMOLY
BB SHELL CROMOLY**

BB-30 SYSTEM

øi 42 x øe 45 x 68

STANDARD LENGTH - 68 mm
PESO/WEIGHT : 158 gr.

Cod. BB-30-ACC

**BUSSOLA MOVIMENTO TANDEM BSA ESPANSIBILE
BOTTOM BRACKET TANDEM BSA EXPANSIBLE**



bussola alloy ø55x68 mm
Filetto BSA x 68 eccentrico – range 14 mm
alloy bottom bracket ø55x68 mm
Eccentric thread BSA x 68 – range 14 mm
PESO/WEIGHT : 190 gr.

Cod. BB-TANDEM

A RICHIESTA LUNGHEZZA 73 mm
BY REQUEST LENGTH 73 mm



ANELLI ADATTATORI DA FILETTATO ITA a BSA ADAPTER RINGS FROM ITA to BSA THREAD

Anelli da utilizzare per trasformazione di filettature ITA in BSA e per riparazioni di filettature BSA.
Da incollare o da saldare – materiale : acciaio – set 2 pz DEX + SIN - PESO : 7 gr.

Rings for changing thread ITA in to BSA and for repairing thread BSA.
To glue or weld – material : steel – set 2 pz R + L - WEIGHT : 7 gr.

Cod. ANELL-F



Articolo venduto con istruzioni d'uso
Item sold with instructions

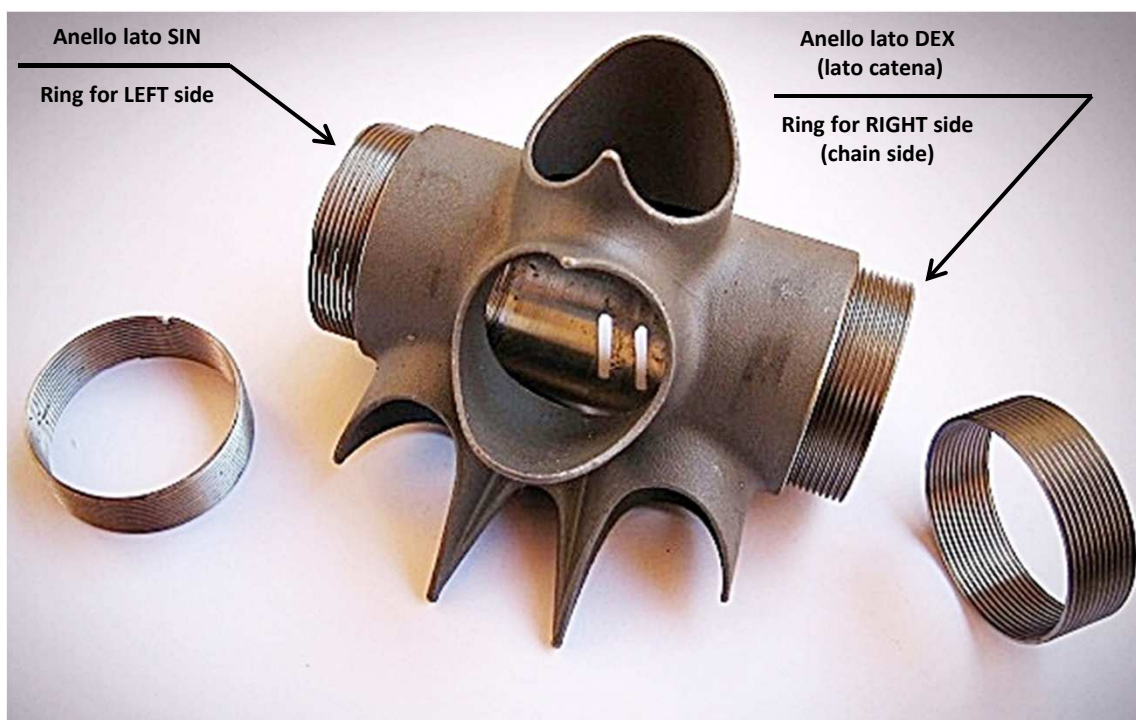

PER LA COLLA VEDI Cod.RDP 490 - PAG.74
FOR GLUE LOOK AT Cod.RDP 490 - PAG.74



CS50

Congiunzione sterzo superiore
Top head lug

Peso-Weight 20 gr.

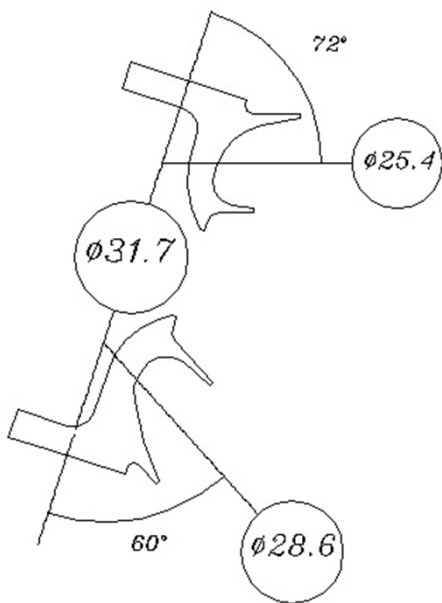

Peso-Weight 24 gr.

Congiunzione sterzo inferiore
Bottom head lug

CS40

CONGIUNZIONE STERZO SUPERIORE
TOP HEAD LUG
 $\varnothing 31,7 \times \varnothing 25,4 \times 72^\circ$
PESO/WEIGHT : 20 gr.

Cod. CS50



CONGIUNZIONE STERZO INFERIORE
BOTTOM HEAD LUG
 $\varnothing 31,7 \times \varnothing 28,6 \times 60^\circ$
PESO/WEIGHT : 24 gr.

Cod. CS40



CS30

Congiunzione sterzo superiore
Top head lug

Peso-Weight 24 gr.

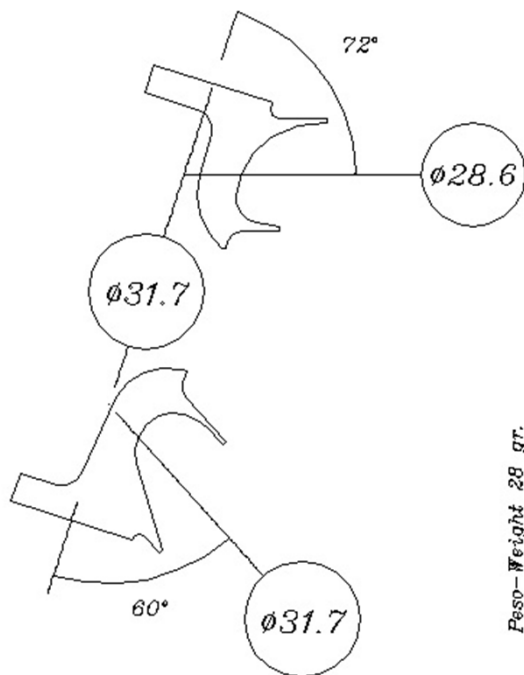

Peso-Weight 28 gr.

Congiunzione sterzo inferiore
Bottom head lug

CS20

CONGIUNZIONE STERZO SUPERIORE
TOP HEAD LUG
 $\varnothing 31,7 \times \varnothing 28,6 \times 72^\circ$
PESO/WEIGHT : 24 gr.

Cod. CS30



CONGIUNZIONE STERZO INFERIORE
BOTTOM HEAD LUG
 $\varnothing 31,7 \times \varnothing 31,7 \times 60^\circ$
PESO/WEIGHT : 28 gr.

Cod. CS20



CS76

Congiunzione sterzo superiore
Top head lug

Peso-Weight 15 gr.

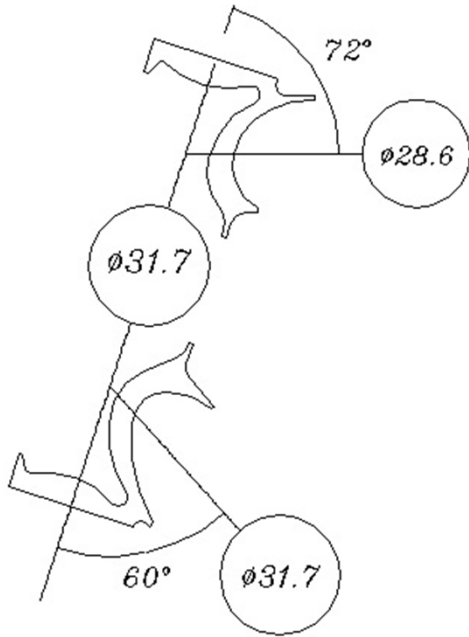

Peso-Weight 19 gr.

Congiunzione sterzo inferiore
Bottom head lug

CS86

COMGIUNZIONE STERZO SUPERIORE

TOP HEAD LUG

$\varnothing 31,7 \times \varnothing 28,6 \times 72^\circ$

PESO/WEIGHT : 15 gr.

Cod. CS76



COMGIUNZIONE STERZO INFERIORE

BOTTOM HEAD LUG

$\varnothing 31,7 \times \varnothing 31,7 \times 60^\circ$

PESO/WEIGHT : 19 gr.

Cod. CS86



Congiunzione sterzo inferiore
Bottom head lug

CS60

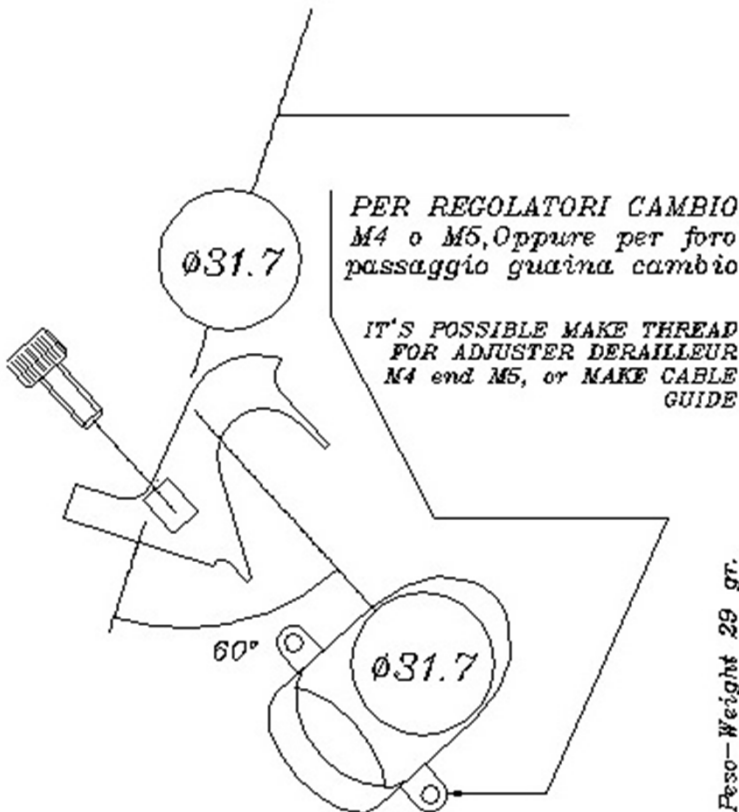

Peso-Weight 29 gr.

CONGIUNZIONE STERZO INFERIORE

BOTTOM HEAD LUG

$\varnothing 31,7 \times \varnothing 31,7 \times 60^\circ$

PESO/WEIGHT : 29 gr.

Cod. CS60



CS308

Congiunzione sterzo superiore
Top head lug

Peso-Weight 25 gr.

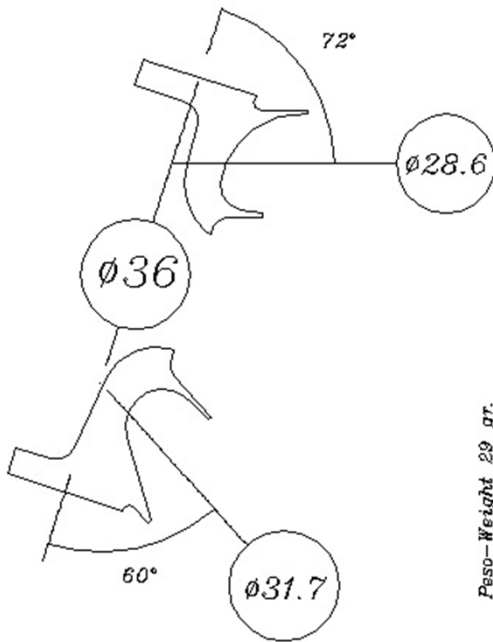

Peso-Weight 29 gr.

Congiunzione sterzo inferiore
Bottom head lug **CS208**

COMGIUNZIONE STERZO SUPERIORE
TOP HEAD LUG
Ø36xØ28,6x72°
PESO/WEIGHT : 25 gr.

Cod. CS308

COMGIUNZIONE STERZO INFERIORE
BOTTOM HEAD LUG
Ø36xØ31,7x60°
PESO/WEIGHT : 29 gr.

Cod. CS208

PER CANNOTTI 1"1/8
FOR STEAM 1"1/8

AS01

Anello rinforzo tubo sterzo
Reinforcement ring for head tube

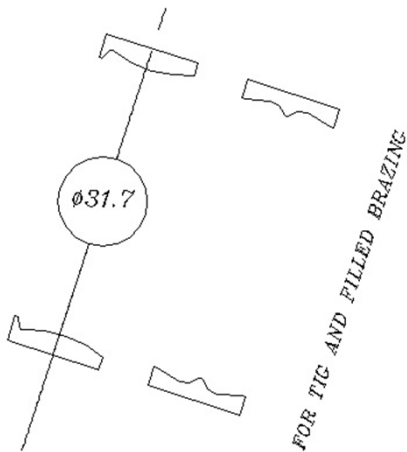

Peso-Weight 10 gr. Coppia-Set

ANELLO RINFORZO TUBO STERZO
REINFORCEMENT RING FOR HEAD TUBE Ø31,7
PESO/WEIGHT : 5 gr.

Cod. AS01



AS01

Anello rinforzo tubo sterzo
Reinforcement ring for head tube

ANELLO RINFORZO TUBO STERZO
REINFORCEMENT RING FOR HEAD TUBE Ø31,7
PESO/WEIGHT : 10 gr.

Cod. AS02

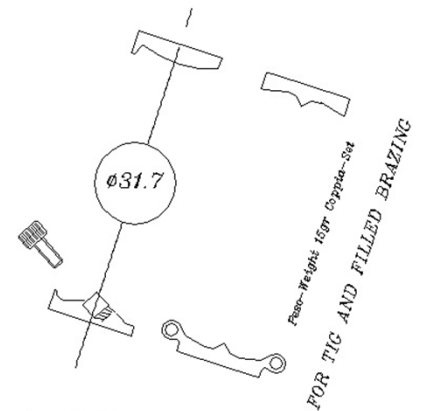

AS02
Anello rinf. tubo sterzo inf. per regolatori
Bottom reinforcement ring for head tube
for adjuster screw



CONGIUNZIONI MICROFUSE – CASTING LOST WAX

SET BERCEAU 4 pcs

Cod. SBM4

TOP $\varnothing 31,7 \times \varnothing 14 \times 2 \times 100^\circ$



SEAT LUG LADY $\varnothing 28,6$



BOTTOM $\varnothing 31,7 \varnothing 28,6 \times 59,5^\circ$



LOOP $\varnothing 28,6 \times \varnothing 14 \times 2$



**TOP $\varnothing 31,7 \times \varnothing 14 \times 2 \times 100^\circ$
PESO/WEIGHT : 29 gr.**



**SEAT LUG LADY $\varnothing 28,6$
PESO/WEIGHT : 53 gr.**



**BOTTOM $\varnothing 31,7 \varnothing 28,6 \times 59,5^\circ$
PESO/WEIGHT : 37 gr.**



**LOOP $\varnothing 28,6 \times \varnothing 14 \times 2$
PESO/WEIGHT : 31 gr.**





ATTACCO ERGO POWER
 ERGO POWER SUPPORT
 PESO/WEIGHT : 5 gr.
Cod. AP-180



ADJUSTER M5 W/SPRING SUPPLY SEPARATED

Cod. V.R
 REGOLATORE M5 SILVER
 PESO/WEIGHT : 2 gr.

Regolatore M5 con molla IX
Adjuster M5 with spring SS
 NORMAL TYPE ALLOY LOOKING



Cod. V.R.N
 REGOLATORE M5 LUX
 PESO/WEIGHT : 2 gr.

Regolatore M5 con molla IX
Adjuster M5 with spring SS
 LUX TYPE BLACK ANODIZ.+ RUBBER



**TUBO STERZO INTEGRATO 45°
INTEGRATED HEAD TUBE 45°**

**TOP 1"1/8 – BOTTOM 1"1/8
PESO/WEIGHT : 285 gr.**

Cod. TS45-S-200



CROMOLY INTEGRATED HEAD TUBE ø38x1 mm

**SET 3 pz – TUBO PRINCIPALE + ANELLO SUPERIORE+ INFERIORE SEDE
CUSCINETTO**

SET 3 pz – MAIN TUBE + TOP + BOTTOM RING BOSS BEARING

**A RICHIESTA SI FORNISCONO SERIE STERZO SPECIFICHE TIPO BAS 45
(Pag.25) CON TOP RING "ø44,5"**

**BY REQUEST WE SUPPLY HEAD SET LIKE BAS 45 (Pag. 25) WITH SPECIAL
TOP RING "ø44,5"**



TUBO STERZO INTEGRATO DIFFERENZIATO
INTEGRATED AND DIFFERENTIATED HEAD TUBE
TOP 1"1/8 – BOTTOM 1"1/2



Cod. TS45-SD-250

A = 250
 PESO/WEIGHT : 270 gr.

Cod. TS45-SD-200

A = 200
 PESO/WEIGHT : 230 gr.



SET 3 pz – TUBO PRINCIPALE + ANELLO SUPERIORE+ INFERIORE SEDE CUSCINETTO

SET 3 pz – MAIN TUBE + TOP + BOTTOM RING BOSS BEARING

In stock dim. Are 200 or 250 mm max that you cut like you want minimum 100 mm.

A RICHIESTA SI FORNISCONO SERIE STERZO SPECIFICHE TIPO BAS 45 (Pag.28) CON TOP RING "Ø44,5"

BY REQUEST WE SUPPLY HEAD SET LIKE BAS 45 (Pag. 28) WITH SPECIAL TOP RING "Ø44,5"



TUBO STERZO CROMOLY ϕ 46x1
CROMOLY HEAD TUBE ϕ 46x1



- 1) SET TUBO STERZO A COLONNA 1"1/8 + 1"1/8 + SERIE STERZO
 SET COLUMN HEAD TUBE TOP 1"1/8 BOTTOM 1"1/8 + HEAD SET - Cod.TS45-S-46-1
- 2) SET TUBO STERZO DIFFERENZIATO 1"1/8 + 1"1/2 + SERIE STERZO
 SET DIFFERENTIATED HEAD TUBE TOP 1"1/8 BOTTOM 1"1/2 + HEAD SET - Cod.TS45-S-46-2
- 3) SET TUBO STERZO A COLONNA 1"1/8 + 1"1/2 + SERIE STERZO
 SET COLUMN HEAD TUBE TOP 1"1/8 BOTTOM 1"1/2 + HEAD SET - Cod.TS45-S-46-3
- 4) SET TUBO STERZO DIFFERENZIATO 1"1/8 + 1"1/2 + SERIE STERZO
 SET DIFFERENTIATED HEAD TUBE TOP 1"1/8 BOTTOM 1"1/2 + HEAD SET - Cod.TS45-S-46-4
- 5) SET TUBO STERZO A COLONNA 1"1/8 + 1"1/8 + SERIE STERZO
 SET COLUMN HEAD TUBE TOP 1"1/8 BOTTOM 1"1/8 + HEAD SET - Cod.TS45-S-46-5

NORMALE FORNITURA 3 SET COMPLETI (CON UN TUBO STERZO L=600mm)
 NORMAL SUPPLY 3 COMPLETE SET (WITH ONE HEAD TUBE L = 600 mm)



SET COLUMN HEAD TUBE TOP 1"1/8 BOTTOM 1"1/8 + INTEGRATED HEAD SET



SET DIFFERENTIATED HEAD TUBE TOP 1"1/8 BOTTOM 1"1/2 + INTEGRATED HEAD SET



**SET COLUMN HEAD TUBE TOP 1"1/8
BOTTOM 1"1/2 + PRESS HEAD SET**



**HEAD SET FIXED BY PRESS
TOP "ø48 x 15 + 10" mm BOTTOM "ø58 x 12" mm**

**SET DIFFERENTIATED HEAD TUBE
TOP 1"1/8 - BOTTOM 1"1/2 + HEAD SET
TOP PRESS - BOTTOM INTEGRATED**



**HEAD SET TOP FIXED BY PRESS -
BOTTOM INTEGRATED
TOP "ø48 x 15 + 10" mm - BEARING 45°**

**SET COLUMN HEAD TUBE TOP 1"1/8 BOTTOM 1"1/8 +
SEMI INTEGRATED HEAD SET**

HEAD TUBE CROMOLY ø46x1 mm THAT YOU CUT LIKE YOU WANT

TOP 1"1/8 **BOTTOM 1"1/8**

Cod. TS45-S-46-5

ALLOY RINGS BOSS OF BEARING FIXED BY PRESS

**SEMI INTEGRATED HEAD SET - BEARING 45°
TOP "ø46 x 15+2" mm - BOTTOM "ø46+2" mm**



CONGIUNZIONI SELLA

SEAT LUG

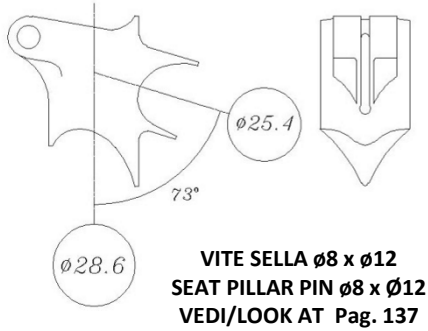

CONGIUNZIONE SELLA
SEAT LUG
PESO/WEIGHT : 50 gr.

Cod. P150

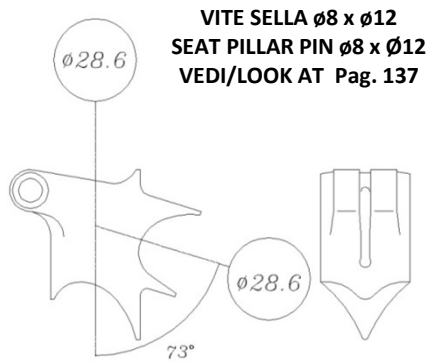

CONGIUNZIONE SELLA
SEAT LUG
PESO/WEIGHT : 55 gr.

Cod. P51

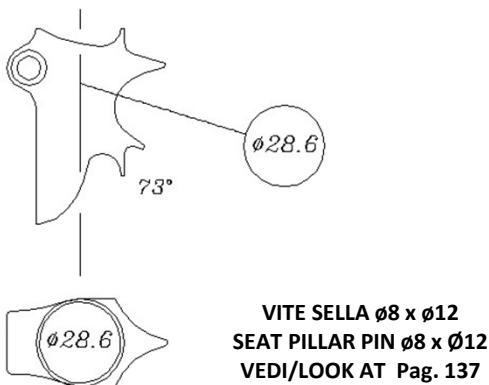

CONGIUNZIONE SELLA
SEAT LUG
PESO/WEIGHT : 52 gr.

Cod. P28



" FILLED BRAZING FINISH "

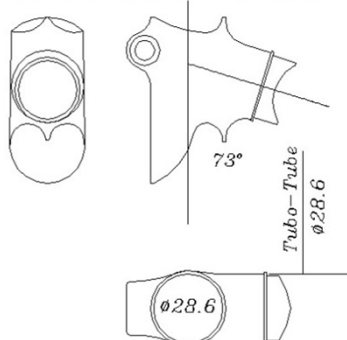

VITE SELLA $\phi 8 \times \phi 12$
SEAT PILLAR PIN $\phi 8 \times \phi 12$
VEDI/LOOK AT Pag. 137

CONGIUNZIONE SELLA
SEAT LUG
PESO/WEIGHT : 82 gr.

Cod. P20



CONGIUNZIONE SELLA
SEAT LUG
PESO/WEIGHT : 56 gr.

Cod. P88

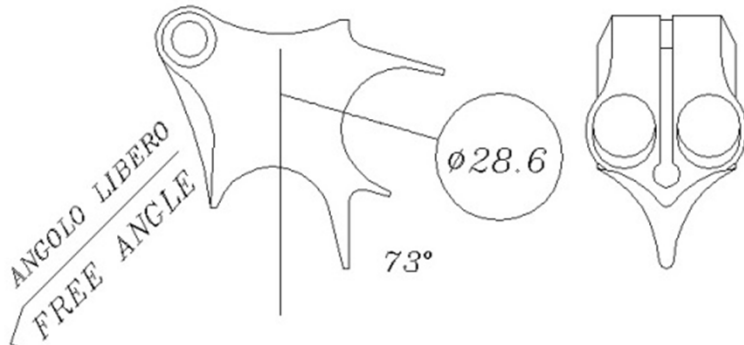

P88 accetta tutti i normali angoli fra il tubo sella e il posteriore verticale tipo conico ø14
P88 accepts all the normal angles between the seat tube and the seat stay type taper ø14

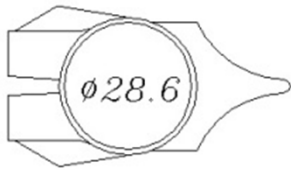

VITE SELLA ø8 x ø12
SEAT PILLAR PIN ø8 x ø12
VEDI/LOOK AT Pag. 137



VITE SELLA ø8 x ø12
SEAT PILLAR PIN ø8 x ø12
VEDI/LOOK AT Pag. 137

TUBO SELLA
SEAT TUBE

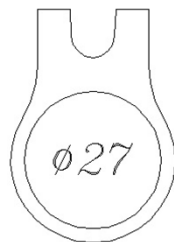

COLLARINO SELLA
SEAT CLAMP
PESO/WEIGHT : 28 gr.

Cod. BS29N

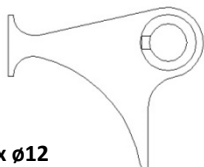

VITE SELLA ø8 x ø12
SEAT PILLAR PIN ø8 x ø12
VEDI/LOOK AT Pag. 137

TUBO SELLA
SEAT TUBE



COLLARINO SELLA
SEAT CLAMP
PESO/WEIGHT : 28 gr.

Cod. BS77



VITE SELLA $\phi 8 \times \phi 12$
SEAT PILLAR PIN $\phi 8 \times \phi 12$
VEDI/LOOK AT Pag. 137

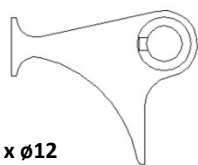

TUBO SELLA

SEAT TUBE



COLLARINO SELLA
SEAT CLAMP
PESO/WEIGHT : 30 gr.

Cod. BS83



TUBO SELLA

SEAT TUBE

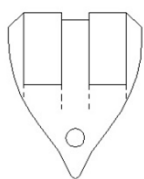

VITE SELLA $\phi 8 \times \phi 12$
SEAT PILLAR PIN $\phi 8 \times \phi 12$
VEDI/LOOK AT Pag. 137



BLOCCAGGIO SELLA
SEAT CLAMP
PESO/WEIGHT : 18 gr.

Cod. BS87



VITE SELLA 3/1 $\phi 12/\phi 8$
SEAT SCREW $\phi 12/\phi 8$

INOX

PESO/WEIGHT : 9 gr.

Cod. IX-VS3



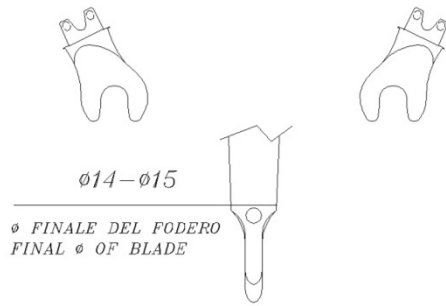

**FORCELLINO ANTERIORE CORSA
RACING FRONT DROP OUT
PESO/WEIGHT : 44 gr. SET**

Cod. FA10

FA10 da i seguenti vantaggi:

- sullo stesso forcellino e'possibile inserire foderi con Ø finale da Ø14 a Ø15 con ottima finitura e poca manodopera.
- si usa per forcelle curve e diritte
- facilita la saldatura
- ottimo drenaggio del fodero
- facilita l'inserimento della ruota

FA10 offers the following advantages:

- it can be inserted in the blades
- with final Ø from Ø14 to Ø15 with the best finish and short labor
- it can be used for bending and straight forks
- helps the welding
- optimal drainage of the blade
- easy insertion of the wheel

**BREVETTATO
PATENTED**



**FORCELLINO ANTERIORE
FORK END
PESO/WEIGHT : 26 gr. SET**

Cod. FA-S



**FORCELLINO ANTERIORE 2 OCCHIELLI
FORK END 2 EYELET
PESO/WEIGHT : 35 gr. SET**

Cod. FA-S-2OCCH





FORCELLINI POSTERIORI SEMIVERTICALI 2 OCCHIELLI
 DROP OUT – HALF VERTICAL PRESS 2 EYELET
 PESO/WEIGHT : 139 gr. SET

Cod. FP-SV-2OCCH



FORCELLINI POSTERIORI ORIZZONTALI
 DROP OUT - HORIZONTAL
 PESO/WEIGHT : 134 gr. SET

Cod. FP-ORIZZ



FORCELLINI POSTERIORI CORSA 2 OCCHIELLI
 RACING REAR DROP OUT 2 EYELET
 PESO/WEIGHT : 115 gr. SET

Cod. FP11-2OCCH



FORCELLINI POSTERIORI CORSA
 RACING REAR DROPOUT
 PESO/WEIGHT : 85 gr. SET

Cod. FP11

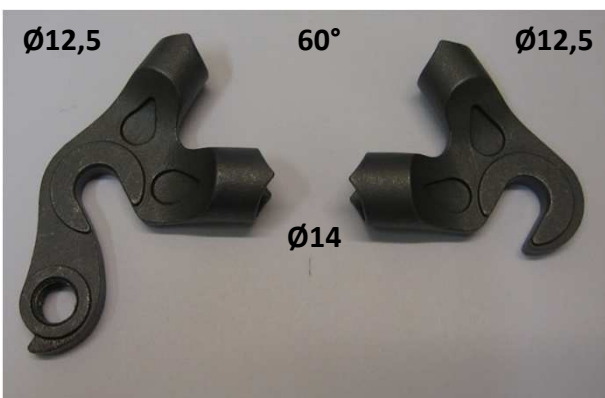

FORCELLINI POSTERIORI CORSA
 RACING REAR DROPOUT
 MTB 60°
 PESO/WEIGHT : 85 gr. SET

Cod. FP11-MTB



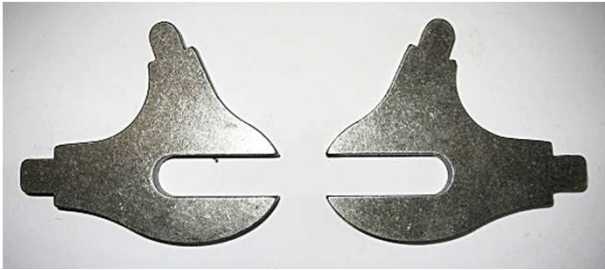

FORCELLINO POSTERIORE PISTA ACCIAIO
STEEL REAR DROPOUT INDOOR
PESO/WEIGHT : 146 gr. SET

Cod. FP-ACC



FORCELLINO POSTERIORE PISTA ACCIAIO
+ INSERTI INOX
STEEL REAR DROPOUT INDOOR
+ INOX INSERT
PESO/WEIGHT : 176 gr. SET

Cod. FP-ACC-IX



FORCELLINO POSTERIORE ACCIAIO + ATTACCO DISK
STEEL REAR DROPOUT + DISK BRAKE BOSS
PESO/WEIGHT : 152 gr. SET

Cod. W37-DISK



FORCELLINO POSTERIORE ACCIAIO
STEEL REAR DROPOUT
PESO/WEIGHT : 115 gr. SET

Cod. W37

FORCELLINI SCORREVOLI CON ATTACCO DISCO ADATTI PER :
- CATENA o CINGHIA DENTATA
-CAMBI NEL MOZZO TIPO ROHLOFF-SHIMANO

SLIDING DROPOUTS WITH DISK BOSS RIGHT FOR :
-CHAIN or TOOTHED BELT
-CHANGE GEAR IN HUB LIKE ROHLOFF-SHIMANO

VEDI PAG. - LOOK AT PAG. : Pag. 77 – Pag. 108

TUTTO/ALL INOX

RANGE 16 mm

PESO/WEIGHT : 369 gr. SET

Cod. IXFOR-SCR-DK-N



INOX



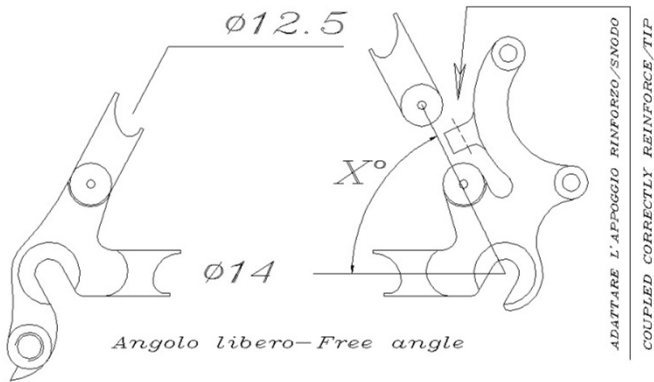

FORCELLINO POSTERIORE DISK ACCIAIO – ANGOLO LIBERO

STEEL REAR DROPOUT DISK – FREE ANGLE
PESO/WEIGHT : 170 gr.

Cod. FP-27

FORCELLINO POSTERIORE DISK ACCIAIO – ANGOLO LIBERO

PER ASSE PASSANTE TX 12x1,5 – MOZZO 142

STEEL REAR DROPOUT DISK – FREE ANGLE

FOR THROUGH AXLE TX 12x1,5 – HUB 142



Come optional forniamo l'asse passante TX 12 x1.5 con la leva di serraggio regolabile di posizione Pag.145
 Come optional forniamo l'inserito in carbonio per la parte sinistra o/e altre soluzioni per la personalizzare l'articolo.

Optional we supply through axle TX 12 x 1.5 with lever that can be adjusted from rotational position Pag.145
 Optional we supply carbon insert for left side or/and other custom solution





THECNO 2016
PRESENTA - INTRODUCES

**Nuovo forcellino posteriore
per freni a disco**
New dropout for disk brake

“FLAT MOUNT SYSTEM”

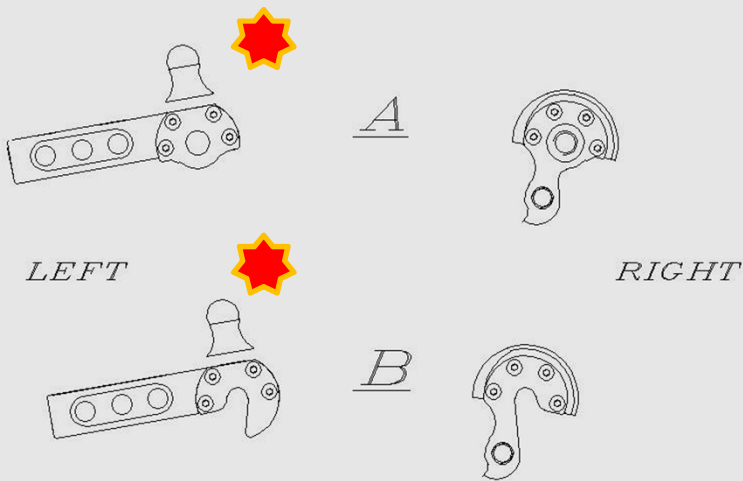
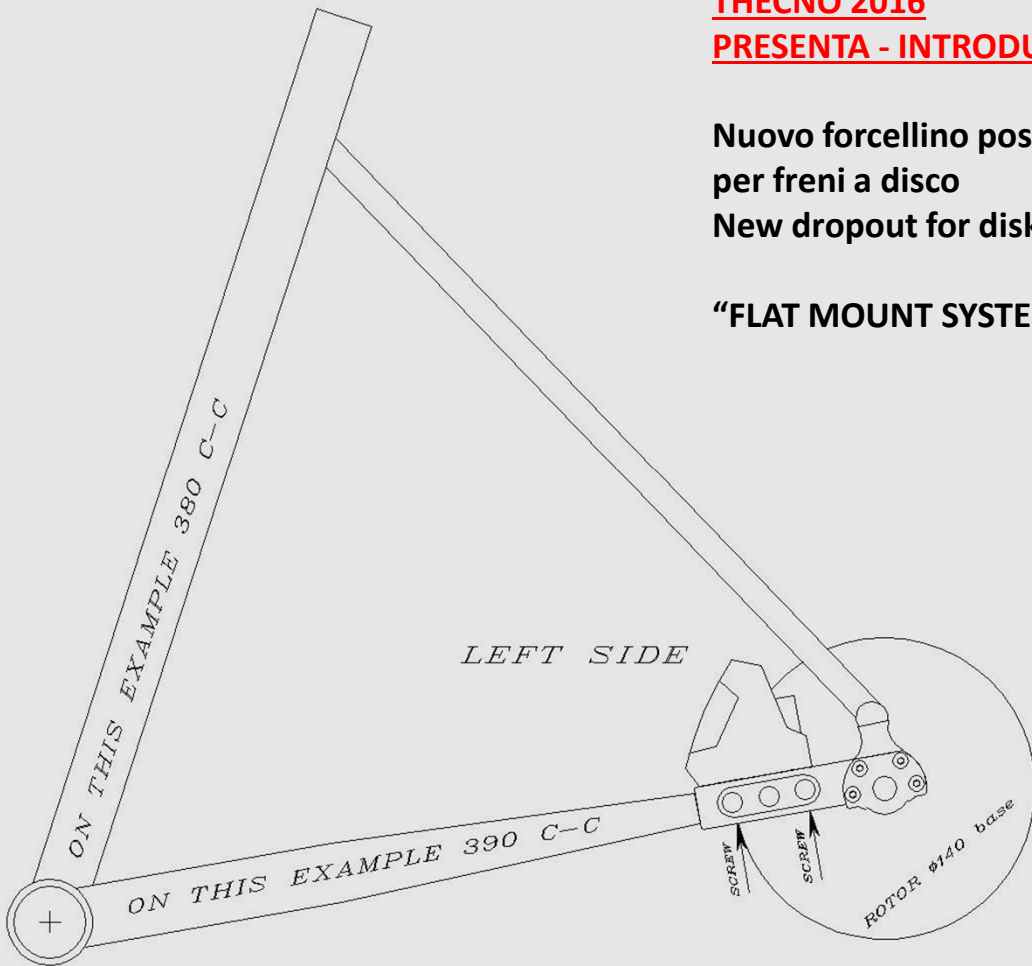

THECNO ITALY presenta: Cod. : FP-FM01

Un nuovo forcellino posteriore (tutto progettato e realizzato da noi in Italia) per telaio in acciaio con freni a disco "FLAT MOUNT SYSTEM" che usano le pinze freno, tipo Shimano PR-RS805, fissate all'interno del triangolo posteriore del telaio.

In questo caso specifico la pinza e' fissata direttamente sul forcellino sinistro rendendo semplicissimo e sicuro il posizionamento reciproco fra pinza e disco.

Altra caratteristica importante di questi forcellini e' che possono essere utilizzati con:

- **A - l' asse passante TX 12x 1.5 – mozzo 142 – peso 205 gr. Set**
- **B - il normale sistema QR cava 10mm – mozzo 135mm – peso 190 gr. set**

semplicemente sostituendo la coppia di inserti avvitati destro e sinistro, **rimanendo comunque invariata la posizione reciproca fra pinza e disco freno.**

- Noi forniamo il comprensivo dei due corpi in acciaio DEX e SIN + la coppia di inserti in alloy da avvitare del tipo A e del tipo B.
- Come optional forniamo l'asse passante TX 12 x1.5 con la leva di serraggio regolabile di posizione.
- Come optional forniamo l'inserto in carbonio per la parte sinistra o/e altre soluzioni per la personalizzare l'articolo.
- A richiesta è possibile realizzare le parti principali in INOX.



La forma di questa parte è sicuramente funzionale , ma per eventuali esigenze estetiche può essere modificati dal telaista compatibilmente con le dimensioni del telaio.

THECNO ITALY introduces: Cod. : FP-FM01

A new dropout (engineering and making all in Italy) for steel frame for disk brake "FLAT MOUNT SYSTEM" that use caliper, like Shimano PR-RS805, fixed up chainstay.

In this case the caliper is fixed up left dropout directly so rotor position compare caliper is right and easy.

An other important thing it is possible to use:

- **A - the through axle TX 12 x 1.5 – hub 142 -weight 205 gr. set**
- **B - normal QR axle slot 10mm – hub 135mm – weight 190 gr. set**

changing only the pairs of insert (L+R) to screw ; **in any case rotor position compare caliper it is the same.**

- We supply all set,main part in steel+pairs alloy inserts type A LEFT and RIGHT + pairs insert type B
- Optional we supply through axle TX 12 x 1.5 with lever that can be adjusted from rotational position
- Optional we supply carbon insert for left side or/and other custom solution
- By request it's possible STAINLESS STEEL main part



The shape of this part is right but if you like other aesthetics the frame builder can modify if the size of frame is enough







Leva di serraggio regolabile di posizione

Lever that can be adjusted from rotational position

ALLOY ANODIZED - PESO/WEIGHT : 93 gr.

Cod. : TX-12x1,5x171



GUIDAFILO PER SCATOLA MOVIMENTO
CABLE GUIDE FOR B.B.SHELL

STAINLESS STEEL – ACCIAIO INOX
FISSATO CON VITE M5 O SALDABILE
FIXED BY M5 SCREW OR BRAZING
SCORRIMENTO OTTIMALE DEL FILO
THE BEST SLIDING OF WIRE
PESO/WEIGHT : 10 gr.

Cod. GFX



PONTICELLO FRENO
BRAKE BRIDGE
PESO/WEIGHT : 28 gr.

Cod. PF04



PONTICELLO FRENO "BICONICO"
BRAKE BRIDGE "BICONIC"
PESO/WEIGHT : 30 gr.

Cod. PFB-ACC



ATTACCO DERAGLIATORE
BOSS DERAILLEUR
PESO/WEIGHT : 13 gr.

Cod. A030

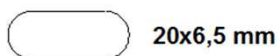

PONTICELLO FRENO CROSS/MTB
BRAKE BRIDGE CROSS/MTB
PESO/WEIGHT : 16 gr.

Cod. PF-MTB-ACC



PONTICELLO RINFORZO
REINFORCE BRIDGE
PESO/WEIGHT : 30 gr.

Cod. PR-ACC



PERNO FRENO ANTERIORE
FRONT CANTILEVER PIVOT
PESO/WEIGHT : 17 gr.

Cod. SA04



PERNO FRENO POSTERIORE
REAR CANTILEVER PIVOT
PESO/WEIGHT : 17 gr.

Cod. SA07



PERNO FRENO POSTERIORE
REAR CANTILEVER PIVOT
SET 2pz = BASE + PIVOT
PESO/WEIGHT : 20 gr.

Cod. PIV-SP

**A RICHIESTA
BY REQUEST**





FERMA GUAINA X 1
CABLE STOPPER X 1
ACCIAIO - STEEL
PESO/WEIGHT : 3 gr.

Cod. C33-1



FERMA GUAINA LUX X 1
CABLE STOPPER LUX X 1
ACCIAIO - STEEL
PESO/WEIGHT : 2 gr.

Cod. C33-1-LUX



FERMA GUAINA X 2
CABLE STOPPER X 12
ACCIAIO - STEEL
PESO/WEIGHT : 5 gr.

Cod. C33-2



FERMA GUAINA X 3
CABLE STOPPER X 13
ACCIAIO - STEEL
PESO/WEIGHT : 7 gr.

Cod. C33-3



RINFORZO PONTICELLO FRENO
REAR BRAKE BRIDGE REINFORCE
ACCIAIO - STEEL
PESO/WEIGHT : 10 gr.

Cod. RINP-ACC



ATTACCO QUADRO LEVE
SHIFTER LEVER BOSS
ACCIAIO - STEEL
PESO/WEIGHT : 5 gr.

Cod. ATL-ACC



RINFORZO PASSAGGIO INTERNO Ø7
REINFORCE FOR INNERCABL R Ø7
SI FORNISCE TUBO 6x7 (Pag.147)
SUPPLY TUBE 6x7 TOO (Pag. 147)
ACCIAIO - STEEL
PESO/WEIGHT : 1 gr.

Cod. RIN-7-ACC



BUSSOLA BORRACCIA
BOTTLe GAGE BOSS
ACCIAIO - STEEL
PESO/WEIGHT : 1 gr.

Cod. BB-ACC



RINFORZO BUSSOLA BORRACCIA
REINFORCE BOTTLe GAGE BOSS
ACCIAIO - STEEL
PESO/WEIGHT : 0,5 gr.

Cod. RINB-ACC



FERMACAVO APERTO
OPEN CABLE GUIDE
ACCIAIO - STEEL
PESO/WEIGHT : 6 gr.

Cod. 1F-DK-S-ACC



GUIDA FILO SOTTO SELLA
CABLE GUIDE UNDER SADDLE
ACCIAIO - STEEL
PESO/WEIGHT : 5 gr.

Cod. GF-SS-ACC



NEXUS CABLE GUIDE
ACCIAIO - STEEL
PESO/WEIGHT : 2,5 gr.

Cod. NEXUS





NOTTOLINO CATENA
CHAIN - HANGER
ACCIAIO - STEEL
PESO/WEIGHT : 1 gr.

Cod. NOTT-CAT



NOTTOLINO PORTA PACCHI M5
LUGGAGE CARRIER BOSS M5
ACCIAIO - STEEL
PESO/WEIGHT : 6 gr.

Cod. NOTT-PACC



NOTTOLINO SFERICO CAMBIO $\phi 4,2$
CABLE STOPPER – REAR DERAILLEUR $\phi 4,2$
ACCIAIO - STEEL
PESO/WEIGHT : 1 gr.

Cod. NOTT-SF



PENDINA $\phi 14$
SEAT STAY END $\phi 14$
ACCIAIO - STEEL
PESO/WEIGHT : 38 gr.

Cod. PE-ACC



VITE FRENO - BRIDGE SCREW - INOX
 $\phi 12/\phi 8 \times 30$ - 7 gr.

Cod. IX-VF-30

$\phi 12/\phi 8 \times 40$ - 12 gr.

Cod. IX-VF-40



VITE SELLA 3/1 $\phi 12/\phi 8$
SEAT SCREW $\phi 12/\phi 8$
INOX
PESO/WEIGHT : 9 gr.

Cod. IX-VS3

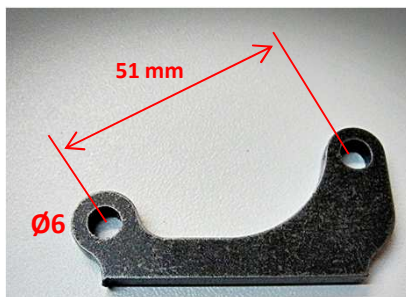

ATTACCO DISCO
DISK BRAKE BOSS
ACCIAIO - STEEL
PESO/WEIGHT : 32 gr.

Cod. P-DK1-ACC



REGOLATORI M3x20
ADJUSTER M3x20
INOX
PESO/WEIGHT : 1 gr.

Cod. IX-REG-F



TUBO PER GUAINA IN OTTONE
BRASS TUBE FOR CABLE GUIDE
OTTONE - BRASS
 $\phi 6 \times 7 \times 500$ mm
PESO/WEIGHT : 45 gr.

Cod. TG-T

RINFORZO ELT – REINFORCE ELT

RINFORZO INOX PER SEDE OVALE FERMA GUAINA MULTIFUNZIONE
Cod. FE-ML-A (Pag. 43).
PER TELAI ACCIAIO INOX O CROMOLY

STAINLESS STEEL REINFORCE FOR OVAL SLOT OF MULTIFUNCTION
CABLE STOPPER Cod. FE-ML-A (Pag. 43) .
FOR STEEL OR CROMOLY FRAME
Peso/Weight : 1,5 gr.

Cod. IXRIN-ELT



RINFORZO INOX
REINFORCE INOX

BASE
PART
ALLOY



CONGIUNZIONI PER TELAI IN LAMIERA STAMPATA

PRESS STEEL LUGS



TOP LUG MAN

Ø31,8XØ25,4X72° - 35 gr.

Cod. PRESS-TLM-161

Ø31,8XØ28,6X72° - 40 gr.

Cod. PRESS-TLM-461



BOTTOM LUG MAN

Ø31,8XØ28,6X61° - 44 gr.

Cod. PRESS-BLM-162

Ø31,8XØ31,8X61° - 48 gr.

Cod. PRESS-BLM-462



3-1 HEAD LUG MAN

TOP LUG Ø31,8XØ25,4X72°

BOTTOM LUG Ø31,8XØ28,6X61°

LUNGHEZZA/LENGTH 127mm

PESO/WEIGHT : 185 gr.

OTHER DIM. BY REQUEST

Cod. PRESS-3-1-M



SEAT LUG MAN

Ø25,4xØ28,6x61°

PESO/WEIGHT : 59 gr.

W/REINFORCE

Cod. PRESS-SLM



3-1 HEAD LUG LADY

TOP LUG Ø31,8XØ25,4X50°

BOTTOM LUG Ø31,8XØ28,6X62°

LUNGHEZZA/LENGTH 170mm

PESO/WEIGHT : 235 gr.

OTHER DIM. BY REQUEST

Cod. PRESS-3-1-L



SEAT LUG LADY

Ø28,6X0°

PESO/WEIGHT : 52 gr.

W/REINFORCE

Cod. PRESS-SLL



LOOP LUG BERCEAU

Ø28,6X0°

PESO/WEIGHT : 37 gr.

W/REINFORCE

Cod.



TOP LUG BERCEAU

Ø31,7xØ13x100°

PESO/WEIGHT : 36 gr.

Cod.

ALTRI ARTICOLI A RICHIESTA

OTHER ITEMS BY REQUEST





BB BSA STEEL 28,6X28,6X20
61°X63°X6° 30'
PESO/WEIGHT : 200 gr.

Cod. PRESS-BB-BSA-20

BB BSA STEEL 28,6X28,6X22,2
61°X63°X6° 30'
PESO/WEIGHT : 200 gr.

Cod. PRESS-BB-BSA-222

BB BSA STEEL 31,7X28,6X22,2
PESO/WEIGHT : 200 gr.

Cod. PRESS-BB-BSA-317

BB ITA STEEL 31,7X28,6X22,2
PESO/WEIGHT : 200 gr.

Cod. PRESS-BB-ITA-317



SCATOLA MOVIMENTO
B.B.SHELL

BB TIPE 911 Ø22,2 ITA
Peso/weight : 150 gr.

Cod. PRESS-BB-ITA-911





MINUTERIA PER TELAI INOX

**SMALL PARTS FOR STAINLESS
STEEL FRAME**